

SURVEY & REMONUMENTATION

MAR 03 1998

SECTION

LAND CORNER RECORDATION CERTIFICATE
Filing Requirement of Act 74, Mich. P.A. 1970
KENT COUNTY REMONUMENTATION

For corners in

Kent (County)	Located in: Ada Township	Corner Code #
1. Public Land Survey	T <u>7N</u> R <u>10W</u>	<u>I-5</u>
	T _____ R _____	_____
	T _____ R _____	_____
	T _____ R _____	_____
2. Property Controlling in Section	S _____ T _____ R _____	_____
	S _____ T _____ R _____	_____
3. Miscellaneous Property in Sec.	S _____ T _____ R _____	_____
	S _____ T _____ R _____	_____

STATE OF MICHIGAN
 COUNTY OF KENT
 RECEIVED FOR RECORD
 97 OCT 15 AM 8:51
 REG. OF DEEDS
Luci Bond

10216

Register of Deeds Stamp & File Number

4. Lot No. _____, Recorded Plat _____
 5. Private Claims _____

I, Randy Kolehouse, in a field survey on May 29 19 97, do hereby certify that under requirements of P.A. 74 Michigan P.A. of 1970, the corner points mentioned in lines 1 and 2 above were in conformance with regulations and rules therefore as required in the current manual of survey instructions of the United States Department of the Interior, Bureau of Land Management or by a decree of a Court of Law and/or that the corner points mentioned in lines 3, 4 and 5 above were in conformance with the rules of the Michigan Board of Land Surveyors or by a Decree of a Court of Law; established, re-established, monumented, re-monumented, recovered, found as expressed below:

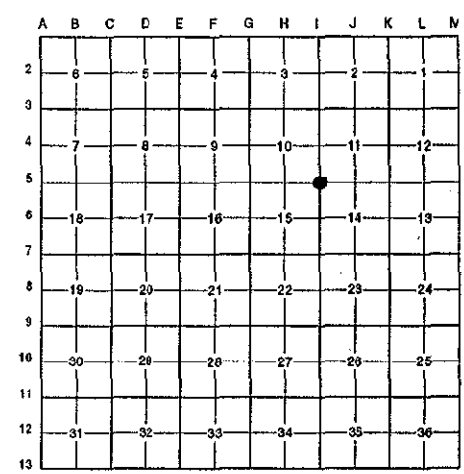

NOTE: Not more than 4 corners, all in the same town and range, may be recorded on this certificate.

A. Description of original monument and accessories and/or subsequent restoration:

I-5	1831	G.L.O. Notes	Mullett	Set Post	P.A. 345 1990 KENT COUNTY
	1930-61	Witness Map	K.C. Surveyor	Stone	PEER APPROVED <u>5/26/97</u>
	1978	L.C.R.C. #1156	Glaza & Associates	1/2" Iron Rod	CHAIRMAN <u>Randy Kolehouse</u>
	1979	L.C.R.C. #1393	Moore & Bruggink	Stone	
	1982	L.C.R.C. #3074	Jonker Land Survey	Fnd. Pointed Stone / Set K.C. Monument	
	1994	L.C.R.C. #8070	Glaza & Associates	K.C. Monument	

This corner was originally approved by the Kent County Remonumentation Peer Group and monumented by Rob Jonker on 8/3/82 and was recorded per L.C.R.C. #3074.

B. Description of corner evidence found and/or method applied in restoring or reestablishing corner:

I-5 Found a Standard Kent County Monument 250' ± East of Honey Creek Avenue (bit.) running North and South and 100' ± North of the C/L of 2 Mile Road (gravel) running East and on line m/l with tree row running North and West per L.C.R.C.'s #3074 and #8070 as set by Rob Jonker in place of a 10"x10"x18" pointed stone he found which checked L.C.R.C.'s #1393, #1156 and the K.C. Surveyor's records.

L.C.R.C. #3074

L.C.R.C. #8070

Remon. tag on W side 12" Tw. W. Cherry N 10° W 15.53'	K.C. remon tag & nail in W side 12" Tw W Cherry N 10° W 15.47' (m. 15.53')
Remon. tag on NW side 9" Oak N 60° E 30.39'	K.C. remon tag & nail in NW side 14" Oak N 60° E 30.28' (m. 30.39')
Remon. tag on SE side 12" Maple S 40° W 18.34'	K.C. remon tag & nail in SE side 14" Maple S 40° W 18.26' (m. 18.34')
	K.C. remon tag & nail in N side 8" Maple S 90° E 8.48'

The selected location is accepted by me and is generally accepted by professional surveyors as the best available evidence of the position of the original corner.

C. Description of monument for corner and accessories established to perpetuate locating the position of the corner:

- I-5 Standard Kent County Monument
- Nail & K.C. remon. tag on W side 12" Twin Cherry N 10° W 15.53'
 - Nail & K.C. remon. tag on NW side 10" Oak N 60° E 30.39'
 - Nail & K.C. remon. tag on SE side 17" Maple S 40° W 18.34'
 - Nail & K.C. remon. tag on S side 16" Oak N 85° W 25.10'

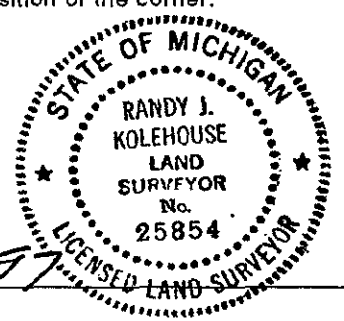

Signed by Randy J. Kolehouse Date 8-1-97
 EARTH TECH

Surveyor's Michigan License No. 25854