

SURVEY & REMONUMENTATION

MAR 03 1998

\$7.00
\$2.00

SECTION

LAND CORNER RECORDATION CERTIFICATE
Filing Requirement of Act 74, Mich. P.A. 1970
KENT COUNTY REMONUMENTATION

STATE OF MICHIGAN
COUNTY OF KENT
RECEIVED FOR RECORD
97 NOV 14 AM 9:00
REG. OF DEEDS
Luci Standa

For corners in

Kent (County)	Located In:	Ada Township	Corner Code #
1. Public Land Survey	T <u>7N</u>	R <u>10W</u>	<u>M-1</u>
	T _____	R _____	_____
	T _____	R _____	_____
	T _____	R _____	_____
2. Property Controlling in Section	S _____	T _____	R _____
	S _____	T _____	R _____
3. Miscellaneous Property in Sec.	S _____	T _____	R _____
	S _____	T _____	R _____

10307

Register of Deeds Stamp & File Number

4. Lot No. _____, Recorded Plat _____
5. Private Claims _____

I, Randy Kolehouse, in a field survey on July 10 19 97, do hereby certify that under requirements of P.A. 74 Michigan P.A. of 1970, the corner points mentioned in lines 1 and 2 above were in conformance with regulations and rules therefore as required in the current manual of survey instructions of the United States Department of the interior, Bureau of Land Management or by a decree of a Court of Law and/or that the corner points mentioned in lines 3, 4 and 5 above were in conformance with the rules of the Michigan Board of Land Surveyors or by a Decree of a Court of Law; established, re-established, monumented, re-monumented, recovered, found as expressed below:

A	B	C	D	E	F	G	H	I	J	K	L	M
2	6	5	4	3	2	1						
3												
4	7	8	9	10	11	12						
5												
6	18	17	16	15	14	13						
7												
8	18	20	21	22	23	24						
9												
10	30	29	28	27	26	25						
11												
12	31	32	33	34	35	36						
13												

NOTE: Not more than 4 corners, all in the same town and range, may be recorded on this certificate.

A. Description of original monument and accessories and/or subsequent restoration:

M-1	1831	G.L.O. Notes	Mullett	Set Post
	N/A	Witness Map	K.C. Surveyor	Iron
	1984	L.C.R.C. #3963	Exxel Engineering	Fnd. 3/4" Iron / Set K.C. Monument (M-13, T8N, R10W)
	1989	L.C.R.C. #5298	J. Bueche	K.C. Monument

Note: This corner is common with M-13, T8N, R10W; A-13, T8N, R9W; and A-1, T7N, R9W.

This corner was originally approved by the Kent County Remonumentation Peer Group and monumented by Exxel Engineering on 9/14/84 and was recorded per L.C.R.C. #3963.

B. Description of corner evidence found and/or method applied in restoring or reestablishing corner:

M-1 Found a Standard Kent County Monument 28' ± Northeast of the C/L (on the curve) of 4 Mile Road (gravel) running West and South on line of a tree row running East and West per L.C.R.C.'s #3963 and #5298 as set by Exxel Engineering in place of a 3/4" iron they found which checked the K.C. Surveyor's records.

L.C.R.C. #3963

L.C.R.C. #5298

Nail & remon tag in N sde 16" Oak N 75° W 105.31'
Nail & remon tag in S sde 7" W. Cherry N 45° E 1.66'
Nail & remon tag in SW sde 4" Oak N 10° W 6.90'

Nail & remon. tag in N side 18" Oak N 75° W 105.31'
Nail & remon. tag in S side 9" W. Cherry N 45° E 1.60' (m. 1.63')
Nail & remon. tag in SW side 6" Oak N 10° W 6.95' (m. 6.94')

The selected location is accepted by me and is generally accepted by professional surveyors as the best available evidence of the position of the original corner.

C. Description of monument for corner and accessories established to perpetuate locating the position of the corner:

M-1 Standard Kent County Monument

Nail & K.C. remon. tag on N side 16" Oak N 75° W 105.31'
Nail & K.C. remon. tag on S side 7" W. Cherry N 45° E 1.63'
Nail & K.C. remon. tag on SW side 4" Oak N 10° W 6.94'
NE cor. barn fndn. S 60° W 105.88'
NW cor. barn fndn. S 65° W 138.34'

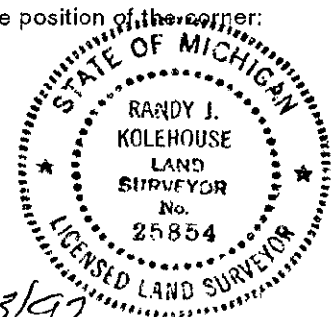

Signed by Randy J. Kolehouse Date 9/23/97
EARTH TECH

Surveyor's Michigan License No. 25854