

SURVEY & REMONUMENTATION

MAR 03 1998

LAND CORNER RECORDATION CERTIFICATE Filing Requirement of Act 74, Mich. P.A. 1970 KENT COUNTY REMONUMENTATION

For corners in

SECTION

<u>Kent</u>	Located in:	Ada	Corner Code #
(County)		Township	
1. Public Land Survey	T <u>7N</u>	R <u>10W</u>	<u>M-2</u>
	T _____	R _____	_____
	T _____	R _____	_____
	T _____	R _____	_____
2. Property Controlling in Section	S _____	T _____	R _____
	S _____	T _____	R _____
3. Miscellaneous Property in Sec.	S _____	T _____	R _____
	S _____	T _____	R _____
4. Lot No. _____, Recorded Plat _____			
5. Private Claims _____			

STATE OF MICHIGAN
 COUNTY OF KENT
 RECEIVED FOR RECORD
 97 OCT 15 AM 8:52
 REG. OF DEEDS
David Standa
10245
 Register of Deeds Stamp & File Number

I, Randy Kolehouse, in a field survey on June 5 19 97, do hereby certify that under requirements of P.A. 74 Michigan P.A. of 1970, the corner points mentioned in lines 1 and 2 above were in conformance with regulations and rules therefore as required in the current manual of survey instructions of the United States Department of the Interior, Bureau of Land Management or by a decree of a Court of Law and/or that the corner points mentioned in lines 3, 4 and 5 above were in conformance with the rules of the Michigan Board of Land Surveyors or by a Decree of a Court of Law; established, re-established, monumented, re-monumented, recovered, found as expressed below:

A	B	C	D	E	F	G	H	I	J	K	L	V
2	6	5	4	3	2	1						
3												
4	7	8	9	10	11	12						
5												
6	18	17	16	15	14	13						
7												
8	19	20	21	22	23	24						
9												
10	30	29	28	27	26	25						
11												
12	31	32	33	34	35	36						
13												

NOTE: Not more than 4 corners, all in the same town and range, may be recorded on this certificate.

A. Description of original monument and accessories and/or subsequent restoration:

M-2	1831	G.L.O. Notes	Mullett	Set Post
	1980	L.C.R.C. #1370	Medema, Van Kooten & Assoc.	"T" Iron (A-2, T7N, R9W)
	1982	L.C.R.C. #3161	Williams & Works	Fnd. "T" Iron / Set K.C. Monument (A-2, T7N, R9W)
	1991	L.C.R.C. #5818	Exxel Engineering	K.C. Monument (A-2, T7N, R9W)
	1994	L.C.R.C. #8047	Glaza & Associates	K.C. Monument (A-2, T7N, R9W)

P.A. 345 1990 KENT COUNTY
 PEER APPROVED 6/26/97
 CHAIRMAN *Harry Huber*

Note: This corner is common with A-2, T7N, R9W.

This corner was originally approved by the Kent County Remonumentation Peer Group and monumented by Williams & Works on 11/22/82 and was recorded per L.C.R.C. #3161.

B. Description of corner evidence found and/or method applied in restoring or reestablishing corner:

M-2 Found a broken Standard Kent County Monument 5' ± West of the C/L of Boynton Avenue (gravel) running North and South and 3' North of a fence line and tree row running East per L.C.R.C.'s #3161, #5818, and #8047 as set by Williams & Works in place of a T" iron they found which checked L.C.R.C. #1370 and the K.C. Surveyor's records.

L.C.R.C. #3161

L.C.R.C. #8047

Nail & KC Remon tag in NW side 14" Wild Cherry N 35° E 40.08'	Nail & K.C. remon tag in NW side 16" W. Cherry N 35° E 40.09' (m. 40.10')
Nail & KC Remon tag in S side 6" Wild Cherry S 85° E 23.91'	Nail & K.C. remon tag in NE side 18" Elm N 61° W 19.38' (m. 19.45')
Nail & KC Remon tag in NE side 12" Elm 65° W 19.76'	Nail & K.C. remon tag in S side 10" W. Cherry S 85° E 24.02' (m. 23.94')
Nail & KC Remon tag in SE side 16" Maple S 65° W 59.90'	Nail & K.C. remon tag in SE side 32" Maple S 51° W 59.67' (m. 59.71')

The selected location is accepted by me and is generally accepted by professional surveyors as the best available evidence of the position of the original corner.

C. Description of monument for corner and accessories established to perpetuate locating the position of the corner:

M-2 Reset a Standard Kent County Monument

Nail & K.C. remon. tag on NW side 16" W. Cherry N 35° E 40.10'
 Nail & K.C. remon. tag on NE side 18" Elm N 61° W 19.45'
 Nail & K.C. remon. tag on S side 10" W. Cherry S 85° E 23.94'
 Nail & K.C. remon. tag on SE side 24" Maple S 51° W 59.71'

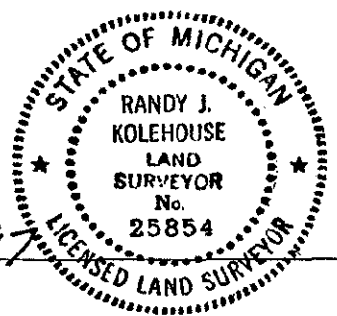

Signed by *Randy J. Kolehouse*
 EARTH TECH

Date 8-1-97

Surveyor's Michigan License No. 25854