

SURVEY & REMONUMENTATION

MAR 03 1998

LAND CORNER RECORDATION CERTIFICATE
Filing Requirement of Act 74, Mich. P.A. 1970
KENT COUNTY REMONUMENTATION

For corners in **SECTION**

Kent (County)	Located in: Ada Township	Corner Code #
1. Public Land Survey	T <u>7N</u> R <u>10W</u>	<u>M-6</u>
	T _____ R _____	_____
	T _____ R _____	_____
	T _____ R _____	_____
2. Property Controlling in Section	S _____ T _____ R _____	_____
	S _____ T _____ R _____	_____
3. Miscellaneous Property in Sec.	S _____ T _____ R _____	_____
	S _____ T _____ R _____	_____

STATE OF MICHIGAN
 COUNTY OF KENT
 RECEIVED FOR RECORD
 97 OCT 15 AM 8:52
 REG. OF DEEDS
Eric J. Bond

10248

Register of Deeds Stamp & File Number

4. Lot No. _____, Recorded Plat _____
 5. Private Claims _____

I, Randy Kolehouse, in a field survey on June 3, 1997, do hereby certify that under requirements of P.A. 74 Michigan P.A. of 1970, the corner points mentioned in lines 1 and 2 above were in conformance with regulations and rules therefore as required in the current manual of survey instructions of the United States Department of the interior, Bureau of Land Management or by a decree of a Court of Law and/or that the corner points mentioned in lines 3, 4 and 5 above were in conformance with the rules of the Michigan Board of Land Surveyors or by a Decree of a Court of Law; established, re-established, monumented, re-monumented, recovered, found as expressed below:

	A	B	C	D	E	F	G	H	I	J	K	L	M
2	6	5	4	3	2	1							
3													
4	7	8	9	10	11	12							
5													
6	18	17	16	15	14	13							
7													
8	19	20	21	22	23	24							
9													
10	30	29	28	27	26	25							
11													
12	31	32	33	34	35	36							
13													

NOTE: Not more than 4 corners, all in the same town and range, may be recorded on this certificate.

A. Description of original monument and accessories and/or subsequent restoration:

M-6	1831	G.L.O. Notes	Mullett	Set Post
	N/A	Witness Map	K.C. Surveyor	1-1/4" Iron
	1972	L.C.R.C. #465	Williams & Works	"T" Iron
	1981	L.C.R.C. #1917	Jonker Land Surveys	Fnd. "T" Iron / Set K.C. Monument
	1991	L.C.R.C. #5822	Exxel Engineering	K.C. Monument
	1994	L.C.R.C. #8051	Glaza & Associates	K.C. Monument

P.A. 345 1990 KENT COUNTY
 PEER APPROVED 6/26/97
 CHAIRMAN *Randy Kolehouse*

Note: This corner is common with A-6, T7N, R9W.

This corner was originally approved by the Kent County Remonumentation Peer Group and monumented by Rob Jonker on 7/17/81 and was recorded per L.C.R.C. #1917.

B. Description of corner evidence found and/or method applied in restoring or reestablishing corner:

M-6 Found a Standard Kent County Monument (.4' below grade) 4' South of the C/L of Downes Road (gravel) running East and West and 125' East of the C/L of Kelly Lane Pvt. (gravel) per L.C.R.C.'s #1917, #5822 and #8051 as set by Rob Jonker in place of a "T" iron he found along side of a bent 1-1/2" x 10" pipe which checked L.C.R.C. #465 and the K.C. Surveyor's records.

L.C.R.C. #1917

Remon. tag on E. side 16" Oak N 40° E 32.65'
 Remon. tag on N side 26" Oak N 79° E 77.50'
 Remon. tag on W side 18" Dbl. Hickory S 01° W 18.00'
 Remon. tag on S side 26" Oak N 63° W 72.28'

L.C.R.C. #8051

Nail & K.C. remon tag in E side 24" Oak N 42° E 32.65'
 Nail & K.C. remon tag in N side 28" Oak N 80° E 77.56'
 Nail & K.C. remon tag in W side 20" Dbl. Hickory S 07° W 18.23'
 Nail & K.C. remon tag in S side 28" Oak N 64° W 72.23'

The selected location is accepted by me and is generally accepted by professional surveyors as the best available evidence of the position of the original corner.

C. Description of monument for corner and accessories established to perpetuate locating the position of the corner:

M-6 Standard Kent County Monument

Nail & K.C. remon. tag on E side 24" Oak N 42° E 32.65'
 Nail & K.C. remon. tag on N side 28" Oak N 80° E 77.56'
 Nail & K.C. remon. tag on W side 20" Dbl. Oak S 07° W 18.23'
 Nail & K.C. remon. tag on S side 28" Oak N 64° W 72.23'

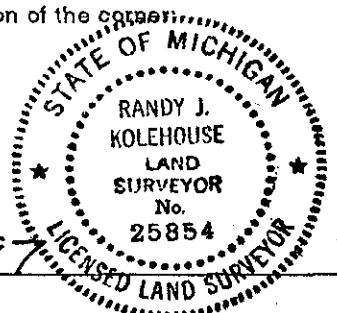

Signed by Randy J. Kolehouse Date 8-1-97
 Surveyor's Michigan License No. 25854