

SURVEY & REMONUMENTATION

MAR 03 1998

LAND CORNER RECORDATION CERTIFICATE
Filing Requirement of Act 74, Mich. P.A. 1970
KENT COUNTY REMONUMENTATION

STATE OF MICHIGAN
 COUNTY OF KENT
 RECEIVED FOR RECORD
 97 OCT 15 AM 8:52
 REG. OF DEEDS
W. J. Koblehouse

SECTION

For corners in Kent (County)

Located in:	Ada Township	Corner Code #
1. Public Land Survey	T <u>7N</u> R <u>10W</u>	<u>M-9</u>
	T _____ R _____	_____
	T _____ R _____	_____
	T _____ R _____	_____
2. Property Controlling in Section	S _____ T _____ R _____	_____
	S _____ T _____ R _____	_____
3. Miscellaneous Property in Sec.	S _____ T _____ R _____	_____
	S _____ T _____ R _____	_____

10251

Register of Deeds Stamp & File Number

4. Lot No. _____, Recorded Plat _____
 5. Private Claims _____

I, Randy Koblehouse, in a field survey on May 28 19 97, do hereby certify that under requirements of P.A. 74 Michigan P.A. of 1970, the corner points mentioned in lines 1 and 2 above were in conformance with regulations and rules therefore as required in the current manual of survey instructions of the United States Department of the Interior, Bureau of Land Management or by a decree of a Court of Law and/or that the corner points mentioned in lines 3, 4 and 5 above were in conformance with the rules of the Michigan Board of Land Surveyors or by a Decree of a Court of Law; established, re-established, monumented, re-monumented, recovered, found as expressed below:

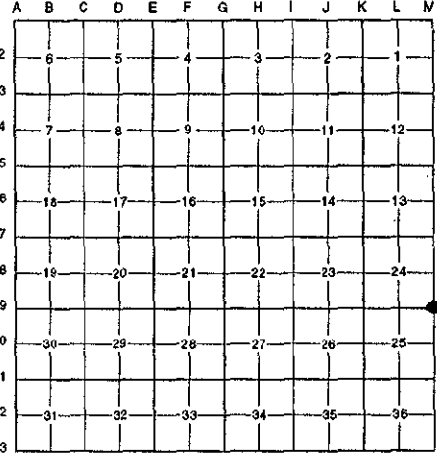

NOTE: Not more than 4 corners, all in the same town and range, may be recorded on this certificate.

A. Description of original monument and accessories and/or subsequent restoration:

M-9	1831	G.L.O. Notes	Mullett	Set Post
	N/A	Witness Map	K.C. Surveyor	Concrete Monument
	1975	L.C.R.C. #916	McCombs	3/4" Pipe (A-9, T7N, R9W)
	1977	L.C.R.C. #1022	Williams & Works	3/4" Iron
	1977	L.C.R.C. #1027	Exxel Engineering	1/2" Iron
	1981	L.C.R.C. #1920	Jonker Land Surveys	Fnd. 1/2" Iron / Set K.C. Monument
	1991	L.C.R.C. #5825	Exxel Engineering	K.C. Monument
	1994	L.C.R.C. #8054	Glaza & Associates	K.C. Monument

P.A. 345 1990 KENT COUNTY
 PEER APPROVED 6/26/97
 CHAIRMAN W. J. Koblehouse

Note: This corner is common with A-9, T7N, R9W.

This corner was originally approved by the Kent County Remonumentation Peer Group and monumented by Rob Jonker on 7/15/81 and was recorded per L.C.R.C. #1920.

B. Description of corner evidence found and/or method applied in restoring or reestablishing corner:

M-9 Found a Standard Kent County Monument 8' South of the C/L of Bailey Drive (bit.) running East and West and 3' West of the C/L of Boynton Avenue (gravel) running South per L.C.R.C.'s #1920, #5825 and #8054 as set by Rob Jonker in place of a 1/2" iron he found inside of a 3/4" iron in the top of a 5' plat monument which checked L.C.R.C.'s #1027, #1022, #916, and the K.C. Surveyor's records.

L.C.R.C. #1920	L.C.R.C. #8054
Remon. tag on NE side 20"	NE corner brick at NE corner of house S 47° W 60.85'
L.C.R.C. #5825	K.C. remon tag & nail in NE side 22" Tw. Oak N 61° W 95.39'
Remon tag on W side 16" Hickory S 08° E 119.46'	K.C. remon tag & nail in W side 16" Hickory S 08° E 119.46'

The selected location is accepted by me and is generally accepted by professional surveyors as the best available evidence of the position of the original corner.

C. Description of monument for corner and accessories established to perpetuate locating the position of the corner:

- M-9 Standard Kent County Monument
- NE corner brick at NE corner house #389 Boynton Rd. S 47° W 60.85'
 - Nail & K.C. remon. tag on NE side 22" Twin Oak N 61° W 95.39'
 - Nail & K.C. remon. tag on W side 16" Hickory S 08° E 119.46'
 - Nail & K.C. remon. tag on W side fence post S 45° E 42.43'

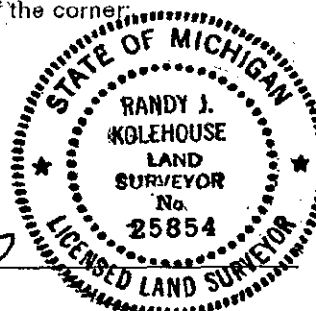

Signed by Randy J. Koblehouse Date 8-1-97

Surveyor's Michigan License No. 25854