

SURVEY & REMONUMENTATION

APR 28 1995

STATE OF MICHIGAN
COUNTY OF KENT
RECEIVED FOR RECORD
94 DEC -6 AM 9:00

COMMISSION LAND CORNER RECORDATION CERTIFICATE
Filing Requirement of Act 74, Mich. P.A. 1970
KENT COUNTY REMONUMENTATION

For corners in Kent (County) Located in: Corner Code #

1. Public Land Survey	T <u>7N</u> R <u>11W</u>	<u>C-12</u>
	T _____ R _____	_____
	T _____ R _____	_____
	T _____ R _____	_____
2. Property Controlling in Section	S _____ T _____ R _____	_____
	S _____ T _____ R _____	_____
3. Miscellaneous Property in Sec.	S _____ T _____ R _____	_____
	S _____ T _____ R _____	_____

4. Lot No. _____, Recorded Plat _____
5. Private Claims _____

Leif J. Bond
REG. OF DEEDS

7784

Register of Deeds Stamp & File Number

I, Randy Kolehouse, in a field survey on June 13 19 94, do hereby certify that under requirements of P.A. 74 Michigan P.A. of 1970, the corner points mentioned in lines 1 and 2 above were in conformance with regulations and rules therefore as required in the current manual of survey instructions of the United States Department of the Interior, Bureau of Land Management or by a decree of a Court of Law and/or that the corner points mentioned in lines 3, 4 and 5 above were in conformance with the rules of the Michigan Board of Land Surveyors or by a Decree of a Court of Law; established, re-established, monumented, re-monumented, recovered, found as expressed below:

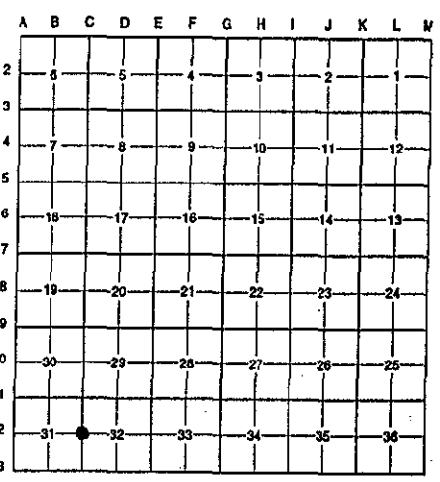

NOTE: Not more than 4 corners, all in the same town and range, may be recorded on this certificate.

A. Description of original monument and accessories and/or subsequent restoration:

C-12	1831	G.L.O. Notes	Mullett	Set Post	P.A. 345 1990 KENT COUNTY
	1935	Survey Records	E.H. Christ	City Iron	PEER APPROVED <u>11/3/94</u>
	N/A	Survey Records	City of Grand Rapids	City Iron	CHAIRMAN <i>Randy Kolehouse</i>
	1984	L.C.R.C. #3917	William R. Byl	Fnd. City Iron/Set K.C. Mon.	

This corner was originally approved by the Kent County Remonumentation Peer Group and monumented by William R. Byl on 8/14/84 and was recorded per L.C.R.C. #3917.

B. Description of corner evidence found and/or method applied in restoring or reestablishing corner:

C-12 Found standard Kent County Monument in the C/L of Franklin Street East of Eastern Avenue N-S. Franklin Avenue is 3' M/L South per L.C.R.C.'s #3917 and #4595 in place of a P.K. nail over a 2"x2" City iron he found which checked 1935 street plans and City of Grand Rapids survey records.

L.C.R.C. #3917

L.C.R.C. #4595

SE cor. building foundation N 45° W 47.76'
NE cor. building foundation S 40+ W 61.15'
NW cor. building foundation S 45° E 47.07'
SW cor. building foundation N 75° E 114.00'

SE cor. building foundation N 45° W 47.76'
NE cor. building foundation S 40+ W 61.15'
NW cor. building foundation S 45° E 47.07'
SW cor. building foundation N 75° E 114.00'

The selected location is accepted by me and is generally accepted by professional surveyors as the best available evidence of the position of the original corner.

C. Description of monument for corner and accessories established to perpetuate locating the position of the corner:

C-12 Standard Kent County Monument
SE cor. building foundation N 45° W 47.76'
NE cor. building foundation S 40° W 61.15'
NW cor. building foundation S 45° E 47.07'
SW cor. building foundation N 75° E 114.00'

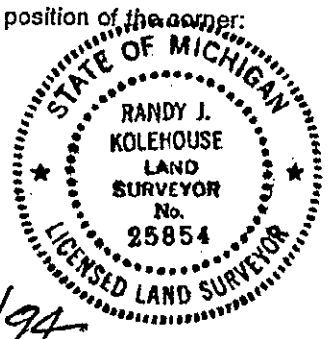

Signed by *Randy J. Kolehouse* Date 12/1/94
Surveyor's Michigan License No. 25854