

SURVEY & REMONUMENTATION

KENT COUNTY REMONUMENTATION

APR 28 1995

LAND CORNER RECORDATION CERTIFICATE
Filing Requirement of Act 74, Mich. P.A. 1970

STATE OF MICHIGAN
COUNTY OF KENT
RECEIVED FOR RECORD

94 NOV 28 AM 11:43

For corners in
KENT COUNTY
COMMISSION
(County)

Located In:	Corner Code #
T 7N R 12W	A-9
T R	
T R	
T R	
T R	
S T R	
S T R	
S T R	
S T R	

W. J. Bond
REG. OF DEEDS

7276

Register of Deeds Stamp & File Number

4. Lot No. _____, Recorded Plat _____
5. Private Claims _____

	A	B	C	D	E	F	G	H	I	J	K	L	M
2	6		5		4		3		2		1		
3													
4	7		8		9		10		11		12		
5													
6	18		17		16		15		14		13		
7													
8	19		20		21		22		23		24		
9													
10	30		29		28		27		26		25		
11													
12	31		32		33		34		35		36		
13													

I, William R. Byl, in a field survey on July 21, 19 94, do hereby certify that under requirements of P.A. 74, Michigan P.A. of 1970, the corner points mentioned in lines 1 and 2 above were in conformance with regulations and rules therefore as required in the current manual of survey instructions of the United States Department of the Interior, Bureau of Land Management or by a decree of a Court of Law and/or that the corner points mentioned in lines 3, 4 and 5 above were in conformance with the rules of the Michigan Board of Land Surveyors or by a Decree of a Court of Law; established, re-established, monumented, re-monumented, recovered, found as expressed below:

NOTE: Not more than 4 corners, all in the same town and range, may be recorded on this certificate.

A. Description of original monument and accessories and/or subsequent restoration:

A-9	1836	GLO	Brookfield	Set Post (common with M-9, T7N, R13W)
		Kent Co. Wit		Mon. Box
	1973	LCRC #376	Spencer	3/4" dia. Iron in mon. box
	1976	LCRC #903	McCloskey	Mon. Box
	1981	LCRC #2027	Hackbardt	Set Kent County Monument
	1990	LCRC #5503	Starr	Kent County Monument

The position of this corner was previously approved by the Kent County Remonumentation Peer Group, monumented by Glen S. Hackbardt on 6/8/81 and was recorded per LCRC #2027

B. Description of corner evidence found and/or method applied in restoring or reestablishing corner:

A-9 Found standard Kent Co. Mon. (Harrison) in mon. box per witnesses from above LCRC as set by Glen S. Hackbardt in place of the 3/4" Iron in mon. box he found. Said 3/4" Iron checks with Kent Co. Wit. and LCRC's #376 & #903.

LCRC #2027	LCRC #5503
KC Nail & tag MBT Pole N05°W 48.54'	C/L 3" Steel post to 1000 gas
KC Nail & tag 10" Elm N25°E 71.97'	line sign N60°W 77.60'
C/L 3" steel post to 1000 gas line sign N60°W 77.60'	Top C/L hydr. N60°E 60.70'
	Nail & KC tag wood sign post S60°W 90.03'
	Nail & KC tag Tri. 6" Maple S20°W 63.80'
	Top C/L Tel. Box S10°E 44.90'
	3' S. C/L E-W Bit. Rd.; Tree Row South

The selected location is accepted by me and is generally accepted by professional surveyors as the best available evidence of the position of the original corner.

C. Description of monument for corner and accessories established to perpetuate locating the position of the corner:

A-9 Standard Kent County Monument in mon. box	
C/L 3" Steel post to 1000 gas line sign	N60°W 77.66'
Top C/L hydr.	N60°E 60.50'
Set Nail & KC Remon. tag E. side wood sign post	S50°W 88.92'
Set Nail & KC Remon. tag N. side P. Pole	S70°E 142.73'
Top C/L Tel. Box	S10°E 44.90'
3' S. C/L E-W Bit. Rd.; Tree Row South	

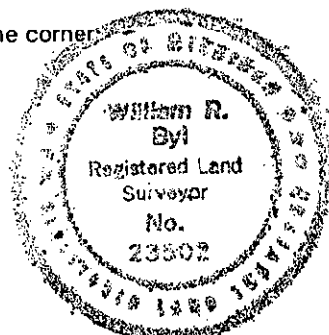

PEER APPROVED 11/17/94
CHAIRMAN Harry Huber

Signed by W. R. Byl Date 11-17-94

Surveyor's Michigan License No. 23502