

SURVEY & REMONUMENTATION

KENT COUNTY REMONUMENTATION

APR 28 1995

LAND CORNER RECORDATION CERTIFICATE

COMMISSION Filing Requirement of Act 74, Mich. P.A. 1970

STATE OF MICHIGAN
COUNTY OF KENT
RECEIVED FOR RECORD
94 NOV 28 AM 11:43

Leif J. Bond
REG. OF DEEDS

For corners in
KENT COUNTY
(County)

Located In: Corner Code #

1. Public Land Survey	T	7N	R	12W	A-12
	T		R		
	T		R		
	T		R		
2. Property Controlling in Section	S		T	R	
	S		T	R	
3. Miscellaneous Property in Sec.	S		T	R	
	S		T	R	

7278

Register of Deeds Stamp & File Number

4. Lot No. _____, Recorded Plat _____
5. Private Claims _____

	A	B	C	D	E	F	G	H	I	J	K	L	M
2	6	5	4	3	2	1							
3													
4	7	8	9	10	11	12							
5													
6	18	17	16	15	14	13							
7													
8	19	20	21	22	23	24							
9													
10	30	29	28	27	26	25							
11													
12	31	32	33	34	35	36							
13													

I, William R. Byl, in a field survey on Sept. 1, 19 94, do hereby certify that under requirements of P.A. 74, Michigan P.A. of 1970, the corner points mentioned in lines 1 and 2 above were in conformance with regulations and rules therefore as required in the current manual of survey instructions of the United States Department of the Interior, Bureau of Land Management or by a decree of a Court of Law and/or that the corner points mentioned in lines 3, 4 and 5 above were in conformance with the rules of the Michigan Board of Land Surveyors or by a Decree of a Court of Law; established, re-established, monumented, re-monumented, recovered, found as expressed below:

NOTE: Not more than 4 corners, all in the same town and range, may be recorded on this certificate.

A. Description of original monument and accessories and/or subsequent restoration:

A-12	1836	GLO	Brookfield	Set Post (common with M-12, T7N, R13W)
	1963	Kent Co. Wit.		1" Iron
	1972	LCRC #328	Spicer	1 1/2" Iron
	1982	LCRC #3168	Jonker	Set Kent County Monument
	1990	LCRC #5506	Starr	Kent County Monument

The position of this corner was previously approved by the Kent County Remonumentation Peer Group, monumented by Robert J. Jonker on 11/15/82 and was recorded per LCRC #3168

B. Description of corner evidence found and/or method applied in restoring or reestablishing corner:

A-12 Found standard Kent Co. Mon. (Harrison) per witnesses from above LCRC as set by Robert J. Jonker in place of the 1 1/2" x 66" Iron Pipe he found. Said Iron Pipe checks with Kent Co. Wit. & LCRC #328.

<u>LCRC #3168</u>	<u>LCRC #5506</u>
Remon. tag P. & T. Pole N85°W 29.65'	uses same witnesses as
Remon. tag 8" Pine S35°E 58.94'	LCRC #3168 plus-
NE cor. brick house N50°W 110.00'	Nail & KC tag 12" Walnut S25°W 31.42'
SW cor. brick garage N70°E 98.53'	
On E-W tree line; C/L Grav. Rd. 4' E.	

The selected location is accepted by me and is generally accepted by professional surveyors as the best available evidence of the position of the original corner.

C. Description of monument for corner and accessories established to perpetuate locating the position of the corner:

A-12 Standard Kent County Monument				
New Nail & KC Remon. tag N. side	P. & T. Pole	N85°W	29.69'	
New Nail & KC Remon. tag NE side	14" Pine	S35°E	58.73'	
NE cor. brick house		N50°W	110.00'	
SW cor. brick garage		N70°E	98.53'	
Nail & KC Remon. tag SE side	12" Walnut	S25°W	31.42'	
On E-W tree line; C/L Grav. Rd. 4' E.				

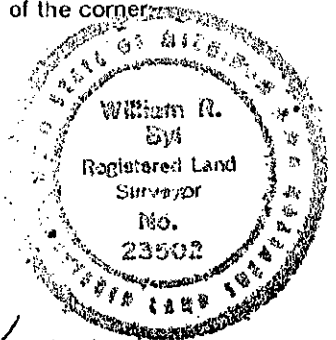

P.A. 345 1990 KENT COUNTY

PEER APPROVED 11/17/94

CHAIRMAN Harry Hubert

W. R. Byl

Signed by _____ Date 11-17-94

Surveyor's Michigan License No. 23502