

\$7.00
\$2.00

JAN 24 1996

LAND CORNER RECORDATION CERTIFICATE
Filing Requirement of Act 74, Mich. P.A. 1970

For corners in **COMMISSION**
KENT COUNTY
(County)

Located In:

Corner Code #

1. Public Land Survey	T	7N	R	12W	B-12
	T		R		
	T		R		
	T		R		
2. Property Controlling in Section	S		T	R	
	S		T	R	
3. Miscellaneous Property in Section	S		T	R	
	S		T	R	

STATE OF MICHIGAN
COUNTY OF KENT
RECEIVED FOR RECORD
95 DEC 26 PM 12:43
REC. OF DEEDS
Lucy Bond
8864

Register of Deeds Stamp & File Number

4. Lot No. _____, Recorded Plat _____
5. Private Claims _____

A	B	C	D	E	F	G	H	I	J	K	L	M
2	6	5	4	3	2	1						
3												
4	7	6	9	10	11	12						
5												
6	18	17	16	15	14	13						
7												
8	19	20	21	22	23	24						
9												
10	30	29	28	27	26	25						
11												
12	31	32	33	34	35	36						
13												

I, Kirk Breitels, in a field survey on Nov. 15, 1994, do hereby certify that under requirements of P.A. 74, Michigan P.A. of 1970, the corner points mentioned in lines 1 and 2 above were in conformance with regulations and rules therefore as required in the current manual of survey instructions of the United States Department of the Interior, Bureau of Land Management or by a decree of a Court of Law and/or that the corner points mentioned in lines 3, 4 and 5 above were in conformance with the rules of the Michigan Board of Professional Surveyors or by a Decree of a Court of Law; established, re-established, monumented, re-monumented, recovered, found as expressed below:

NOTE: Not more than 4 corners, all in the same town and range, may be recorded on this certificate.

A. Description of original monument and accessories and/or subsequent restoration:

- B-12 1837 GLO Not Set 1937-58 Williams & Works Iron
- 1935 Kent Co. Wit. Iron in fence
- 20" Pine NW 51.82' 12" DbI. Cherry W. 36.15' 24" Oak SE 32.5'
- 1975 LCRC #787 Bonnema 1/2" Iron
- 24" Cherry SE 24.25' Tw. 20" Oak NW 10.79' C/L steel post S. 5.52'
- 14" Oak NNE 46.00' C/L Wilson Ave. E. 80'
- 1986 LCRC #4391 Rosema 1/2" Iron
- 24" Cherry ESE 24.23' 14" Oak NNE 46.00' C/L Wilson Ave. E. 80'
- 24" Tw. Oak WNW 11.60' 4" Maple S. 12.51' C/L MBT Box W. 1.66'

B. Description of corner evidence found and/or method applied in restoring or reestablishing corner:

B-12 Found 1/2" Iron Pipe that fits remaining witnesses of above. Said Iron Pipe is 0.2' E. & 4.9' N. from true intersection of 1/4 lines and fits previous survey data of others.

The 1/2" Iron Pipe is accepted by me and is generally accepted by professional surveyors as the best available evidence of the position of the corner.

P.A. 345 1990 KENT COUNTY
PEER APPROVED 11/17/94
CHAIRMAN [Signature]

C. Description of monument for corner and accessories established to perpetuate locating the position of the corner:

- B-12 Set Standard Kent County Monument in place of the 1/2" Iron Pipe
- Set Nail & KC Remon. tag E. side 6" Maple S00°E 12.54'
- Set Nail & KC Remon. tag S. side 30" Cherry S60°E 24.22'
- Set Nail & KC Remon. tag S. side 24" Tw. Cherry N70°W 36.50'
- Set Nail & KC Remon. tag W. side 28" Oak N30°E 45.98'
- Set Nail & KC Remon. tag SW side Tw. 30" Oak N40°W 11.28'
- C/L MBT Box - West 1.9'
- C/L Wilson Ave. - East 80'±

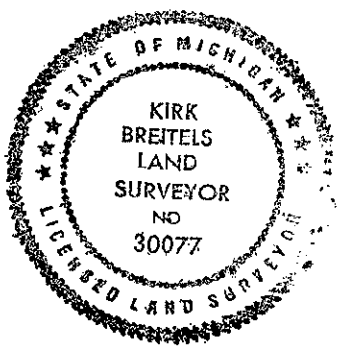

Signed by [Signature]

Date 12/14/95

Surveyor's Michigan License No. 30077