

# SURVEY & REMONUMENTATION

KENT COUNTY REMONUMENTATION

APR 28 1995

LAND CORNER RECORDATION CERTIFICATE  
Filing Requirement of Act 74, Mich. P.A. 1970

STATE OF MICHIGAN  
COUNTY OF KENT  
RECEIVED FOR RECORD  
94 NOV 28 AM 11:45

For corners in **COMMISSION**  
KENT COUNTY

*Lucy Bond*  
REG. OF DEEDS

(County)	Located In:	Corner Code #
1. Public Land Survey	T <u>7N</u> R <u>12W</u>	<u>C-3</u>
	T _____ R _____	_____
	T _____ R _____	_____
	T _____ R _____	_____
2. Property Controlling in Section	S _____ T _____ R _____	_____
	S _____ T _____ R _____	_____
3. Miscellaneous Property in Sec.	S _____ T _____ R _____	_____
	S _____ T _____ R _____	_____

7287

Register of Deeds Stamp & File Number

4. Lot No. \_\_\_\_\_, Recorded Plat \_\_\_\_\_  
5. Private Claims \_\_\_\_\_

	A	B	C	D	E	F	G	H	I	J	K	L	M
2	6		5	4	3	2	1						
3			●										
4	7	8	9	10	11	12							
5													
6	18	17	16	15	14	13							
7													
8	19	20	21	22	23	24							
9													
10	30	29	28	27	26	25							
11													
12	31	32	33	34	35	36							
13													

I, William R. Byl, in a field survey on July 5, 19 94, do hereby certify that under requirements of P.A. 74, Michigan P.A. of 1970, the corner points mentioned in lines 1 and 2 above were in conformance with regulations and rules therefore as required in the current manual of survey instructions of the United States Department of the Interior, Bureau of Land Management or by a decree of a Court of Law and/or that the corner points mentioned in lines 3, 4 and 5 above were in conformance with the rules of the Michigan Board of Land Surveyors or by a Decree of a Court of Law; established, re-established, monumented, re-monumented, recovered, found as expressed below:

**NOTE: Not more than 4 corners, all in the same town and range, may be recorded on this certificate.**

A. Description of original monument and accessories and/or subsequent restoration:

C-3	1837	GLO	Whitcomb	Set Post
		Kent Co. Wit.		1" Iron in Mon. Box
	1973	LCRC #447	VanKooten	3/4" Round Iron in Mon. Box
	1981	LCRC #1848	Shangraw	Set Kent County Monument
	1990	LCRC #5515	Starr	Kent County Monument

The position of this corner was previously approved by the Kent County Remonumentation Peer Group, monumented by Carl F. Shangraw on 5/20/81 and was recorded per LCRC #1848

B. Description of corner evidence found and/or method applied in restoring or reestablishing corner:

C-3 Found standard Kent Co. Mon. (Harrison) per witnesses from above LCRC as set by Carl F. Shangraw in place of the 3/4" Iron in Mon. Box he found. Said 3/4" Iron in Mon. Box checks with Kent Co. Wit. and LCRC #447.

LCRC #1848

LCRC #5515

KC Nail & tag P. Pole	N30°W	50.10'	Nail & KC Remon. tag P. Pole	N30°W	50.10'
Top center of hydr.	N55°W	58.89'	Top center of hydr.	N55°W	58.89'
KC Nail & tag Guy Pole	N45°E	54.92'	Nail & KC Remon. tag Guy Pole	N45°E	54.92'
Most NW'ly cor. CB grate	S45°W	44.47'	Most NW'ly cor. CB grate	S45°W	44.47'
			Nail & KC Remon. tag P. Pole	S20°W	78.23'
			C/L steel fence post	S40°E	52.35'
			On C/L E-W-S Bit. Rd.; On C/L Bit. drive N.		

The selected location is accepted by me and is generally accepted by professional surveyors as the best available evidence of the position of the original corner.

C. Description of monument for corner and accessories established to perpetuate locating the position of the corner

C-3 Standard Kent County Monument

Nail & KC Remon. tag NE side P. Pole	N30°W	50.08'
Top center of hydr.	N55°W	59.15'
Nail & KC Remon. tag NW side Guy Pole	N45°E	54.90'
Most NW'ly cor. CB grate	S45°W	44.42'
Nail & KC Remon. tag E. side P. Pole	S20°W	78.23'
C/L steel fence post	S40°E	52.35'
On C/L E-W-S Bit. Rd.; On C/L Bit. drive N.		

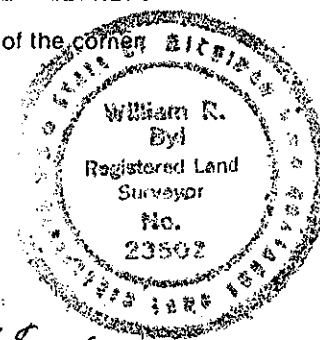

PEER APPROVED 11/17/94  
CHAIRMAN Shangraw  
Date 11-17-94

Signed by William R. Byl Date \_\_\_\_\_  
Surveyor's Michigan License No. 23502