

**SURVEY & REMONUMENTATION**

APR 28 1995

KENT COUNTY REMONUMENTATION

STATE OF MICHIGAN  
COUNTY OF KENT  
RECEIVED FOR RECORD

**COMMISSION**

**LAND CORNER RECORDATION CERTIFICATE**  
Filing Requirement of Act 74, Mich. P.A. 1970

54 NOV 28 AM 11:47

For corners in  
KENT COUNTY  
(County)

Located In:

Corner Code #

- 1. Public Land Survey T 7N R 12W
- T \_\_\_\_\_ R \_\_\_\_\_
- T \_\_\_\_\_ R \_\_\_\_\_
- T \_\_\_\_\_ R \_\_\_\_\_
- T \_\_\_\_\_ R \_\_\_\_\_
- 2. Property Controlling S \_\_\_\_\_ T \_\_\_\_\_ R \_\_\_\_\_
- in Section              S \_\_\_\_\_ T \_\_\_\_\_ R \_\_\_\_\_
- 3. Miscellaneous          S \_\_\_\_\_ T \_\_\_\_\_ R \_\_\_\_\_
- Property in Sec.      S \_\_\_\_\_ T \_\_\_\_\_ R \_\_\_\_\_

E-9  
\_\_\_\_\_  
\_\_\_\_\_  
\_\_\_\_\_  
\_\_\_\_\_

*W. J. Bond*  
REG. OF DEEDS

**7310**

Register of Deeds Stamp & File Number

- 4. Lot No. \_\_\_\_\_, Recorded Plat \_\_\_\_\_
- 5. Private Claims \_\_\_\_\_

	A	B	C	D	E	F	G	H	I	J	K	L	M
2	6	5	4	3	2	1							
3													
4	7	8	9	10	11	12							
5													
6	18	17	16	15	14	13							
7													
8	19	20	21	22	23	24							
9													
10	30	29	28	27	26	25							
11													
12	31	32	33	34	35	36							
13													

I, William R. Byl, in a field survey on July 22, 19 94, do hereby certify that under requirements of P.A. 74, Michigan P.A. of 1970, the corner points mentioned in lines 1 and 2 above were in conformance with regulations and rules therefore as required in the current manual of survey instructions of the United States Department of the Interior, Bureau of Land Management or by a decree of a Court of Law and/or that the corner points mentioned in lines 3, 4 and 5 above were in conformance with the rules of the Michigan Board of Land Surveyors or by a Decree of a Court of Law; established, re-established, monumented, re-monumented, recovered, found as expressed below:

**NOTE: Not more than 4 corners, all in the same town and range, may be recorded on this certificate.**

**A. Description of original monument and accessories and/or subsequent restoration:**

- E-9 1837 GLO Whitcomb Set Post
- 1972 LCRC #352 Spicer 3/4" Solid Iron in Mon. Box
- 1981 LCRC #3314 Tobin Set Kent County Monument
- 1990 LCRC #5538 Starr Kent County Monument

The position of this corner was previously approved by the Kent County Remonumentation Peer Group, monumented by Douglas A. Tobin on 5/22/82 and was recorded per LCRC #3314

**B. Description of corner evidence found and/or method applied in restoring or reestablishing corner:**

E-9 Found standard Kent Co. Mon. (Harrison) per witnesses from above LCRC as set by Douglas J. Tobin in place of the 3/4" Iron he found in a Mon. Box. Said 3/4" Iron checks with LCRC #352.

<u>LCRC #3314</u>	<u>LCRC #5538</u>
KC Nail & tag P. Pole N40°E 43.10'	Nail & KC Remon. tag P. Pole N45°W 54.72'
KC Nail & tag P. Pole N45°W 54.72'	Nail & KC Remon. tag P. Pole S32°E 69.54'
KC Nail & tag P. Pole S32°E 69.54'	Nail & KC Remon. tag P. Pole S33°W 76.15'
KC Nail & tag P. Pole S33°W 76.15'	Nail & KC Remon. tag P. Pole N50°E 52.82'
	On C/L Bit. Rd. N-S; C/L Bit. Rd. E-W is 1' S.

The selected location is accepted by me and is generally accepted by professional surveyors as the best available evidence of the position of the original corner.

**C. Description of monument for corner and accessories established to perpetuate locating the position of the corner:**

- E-9 Standard Kent County Monument
- Nail & KC Remon. tag S. side P. Pole N45°W 54.67'
- Nail & KC Remon. tag W. side P. Pole S32°E 69.54'
- Nail & KC Remon. tag E. side P. Pole S33°W 76.15'
- Nail & KC Remon. tag W. side P. Pole N50°E 52.82'
- On C/L Bit. Rd. N-S; C/L Bit. Rd. E-W is 1' S.

P.A. 345 1990 KENT COUNTY  
PEER APPROVED 11/17/94  
CHAIRMAN Harry Thubert

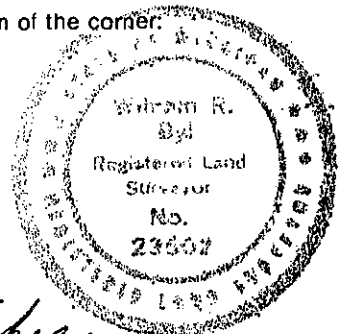

Signed by W. R. Byl Date 11-17-94  
Surveyor's Michigan License No. 23502