

SURVEY & MONUMENTATION

\$7.00  
\$2.00

JAN 24 1996  
COMMISSION

KENT COUNTY REMONUMENTATION  
LAND CORNER RECORDATION CERTIFICATE  
Filing Requirement of Act 74, Mich. P.A. 1970

For corners in KENT COUNTY (County)	Located In:	Corner Code #
1. Public Land Survey	T <u>7N</u> R <u>12W</u>	<u>F-4</u>
	T _____ R _____	_____
	T _____ R _____	_____
	T _____ R _____	_____
2. Property Controlling in Section	S _____ T _____ R _____	_____
	S _____ T _____ R _____	_____
3. Miscellaneous Property in Section	S _____ T _____ R _____	_____
	S _____ T _____ R _____	_____
4. Lot No. _____, Recorded Plat _____		
5. Private Claims _____		

STATE OF MICHIGAN  
COUNTY OF KENT  
RECEIVED FOR RECORD  
95 DEC 26 PM 12:42  
REG. OF DEEDS  
*W. J. Spauld*  
8842  
Register of Deeds Stamp & File Number

A	B	C	D	E	F	G	H	I	J	K	L	M
2	0	1	2	3	4	5	6	7	8	9	10	11
3												
4	7	8	9	10	11	12						
5												
6	18	17	16	15	14	13						
7												
8	19	20	21	22	23	24						
9												
10	30	29	28	27	26	25						
11												
12	31	32	33	34	35	36						
13												

I, Kirk Breitels, in a field survey on Nov. 15, 19 94, do hereby certify that under requirements of P.A. 74, Michigan P.A. of 1970, the corner points mentioned in lines 1 and 2 above were in conformance with regulations and rules therefore as required in the current manual of survey instructions of the United States Department of the Interior, Bureau of Land Management or by a decree of a Court of Law and/or that the corner points mentioned in lines 3, 4 and 5 above were in conformance with the rules of the Michigan Board of Professional Surveyors or by a Decree of a Court of Law; established, re-established, monumented, re-monumented, recovered, found as expressed below:

NOTE: Not more than 4 corners, all in the same town and range, may be recorded on this certificate.

A. Description of original monument and accessories and/or subsequent restoration:

- F-4 1837 GLO Not Set 1907-70 Williams & Works Iron Rod set by Sheels  
15" Elm ESE 59.5' 8" Beech SE 29.4'  
8" Maple SSE 63.2' 14" Maple NNW 108.9'
- 1966 Kent Co. Wit. Iron  
12" Beech SE 29.15' 18" DbI. Ironwood ESE 52.14' P.A. 345 1990 KENT COUNTY.  
24" Maple SSE 35.51' SE cor. greenhouse NNW 9.26' PEER APPROVED 11/17/94
- 1973 LCRC #522 Spicer 1 1/2" Iron CHAIRMAN *Frank Huber*  
SE cor. greenhse. N15°W 9.26' 14" Beech S40°E 29.70'  
22" Maple S75°E 36.78'

B. Description of corner evidence found and/or method applied in restoring or reestablishing corner:

F-4 Did not find anything at corner, location is in front yard of Hse. #2384 which is in the process of being landscaped to be finished in spring (location of corner may be disturbed). Established location from dimensions and angles per "Elmridge Estates No. 1" (Liber 75, Pg. 46 1976). Location fits remaining witnesses of those above and measurements by others. Said location is 0.0' S. & 16.7' E. from true intersection of 1/4 lines.

- C/L 18" Beech SE 29.6'±
- C/L 22" Stump ESE 36.6'±

The location as described above is accepted by me and is generally accepted by professional surveyors as the best available evidence of the position of the corner.

C. Description of monument for corner and accessories established to perpetuate locating the position of the corner:

- F-4 Set Capped Rerod at location described above
- Set Nail & KC Remon. tag SW side 18" Beech S40°E 29.63'
- Set Nail & KC Remon. tag N. side 12" Maple S80°E 64.76'
- SE cor. brick veneer of house #2384 N30°W 17.08'
- Set Nail & KC Remon. tag W. side 30" Maple S00°W 69.27'
- Set Nail & KC Remon. tag SE side P. Pole S50°W 92.47'

SEE LCRC # 8843 FOR LOCATION OF WITNESS MONUMENT (157.00' South)

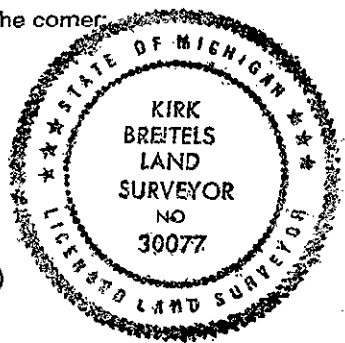

Signed by *Kirk Breitels*  
Surveyor's Michigan License No. 30077

Date 12/14/95