

SURVEY & REMONUMENTATION

APR 28 1995

KENT COUNTY REMONUMENTATION

COMMISSION

LAND CORNER RECORDATION CERTIFICATE
Filing Requirement of Act 74, Mich. P.A. 1970

STATE OF MICHIGAN
COUNTY OF KENT
RECEIVED FOR RECORD
94 NOV 28 AM 11:47

Lucy Bond
REG. OF DEEDS

For corners in
KENT COUNTY

(County)	Located In:	Corner Code #
1. Public Land Survey	T 7N R 12W	G-1
	T _____ R _____	_____
	T _____ R _____	_____
	T _____ R _____	_____
2. Property Controlling in Section	S _____ T _____ R _____	_____
	S _____ T _____ R _____	_____
3. Miscellaneous Property in Sec.	S _____ T _____ R _____	_____
	S _____ T _____ R _____	_____

7318

Register of Deeds Stamp & File Number

4. Lot No. _____, Recorded Plat _____
5. Private Claims _____

	A	B	C	D	E	F	G	H	I	J	K	L	M
2	6	5	4	3	2	1							
3													
4	7	8	9	10	11	12							
5													
6	18	17	16	15	14	13							
7													
8	19	20	21	22	23	24							
9													
10	30	29	28	27	26	25							
11													
12	31	32	33	34	35	36							
13													

I, William R. Byl, in a field survey on June 30, 19 94, do hereby certify that under requirements of P.A. 74, Michigan P.A. of 1970, the corner points mentioned in lines 1 and 2 above were in conformance with regulations and rules therefore as required in the current manual of survey instructions of the United States Department of the Interior, Bureau of Land Management or by a decree of a Court of Law and/or that the corner points mentioned in lines 3, 4 and 5 above were in conformance with the rules of the Michigan Board of Land Surveyors or by a Decree of a Court of Law; established, re-established, monumented, re-monumented, recovered, found as expressed below:

NOTE: Not more than 4 corners, all in the same town and range, may be recorded on this certificate.

A. Description of original monument and accessories and/or subsequent restoration:

G-1	1837	GLO	Brookfield	Set Post
	1962	Kent Co. Wit.		Mon. Box
	1973	LCRC #539	Spicer	1 1/2" Iron in Mon. Box
	1982	LCRC #3154	Hackbardt	Set Kent County Monument

The position of this corner was previously approved by the Kent County Remonumentation Peer Group, monumented by Glen S. Hackbardt on 8/6/82 and was recorded per LCRC #3154

B. Description of corner evidence found and/or method applied in restoring or reestablishing corner:

G-1 Found standard Kent Co. Mon. (Harrison) per witnesses from above LCRC as set by Glen S. Hackbardt in place of the Iron he found in Mon. Box. Said Iron in Mon. Box checks with Kent Co. Wit. and LCRC #539.

LCRC #3154

Mon. Box	East	1.32'		
Harrison Monument	West	1.32'		
KC Nail & tag	20" Maple	N60°W	100.00'	
KC Nail & tag	8" Pine	N40°W	88.02'	
KC Nail & tag	26" Ash	N25°E	33.66'	
KC Nail & tag	12" Elm	N55°E	64.81'	

P.A. 345 1990 KENT COUNTY

PEER APPROVED 11/17/94

CHAIRMAN *Harry Heber*

The selected location is accepted by me and is generally accepted by professional surveyors as the best available evidence of the position of the original corner.

C. Description of monument for corner and accessories established to perpetuate locating the position of the corner:

G-1 Standard Kent County Monument

Set Nail & KC Remon. tag	NE side	24" Maple	N60°W	99.96'
Set Nail & KC Remon. tag	SW side	12" Pine	N40°W	88.02'
Set Nail & KC Remon. tag	W. side	36" Ash	N25°E	33.76'
Set Nail & KC Remon. tag	W. side	Tw. 12" Maple	N25°W	38.06'
NE cor. house foundation			S30°W	114.22'
Kent Co. Monument (G-13, T8N, R12W)			S90°W	1.32'

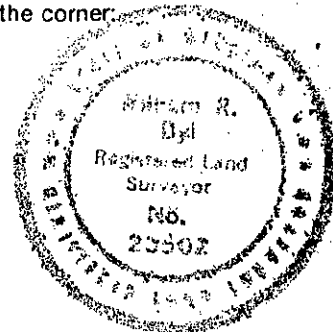

Signed by

W. R. Byl

Date

11-17-94

Surveyor's Michigan License No.

23502