

APR 28 1995

LAND CORNER RECORDATION CERTIFICATE
Filing Requirement of Act 74, Mich. P.A. 1970

STATE OF MICHIGAN
COUNTY OF KENT
RECEIVED FOR RECORD
94 NOV 28 AM 11:48

For corners in
COMMISSION
KENT COUNTY
(County)

Located In: Corner Code #

- | | | |
|------------------------------------|--------------------------|------------|
| 1. Public Land Survey | T <u>7N</u> R <u>12W</u> | <u>G-9</u> |
| | T ___ R ___ | _____ |
| | T ___ R ___ | _____ |
| | T ___ R ___ | _____ |
| 2. Property Controlling in Section | S ___ T ___ R ___ | _____ |
| | S ___ T ___ R ___ | _____ |
| 3. Miscellaneous Property in Sec. | S ___ T ___ R ___ | _____ |

Luigi Bond
REG. OF DEEDS

7325

Register of Deeds Stamp & File Number

4. Lot No. _____, Recorded Plat _____
5. Private Claims _____

A	B	C	D	E	F	G	H	I	J	K	L	M
2	6	5	4	3	2	1						
3												
4	7	8	9	10	11	12						
5												
6	18	17	16	15	14	13						
7												
8	19	20	21	22	23	24						
9												
10	30	29	28	27	26	25						
11												
12	31	32	33	34	35	36						
13												

I, William R. Byl, in a field survey on Sept. 2, 1994, do hereby certify that under requirements of P.A. 74, Michigan P.A. of 1970, the corner points mentioned in lines 1 and 2 above were in conformance with regulations and rules therefore as required in the current manual of survey instructions of the United States Department of the Interior, Bureau of Land Management or by a decree of a Court of Law and/or that the corner points mentioned in lines 3, 4 and 5 above were in conformance with the rules of the Michigan Board of Land Surveyors or by a Decree of a Court of Law; established, re-established, monumented, re-monumented, recovered, found as expressed below:

NOTE: Not more than 4 corners, all in the same town and range, may be recorded on this certificate.

A. Description of original monument and accessories and/or subsequent restoration:

- | | | | | |
|-----|-----------|---------------|------------|--------------------------|
| G-9 | 1837 | GLO | Whitcomb | Set Post |
| | 1935,1954 | Kent Co. Wit. | | "X" in pavement |
| | 1973 | LCRC #576 | Spicer | Mon. Box |
| | 1974 | LCRC #740 | Bonnema | Solid Bar in Mon. Box |
| | 1982 | LCRC #2794 | Merdzinski | Set Kent County Monument |
| | 1990 | LCRC #5556 | Starr | Kent County Monument |

The position of this corner was previously approved by the Kent County Remonumentation Peer Group, monumented by John A. Merdzinski on 3/23/82 and was recorded per LCRC #2794

B. Description of corner evidence found and/or method applied in restoring or reestablishing corner:

G-9 Found standard Kent Co. Mon. (Harrison) per witnesses from above LCRC as set by John A. Merdzinski in place of the Boat Spike he found in a Mon. Box. Said Boat Spike in a Mon. box checks with Kent Co. Wit. and LCRC's #576 & #740.

<u>LCRC #2794</u>	<u>LCRC #5556</u>
Nail & tag P. Pole N25°W 78.78'	same witnesses as LCRC #2794
Nail & tag P. Pole N60°E 76.54'	
Nail & tag T. Pole S50°W 35.76'	
Nail & tag Guy Pole S30°E 29.39'	
C/L Lake Mich. Dr. is 2' N	
C/L Oakleigh is 2' W.	

P.A. 345 1990 KENT COUNTY
PEER APPROVED 11/17/94
CHAIRMAN *Harry Huber*

The selected location is accepted by me and is generally accepted by professional surveyors as the best available evidence of the position of the original corner.

C. Description of monument for corner and accessories established to perpetuate locating the position of the corner:

- | | |
|---------------------------------------|-------------------------------|
| G-9 | Standard Kent County Monument |
| Nail & KC Remon. tag E. side P. Pole | N25°W 78.84' |
| Nail & KC Remon. tag S. side P. Pole | N60°E 76.50' |
| Nail & KC Remon. tag NW side T. Pole | S50°W 35.66' |
| Nail & KC Remon. tag E. side Guy Pole | S30°E 29.57' |
| C/L Lake Mich. Dr. is 2' N | |
| C/L Oakleigh is 2' W. | |

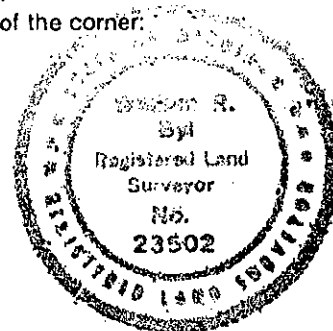

Signed by *W. R. Byl* Date *11-17-94*
Surveyor's Michigan License No. *23502*