

**SURVEY & REMONUMENTATION**

KENT COUNTY REMONUMENTATION

APR 28 1995

**LAND CORNER RECORDATION CERTIFICATE**

**COMMISSION Filing Requirement of Act 74, Mich. P.A. 1970**

STATE OF MICHIGAN  
COUNTY OF KENT  
RECEIVED FOR RECORD

94 NOV 28 AM 11:48

For corners in  
KENT COUNTY

(County)

Located In:

Corner Code #

- |                                    |                          |            |
|------------------------------------|--------------------------|------------|
| 1. Public Land Survey              | T <u>7N</u> R <u>12W</u> | <u>H-9</u> |
|                                    | T _____ R _____          | _____      |
|                                    | T _____ R _____          | _____      |
|                                    | T _____ R _____          | _____      |
| 2. Property Controlling in Section | S _____ T _____ R _____  | _____      |
|                                    | S _____ T _____ R _____  | _____      |
| 3. Miscellaneous Property in Sec.  | S _____ T _____ R _____  | _____      |
|                                    | S _____ T _____ R _____  | _____      |

*Lucy Bond*  
REG. OF DEEDS

**7332**

Register of Deeds Stamp & File Number

4. Lot No. \_\_\_\_\_, Recorded Plat \_\_\_\_\_  
5. Private Claims \_\_\_\_\_

A	B	C	D	E	F	G	H	I	J	K	L	M
2	6	5	4	3	2	1						
3												
4	7	8	9	10	11	12						
5												
6	18	17	16	15	14	13						
7												
8	19	20	21	22	23	24						
9												
10	30	29	28	27	26	25						
11												
12	31	32	33	34	35	36						
13												

I, William R. Byl, in a field survey on June 2, 19 94, do hereby certify that under requirements of P.A. 74, Michigan P.A. of 1970, the corner points mentioned in lines 1 and 2 above were in conformance with regulations and rules therefore as required in the current manual of survey instructions of the United States Department of the Interior, Bureau of Land Management or by a decree of a Court of Law and/or that the corner points mentioned in lines 3, 4 and 5 above were in conformance with the rules of the Michigan Board of Land Surveyors or by a Decree of a Court of Law; established, re-established, monumented, re-monumented, recovered, found as expressed below:

**NOTE: Not more than 4 corners, all in the same town and range, may be recorded on this certificate.**

A. Description of original monument and accessories and/or subsequent restoration:

- |     |      |              |            |                             |
|-----|------|--------------|------------|-----------------------------|
| H-9 | 1837 | GLO          | Whitcomb   | Set Post                    |
|     | 1961 | Kent Co. Wit |            | Mon. Box                    |
|     | 1972 | LCRC #247    | Spicer     | Mon. Box                    |
|     | 1982 | LCRC #2796   | Merdzinski | 1/2" Solid Iron in Mon. Box |

The position of this corner was previously approved by the Kent County Remonumentation Peer Group, monumented by John A. Merdzinski on 3/23/82 and was recorded per LCRC #2796

B. Description of corner evidence found and/or method applied in restoring or reestablishing corner:

H-9 Found standard Kent Co. Mon. (Harrison) per witnesses from above LCRC as set by John A. Merdzinski in place of the 1/2" Iron in Mon. Box he found. Said 1/2" Iron in Mon. Box checks with Kent Co. Wit. & LCRC #247.

LCRC #2796

- |                                 |       |        |
|---------------------------------|-------|--------|
| Top centerline of hydrant       | N40°E | 37.50' |
| SE cor. conc. sign base         | N50°W | 81.35' |
| Centerline crossing signal post | East  | 34.62' |
| Face conc. light pole           | S40°W | 48.80' |
| Face conc. light pole           | S35°E | 72.14' |

Centerline joint of Covell Ave. is 0.50' West of corner  
N. edge of W. bound Lake Michigan Dr. is 1.10' S. of corner

The selected location is accepted by me and is generally accepted by professional surveyors as the best available evidence of the position of the original corner.

C. Description of monument for corner and accessories established to perpetuate locating the position of the corner:

H-9 Standard Kent County Monument

- |                                 |       |        |
|---------------------------------|-------|--------|
| Top centerline of hydrant       | N40°E | 37.58' |
| SE cor. conc. sign base         | N50°W | 81.45' |
| Centerline crossing signal post | S90°E | 34.56' |
| Face conc. light pole           | S40°W | 48.89' |
| Face conc. light pole           | S35°E | 82.30' |

Centerline joint of Covell Ave. is 0.50' West of corner  
N. edge of W. bound Lake Michigan Dr. is 1.10' S. of corner

P.A. 345 1990 KENT COUNTY

PEER APPROVED 11/17/94

CHAIRMAN *Stanley Steben*

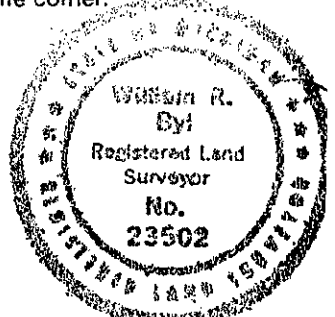

Signed by *W.R. Byl*  
Surveyor's Michigan License No. 23502

Date 11-17-94