

SURVEY & REMONUMENTATION

KENT COUNTY REMONUMENTATION

APR 28 1995

LAND CORNER RECORDATION CERTIFICATE
Filing Requirement of Act 74, Mich. P.A. 1970

STATE OF MICHIGAN
COUNTY OF KENT
RECEIVED FOR RECORD

94 NOV 28 AM 11:48

For corners in **COMMISSION**
KENT COUNTY

Lucy Bond
REG. OF DEEDS

(County)	Located In:	Corner Code #
1. Public Land Survey	T <u>7N</u> R <u>12W</u>	<u>I-7</u>
	T _____ R _____	_____
	T _____ R _____	_____
	T _____ R _____	_____
2. Property Controlling in Section	S _____ T _____ R _____	_____
	S _____ T _____ R _____	_____
3. Miscellaneous Property in Sec.	S _____ T _____ R _____	_____
	S _____ T _____ R _____	_____

7341
Register of Deeds Stamp & File Number

4. Lot No. _____, Recorded Plat _____
5. Private Claims _____

	A	B	C	D	E	F	G	H	I	J	K	L	M
2	6	5	4	3	2								
3													
4	7	8	9	10	11	12							
5													
6	18	17	16	15	14	13							
7													
8	19	20	21	22	23	24							
9													
10	30	29	28	27	26	25							
11													
12	31	32	33	34	35	36							
13													

I, William R. Byl, in a field survey on June 6, 1994, do hereby certify that under requirements of P.A. 74, Michigan P.A. of 1970, the corner points mentioned in lines 1 and 2 above were in conformance with regulations and rules therefore as required in the current manual of survey instructions of the United States Department of the Interior, Bureau of Land Management or by a decree of a Court of Law and/or that the corner points mentioned in lines 3, 4 and 5 above were in conformance with the rules of the Michigan Board of Land Surveyors or by a Decree of a Court of Law; established, re-established, monumented, re-monumented, recovered, found as expressed below:

NOTE: Not more than 4 corners, all in the same town and range, may be recorded on this certificate.

A. Description of original monument and accessories and/or subsequent restoration:

I-7	1837	GLO	Whitcomb	Set Post	P.A. 345 1990 KENT COUNTY
		City of Grand Rapids		City Iron	PEER APPROVED <u>11/17/94</u>
		Kent Co. Wit.		City Iron	CHAIRMAN <i>Harry Huber</i>
	1973	LCRC #499	Spicer	Boat Spike	
	1982	LCRC #2798	Merdzinski	Set "T" Iron encased in conc. over City Iron.	

The position of this corner was previously approved by the Kent County Remonumentation Peer Group, monumented by John A. Merdzinski on 3/25/82 and was recorded per LCRC #2798.

B. Description of corner evidence found and/or method applied in restoring or reestablishing corner:

I-7 Found "T" Iron encased in conc. per witnesses from above LCRC as set by John A. Merdzinski in place of the boat spike he found over a City Iron. Said "T" Iron checks with LCRC #499 & #2798.

LCRC #2798

NW cor. conc. fdn.	S20°W	63.05'	Face steel signal post	N60°W	79.75'
NE cor. brk. bldg.	S05°E	79.38'	C/L Walker Ave. running NW'yly	is 6.5' W.	
Top C/L hydr.	S60°E	93.03'	C/L Walker Ave. running SE'yly	is 25' W.	
Nail W. sd. 8" Spruce	N45°E	80.05'	C/L Leonard St. E-W	is 3.5' N.	
Nail E. sd. P. Pole	N20°W	51.85'			

The selected location is accepted by me and is generally accepted by professional surveyors as the best available evidence of the position of the original corner.

C. Description of monument for corner and accessories established to perpetuate locating the position of the corner:

I-7 "T" Iron encased in concrete over City Iron					
NW cor. conc. fdn.	S20°W	63.07'			
Top C/L hydr.	S60°E	92.95'			
New Nail & KC Remon. tag side 12" Spruce	N45°E	79.96'			
Face of steel signal post	N60°W	79.87'			
Set Nail & KC Remon. tag E. side P. Pole	N00°E	77.61'			
NE cor. fdn. of brick wing to bldg.	S05°E	49.23'			
C/L Walker Ave. running NW'yly	is 6.5' W.				
C/L Walker Ave. running SE'yly	is 25' W.				
C/L Leonard St. E-W	is N. 3.5'				

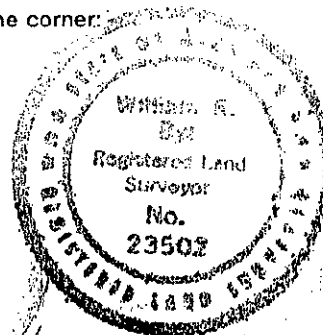

Signed by *W. R. Byl* Date 11-17-94
Surveyor's Michigan License No. 23502