

SURVEY & REMONUMENTATION

KENT COUNTY REMONUMENTATION

APR 28 1995

LAND CORNER RECORDATION CERTIFICATE
Filing Requirement of Act 74, Mich. P.A. 1970

STATE OF MICHIGAN
COUNTY OF KENT
RECEIVED FOR RECORD

94 NOV 28 AM 11:49

For corners in **COMMISSION**
KENT COUNTY

(County)	Located In:	Corner Code #
1. Public Land Survey	T <u>7N</u> R <u>12W</u>	<u>J-3</u>
	T _____ R _____	_____
	T _____ R _____	_____
	T _____ R _____	_____
2. Property Controlling in Section	S _____ T _____ R _____	_____
	S _____ T _____ R _____	_____
3. Miscellaneous Property in Sec.	S _____ T _____ R _____	_____
	S _____ T _____ R _____	_____

W. R. Byl
REG. OF DEEDS

7349

Register of Deeds Stamp & File Number

4. Lot No. _____, Recorded Plat _____
5. Private Claims _____

	A	B	C	D	E	F	G	H	I	J	K	L	M
2	6		5		4		3		2		1		
3										●			
4	7		8		9		10		11		12		
5													
6	16		17		18		15		14		13		
7													
8	19		20		21		22		23		24		
9													
10	30		29		28		27		26		25		
11													
12	31		32		33		34		35		36		
13													

I, William R. Byl, in a field survey on March 4, 19 94, do hereby certify that under requirements of P.A. 74, Michigan P.A. of 1970, the corner points mentioned in lines 1 and 2 above were in conformance with regulations and rules therefore as required in the current manual of survey instructions of the United States Department of the Interior, Bureau of Land Management or by a decree of a Court of Law and/or that the corner points mentioned in lines 3, 4 and 5 above were in conformance with the rules of the Michigan Board of Land Surveyors or by a Decree of a Court of Law; established, re-established, monumented, re-monumented, recovered, found as expressed below:

NOTE: Not more than 4 corners, all in the same town and range, may be recorded on this certificate.

A. Description of original monument and accessories and/or subsequent restoration:

J-3	1837	GLO	Whitcomb	Set Post	PEER APPROVED
	1949	Kent Co. Wit.		Mon. Box	<i>11/17/94</i>
	1978	LCRC #1188	Merdzinski	1" Iron in Mon. Box	<i>CHAIRMAN</i>
	1981	LCRC #1854	Tobin	Set Kent County Monument	<i>Harry Hulse</i>
	1991	LCRC #6186	McCloskey	Kent County Monument	

P.A. 345 1990 KENT COUNTY

The position of this corner was previously approved by the Kent County Remonumentation Peer Group, monumented by Douglas J. Tobin on 4/20/81 and was recorded per LCRC #1854

B. Description of corner evidence found and/or method applied in restoring or reestablishing corner:

J-3 Found standard Kent Co. Mon. (Harrison) per witnesses from above LCRC as set by Douglas J. Tobin in place of the 1" Iron he found in a Mon. Box. Said 1" Iron in Mon. Box checks with Kent Co. Wit. and LCRC #1188.

LCRC #1854		LCRC #6186	
NE cor. Hse. #1208 3 Mile	S20°W 91.50'	NE cor. hse. #1208 3 Mile	S20°W 91.50'
Nail & KC tag 12" Elm	N40°W 48.38'	Nail & Tag 26" Willow	N20°W 103.26'
Nail & KC tag 10" Elm	N25°E 65.15'	Nail & Tag guard rail post	N10°E 46.37'
Nail & KC tag 14" Oak	S70°E 95.83'	Nail & Tag 12" Maple	South 56.55'
		Nail & Tag guard rail post	N65°E 96.75'

The selected location is accepted by me and is generally accepted by professional surveyors as the best available evidence of the position of the original corner.

C. Description of monument for corner and accessories established to perpetuate locating the position of the corner:

J-3 Standard Kent County Monument			
NE cor. Hse. #1208 3 Mile (brick)	S20°W	91.50'	
Nail & tag E. side 26" Willow	N20°W	103.22'	
Nail & tag W. side of West end guard rail post	N10°E	46.43'	
New Nail & tag E. side 20" Maple	S00°E	56.55'	
Nail & tag S. side most E'ly side guard rail post	N65°E	96.72'	

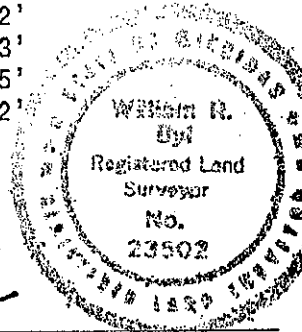

Signed by *W. R. Byl*
Surveyor's Michigan License No. 23502

Date 11-17-94