

KENT COUNTY REMONUMENTATION

JAN 24 1996

KENT COUNTY REMONUMENTATION

COMMISSION

LAND CORNER RECORDATION CERTIFICATE

Filing Requirement of Act 74, Mich. P.A. 1970

For corners in
KENT COUNTY
(County)

Located In:

Corner Code #

1. Public Land Survey	T	7N	R	12W	J-10
	T		R		
	T		R		
	T		R		
2. Property Controlling in Section	S		T	R	
	S		T	R	
3. Miscellaneous Property in Section	S		T	R	
	S		T	R	

4. Lot No. _____, Recorded Plat _____
 5. Private Claims _____

STATE OF MICHIGAN
 COUNTY OF KENT
 RECEIVED FOR RECORD
 95 DEC 26 PM 12:43
 REG. OF DEEDS
W. J. Stand

8860

Register of Deeds Stamp & File Number

A	B	C	D	E	F	G	H	I	J	K	L	M
2	6		5		4		3		2		1	
3												
4	7		8		9		10		11		12	
5												
6	13		17		16		15		14		13	
7												
8	19		20		21		22		23		24	
9												
10	30		29		28		27		26		25	
11												
12	31		32		33		34		35		36	
13												

I, Kirk Breitels, in a field survey on Dec. 15, 19 94, do hereby certify that under requirements of P.A. 74, Michigan P.A. of 1970, the corner points mentioned in lines 1 and 2 above were in conformance with regulations and rules therefore as required in the current manual of survey instructions of the United States Department of the Interior, Bureau of Land Management or by a decree of a Court of Law and/or that the corner points mentioned in lines 3, 4 and 5 above were in conformance with the rules of the Michigan Board of Professional Surveyors or by a Decree of a Court of Law; established, re-established, monumented, re-monumented, recovered, found as expressed below:

NOTE: Not more than 4 corners, all in the same town and range, may be recorded on this certificate.

A. Description of original monument and accessories and/or subsequent restoration:

J-10 1837 GLO Not Set
 City of Grand Rapids City Iron
 Cut on curb NW 40.77' Cut on curb NE 38.28' Cut on curb SE 40.52'
 Cut on curb SW 40.31' Bldg. cor. SW 58.33' Bldg. cor. SE 77.58'
 1990 Meyer, Bueche & Nies PK Nail
 SW cor. brick bldg. N20°E 74.45' SW cor. brick bldg. N65°E 85.35'
 NE cor. bldg. S25°W 63.15' NE cor. bldg. fdn. S55°W 87.50'
 C/L SE bolt Lt. Pole N35°W 63.43'

B. Description of corner evidence found and/or method applied in restoring or reestablishing corner:

J-10 Did not find anything at corner (road construction approx. 1993). No witnesses from City of Grand Rapids remain. Established corner from 1990 witnesses by Meyers, Bueche & Nies and found location to agree ± with street improvements, adjoining plats and previous City of Grand Rapids survey data. Said location is 0.1' E. & 0.2' N. from true intersection of 1/4 lines.

The location as described above is accepted by me and is generally accepted by professional surveyors as the best available evidence of the position of the corner.

P.A. 345 1990 KENT COUNTY
 PEER APPROVED 12/15/94
 CHAIRMAN *Harry Huber*

C. Description of monument for corner and accessories established to perpetuate locating the position of the corner:

J-10 Set Standard Kent County Monument at the location established in "B" above.
 SW corner of bldg. @ brick line N20°E 74.45'
 SW corner brick bldg. N65°E 85.42'
 NE corner of bldg. @ SE cor. of porch S25°W 63.15'
 NE corner bldg. foundation S55°W 87.50'
 C/L SE bolt in Lt. Pole N35°W 63.43'
 NE corner bottom step S30°W 52.94'
 Set Nail & KC Remon. tag NE side P. Pole S30°E 42.27'

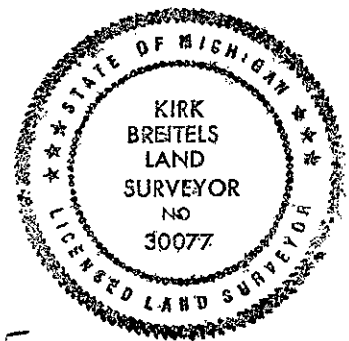

Signed by *Kirk Breitels*

Date 12/14/95

Surveyor's Michigan License No. 30077