

\$7.00
\$2.00

SURVEY &
REMONUMENTATION

MAR 08 1993

LAND CORNER RECORDATION CERTIFICATE
Filing Requirement of Act 74, Mich. P.A. 1970
KENT COUNTY REMONUMENTATION

For corners in

SECTION

Kent (County)	Located in: Grattan Township	Corner Code #
1. Public Land Survey	T <u>8N</u> R <u>9W</u>	<u>C-9</u>
	T _____ R _____	_____
	T _____ R _____	_____
	T _____ R _____	_____
2. Property Controlling in Section	S _____ T _____ R _____	_____
	S _____ T _____ R _____	_____
3. Miscellaneous Property in Sec.	S _____ T _____ R _____	_____
	S _____ T _____ R _____	_____

REG. OF DEEDS

Lucy Grand

98 OCT 23 AM 9:58

STATE OF MICHIGAN
COUNTY OF KENT
RECEIVED FOR RECORD

10837

Register of Deeds Stamp & File Number

- 4. Lot No. _____, Recorded Plat _____
- 5. Private Claims _____

I, Randy Kolehouse, in a field survey on February 2 19 98, do hereby certify that under requirements of P.A. 74 Michigan P.A. of 1970, the corner points mentioned in lines 1 and 2 above were in conformance with regulations and rules therefore as required in the current manual of survey instructions of the United States Department of the Interior, Bureau of Land Management or by a decree of a Court of Law and/or that the corner points mentioned in lines 3, 4 and 5 above were in conformance with the rules of the Michigan Board of Land Surveyors or by a Decree of a Court of Law; established, re-established, monumented, re-monumented, recovered, found as expressed below:

NOTE: Not more than 4 corners, all in the same town and range, may be recorded on this certificate.

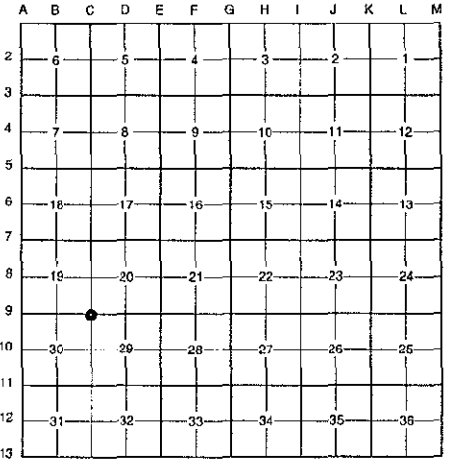

A. Description of original monument and accessories and/or subsequent restoration:

C-9	1837	G.L.O. Notes	Cathcart	Set Post
	1958	Witness Map	K.C. Surveyor	1/2" Iron Over Stone
	1879-1933	Records	Williams & Works	Leaded Stone - Set Iron - Conc. Mon. & Iron
	1974	L.C.R.C. #630	Williams & Works	3/4" Iron
	1985	L.C.R.C. #4219	R. Kolehouse	Fnd. 1" Crimped Iron / Set K.C. Monument
	1991	L.C.R.C. #5784	Prein & Newhof	K.C. Monument
	1994	L.C.R.C. #7991	Glaza & Associates	K.C. Monument

This corner was originally approved by the Kent County Remonumentation Peer Group and monumented by Randy Kolehouse on 5/11/85 and was recorded per L.C.R.C. #4219.

B. Description of corner evidence found and/or method applied in restoring or reestablishing corner:

C-9 Found a Standard Kent County Monument on the C/L of 6 Mile Road (gravel) running East and West, on line of tree row running North and South, per L.C.R.C.'s #4219, #5784 and #7991 as set by R. Kolehouse in place of a crimped iron he found which checked L.C.R.C. #630, the records of Williams & Works, and the K.C. Surveyor's records.

L.C.R.C. #4219

L.C.R.C. #7991

Nail & K.C. Remon. tag in E. side 18" Oak N 10° W 41.18'
 Nail & K.C. Remon. tag in NE side 8" Pine S 45° E 40.28'
 Nail & K.C. Remon. tag in N. side 12" Elm S 50° W 44.28'
 Nail & K.C. Remon. tag in S. side 12" Poplar N 65° W 51.25'

Nail & K.C. remon tag in E side 18" Oak N10°W 41.14' (m. 41.06')
 Nail & K.C. remon tag in NE side 8" Pine S45°E 40.18' (m. 40.20')
 Nail & K.C. remon tag in N side 16" Elm S50°W 44.28' (m. 44.27')
 Nail & K.C. remon tag in S side 14" Poplar N65°W 51.24' (m. 51.23')
 Nail & K.C. remon tag in SE side 16" Oak N20°E 57.24' (m. 57.23')

The selected location is accepted by me and is generally accepted by professional surveyors as the best available evidence of the position of the original corner.

C. Description of monument for corner and accessories established to perpetuate locating the position of the corner:

C-9 Standard Kent County Monument

Nail & K.C. remon. tag on E side 18" Oak N 10° W 41.06'
 Nail & K.C. remon. tag on NE side 8" Pine S 45° E 40.20'
 Nail & K.C. remon. tag on N side 16" Elm S 50° W 44.27'
 Nail & K.C. remon. tag on S side 14" Poplar N 65° W 51.23'
 Nail & K.C. remon. tag on SE side 16" Oak N 20° E 57.23'
 On C/L of gravel road running E-W
 On tree row running N-S

P.A. 345 1990 KENT COUNTY

PEER APPROVED *6/29/98*
CHAIRMAN *Randy Kolehouse*

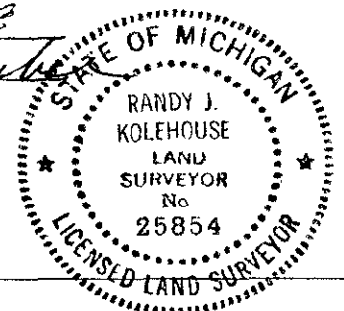

Signed by Randy J. Kolehouse

Date 9-1-98

Surveyor's Michigan License No. 25854