

\$7.00
\$2.00

SURVEY &
REMONUMENTATION

MAR 08 1999

LAND CORNER RECORDATION CERTIFICATE
Filing Requirement of Act 74, Mich. P.A. 1970
KENT COUNTY REMONUMENTATION

For corners in

Kent
(County)

SECTION

Located in: Grattan
Township

Corner Code #

- 1. Public Land Survey T 8N R 9W Corner Code # F-11
T _____ R _____
T _____ R _____
T _____ R _____
- 2. Property Controlling S _____ T _____ R _____
in Section S _____ T _____ R _____
- 3. Miscellaneous S _____ T _____ R _____
Property in Sec. S _____ T _____ R _____

- 4. Lot No. _____, Recorded Plat _____
- 5. Private Claims _____

REG. OF DEEDS

[Signature]

98 OCT 23 AM 9:59

STATE OF MICHIGAN
COUNTY OF KENT
RECEIVED FOR RECORD

10865

Register of Deeds Stamp & File Number

I, Randy Kolehouse, in a field survey on February 2 19 98, do hereby certify that under requirements of P.A. 74 Michigan P.A. of 1970, the corner points mentioned in lines 1 and 2 above were in conformance with regulations and rules therefore as required in the current manual of survey instructions of the United States Department of the interior, Bureau of Land Management or by a decree of a Court of Law and/or that the corner points mentioned in lines 3, 4 and 5 above were in conformance with the rules of the Michigan Board of Land Surveyors or by a Decree of a Court of Law; established, re-established, monumented, re-monumented, recovered, found as expressed below:

NOTE: Not more than 4 corners, all in the same town and range, may be recorded on this certificate.

A. Description of original monument and accessories and/or subsequent restoration:

F-11	1837	G.L.O. Notes	Cathcart	Set Post
	N/A	Witness Map	K.C. Surveyor	N/A
	1972	L.C.R.C. #330	Williams & Works	"T" Iron
	1981	L.C.R.C. #1883	Jonker Land Survey	Set K.C. Monument
	1994	L.C.R.C. #8031	Glaza & Associates	K.C. Monument

P.A. 345 1990 KENT COUNTY

PEER APPROVED 6/25/98

CHAIRMAN [Signature]

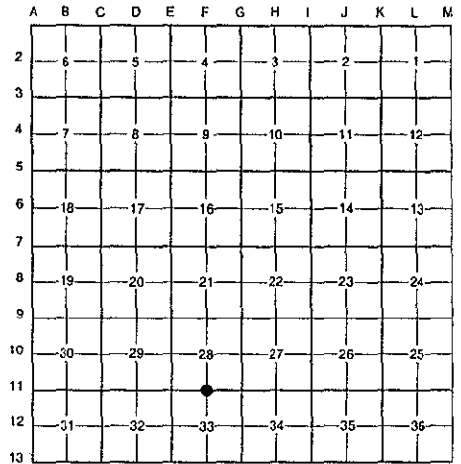

This corner was originally approved by the Kent County Remonumentation Peer Group and monumented by Rob Jonker on 6/5/81 and was recorded per L.C.R.C. #1883.

B. Description of corner evidence found and/or method applied in restoring or reestablishing corner:

F-11 Found a Standard Kent County Monument 75' South of the C/L of 5 Mile Road (bit.) running East and West per L.C.R.C.'s #1883 and #8031 as set by Rob Jonker using previous witnesses from L.C.R.C. #330 and the K.C. Surveyor's records.

L.C.R.C. #1883

L.C.R.C. #8031

Remon. tag on N. side P. Pole S83°W 158.55'

K.C. remon tag & nail in N side P. pole S78°W 158.51' (m. 158.55')
 K.C. remon tag & nail in NW side 9" Oak N68°E 56.84' (m. 56.82')
 K.C. remon tag & nail in N side 8" Oak S81°E 70.51' (m. 70.53')
 K.C. remon tag & nail in W side 7" Oak N08°W 24.33' (m. 24.35')
 C/L bit. Road N00°E 75.5'

The selected location is accepted by me and is generally accepted by professional surveyors as the best available evidence of the position of the original corner.

C. Description of monument for corner and accessories established to perpetuate locating the position of the corner:

F-11 Standard Kent County Monument

- Nail & K.C. remon. tag on N side P. pole S 78° W 158.55'
- Nail & K.C. remon. tag on NW side 10" Oak N 68° E 56.82'
- Nail & K.C. remon. tag on N side 8" Oak S 81° E 70.53'
- Nail & K.C. remon. tag on W side 8" Oak N 08° W 24.35'
- C/L of bit. road running E-W, North 75'

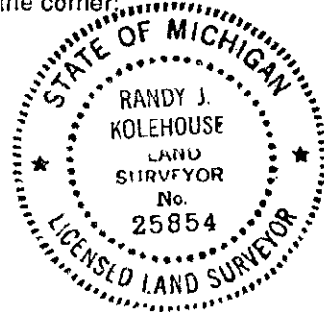

Signed by Randy J. Kolehouse
EARTH TECH

Date 9-1-98

Surveyor's Michigan License No. 25854