

SURVEY &
REMONUMENTATION

MAR 08 1999

LAND CORNER RECORDATION CERTIFICATE
Filing Requirement of Act 74, Mich. P.A. 1970
KENT COUNTY REMONUMENTATION

\$7.00
\$2.00

For corners in

SECTION

Kent (County)	Located in:	Grattan Township	Corner Code #
1. Public Land Survey	T <u>8N</u>	R <u>9W</u>	F-13
	T _____	R _____	_____
	T _____	R _____	_____
	T _____	R _____	_____
2. Property Controlling in Section	S _____	T _____	R _____
	S _____	T _____	R _____
3. Miscellaneous Property in Sec.	S _____	T _____	R _____
	S _____	T _____	R _____

STATE OF MICHIGAN
COUNTY OF KENT
RECEIVED FOR RECORD
38 DEC 14 AM 8:00
REG. OF DEEDS
[Signature]

10975
Register of Deeds Stamp & File Number

4. Lot No. _____, Recorded Plat _____
5. Private Claims _____

I, Randy Kolehouse, in a field survey on December 31 19 97, do hereby certify that under requirements of P.A. 74 Michigan P.A. of 1970, the corner points mentioned in lines 1 and 2 above were in conformance with regulations and rules therefore as required in the current manual of survey instructions of the United States Department of the interior, Bureau of Land Management or by a decree of a Court of Law and/or that the corner points mentioned in lines 3, 4 and 5 above were in conformance with the rules of the Michigan Board of Land Surveyors or by a Decree of a Court of Law; established, re-established, monumented, re-monumented, recovered, found as expressed below:

NOTE: Not more than 4 corners, all in the same town and range, may be recorded on this certificate.

A. Description of original monument and accessories and/or subsequent restoration:

F-13	1837	G.L.O. Notes	N. Brookfield	Set Post
	1941	Notes	Williams & Works	N/A
	1989	L.C.R.C. #5166	R. Kolehouse	Set K.C. Monument
	1994	L.C.R.C. #8032	Glaza & Associates	K.C. Monument

P.A. 345 1990 KENT COUNTY
PEER APPROVED 9/29/98
CHAIRMAN [Signature]

	A	B	C	D	E	F	G	H	I	J	K	L	M
2	6	5	4	3	2	1							
3													
4	7	8	9	10	11	12							
5													
6	18	17	16	15	14	13							
7													
8	19	20	21	22	23	24							
9													
10	30	29	28	27	26	25							
11													
12	31	32	33	34	35	36							
13													

Note: This corner is not common with F-1, T7N, R9W.

This corner was originally approved by the Kent County Remonumentation Peer Group and monumented by Randy J. Kolehouse on 11/23/85 and was recorded per L.C.R.C. #8032.

B. Description of corner evidence found and/or method applied in restoring or reestablishing corner:

F-13 Found a Standard Kent County Monument 0.2' South of a fence line running East and West and 90' West of the C/L of a causeway drive (bit.) running North and South per L.C.R.C.'s #5166 and #8032 as set by Randy Kolehouse midway between the Northwest and Northeast corner of Section 33 on the North line of "Horseshoe Plat at Murray Lake."

L.C.R.C. #5166

L.C.R.C. #8032

NE Cor. hse. S 75°W 30.89'
SE Cor. hse. S 60°W 58.81'
NW Cor. Brick Garage S 80°E 13.10'
Axle Shaft E 60.90'
K.C. Mon at N 1/4 Sec. 4 T7N R9W East 36.95'

NE corner house S75°W 30.88' (m. 30.85')
SE corner house S60°W 58.83' (m. 58.79')
K.C. mon at N 1/4 cor. Sec 4, T7N, R9W East 36.95'
Nail & K.C. remon tag in N side P. pole N90°E 68.21'

The selected location is accepted by me and is generally accepted by professional surveyors as the best available evidence of the position of the original corner.

C. Description of monument for corner and accessories established to perpetuate locating the position of the corner:

F-13 Standard Kent County Monument
NE cor. brick hse. (#3597) S 75° W 30.85'
SE cor. brick hse. (#3597) S 60° W 58.79'
NW cor. brick garage S 80° E 13.13'
Nail & K.C. remon. tag on N face Util. Pole N 90° E 68.21'
C/L of causeway drive (bit.) running N-S, East 90'
Fence line running E-W, North 0.2'
K.C. Mon., F-1, T7N, R9W, East 36.95'

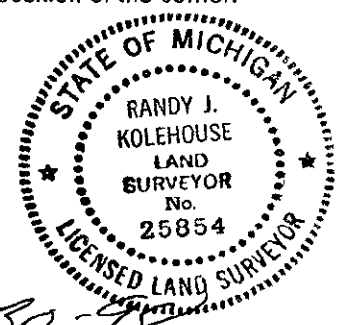

Signed by Randy J. Kolehouse Date 9-30-98
EARTH TECH

Surveyor's Michigan License No. 25854