

~~\$7.00~~
~~\$2.00~~
 SURVEY
 MAR 08 1999

LAND CORNER RECORDATION CERTIFICATE
Filing Requirement of Act 74, Mich. P.A. 1970
KENT COUNTY REMONUMENTATION

For corners in SECTION
Kent
 (County)

Located in: Grattan Township
 Corner Code #
 1. Public Land Survey T 8N R 9W G-1
 T _____ R _____
 T _____ R _____
 T _____ R _____
 2. Property Controlling S _____ T _____ R _____
 in Section S _____ T _____ R _____
 3. Miscellaneous S _____ T _____ R _____
 Property in Sec. S _____ T _____ R _____

REG. OF DEEDS
 38 OCT 23 AM 9:59
 STATE OF MICHIGAN
 COUNTY OF KENT
 RECEIVED FOR RECORD

10866
 Register of Deeds Stamp & File Number

4. Lot No. _____, Recorded Plat _____
 5. Private Claims _____

I, Randy Kolehouse, in a field survey on March 19 19 98, do hereby certify that under requirements of P.A. 74 Michigan P.A. of 1970, the corner points mentioned in lines 1 and 2 above were in conformance with regulations and rules therefore as required in the current manual of survey instructions of the United States Department of the interior, Bureau of Land Management or by a decree of a Court of Law and/or that the corner points mentioned in lines 3, 4 and 5 above were in conformance with the rules of the Michigan Board of Land Surveyors or by a Decree of a Court of Law; established, re-established, monumented, re-monumented, recovered, found as expressed below:

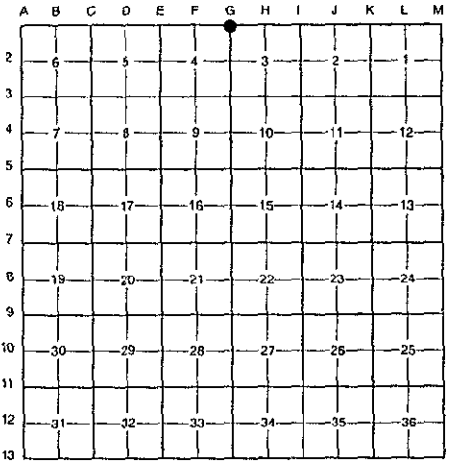

NOTE: Not more than 4 corners, all in the same town and range, may be recorded on this certificate.

A. Description of original monument and accessories and/or subsequent restoration:

G-1	1837	G.L.O. Notes	Cathcart	Set Post
	1909-1981	Notes	Williams & Works	Iron - K.C. Monument
	1985	L.C.R.C. #4114	William Byl	Set K.C. Monument
	1989	L.C.R.C. #5219	John Bueche	K.C. Monument

P.A. 345 1990 KENT COUNTY
 PEER APPROVED 6/25/98
 CHAIRMAN [Signature]

Note: This corner is not common with G-13, T9N, R9W.

This corner was originally approved by the Kent County Remonumentation Peer Group and monumented by William Byl on 11/5/84 and was recorded per L.C.R.C. #4114.

B. Description of corner evidence found and/or method applied in restoring or reestablishing corner:

G-1	Found a Standard Kent County Monument on occupation line running East and West, on line of a tree row running South, per L.C.R.C.'s #4114 and #5219 as set by William Byl 204.60' West of the Southeast corner of Section 33 and on the South line of Section 33 using notes from Williams & Works.	
	L.C.R.C. #4114	L.C.R.C. #5219
	Nail & tag, W sd. 24" quad. Boxelder S 10° W 53.27'	Remon. Tag & Nail in W side 24" quad. Boxelder S 10° W 53.14' (m. 53.15')
		Remon. Tag & Nail in W side 8" Elm S 20° W 20.97' (m. 20.98')
		Remon. Tag & Nail in W side 16" Boxelder N 65° E 228.57' (m. 228.54')
		K.C. Mon. (G-13, 9-9) N 90° E 204.60'

The selected location is accepted by me and is generally accepted by professional surveyors as the best available evidence of the position of the original corner.

C. Description of monument for corner and accessories established to perpetuate locating the position of the corner:

G-1 Standard Kent County Monument

- Nail & K.C. remon. tag on W side 24" quad. Boxelder S 10° W 53.15'
- Nail & K.C. remon. tag on W side 8" Elm S 20° W 20.98'
- Nail & K.C. remon. tag on W side 16" Boxelder N 65° E 228.54'
- K.C. Mon., G-13, T9N, R9W, N 90° E 204.60'
- On occupation line running E-W
- On tree row running S

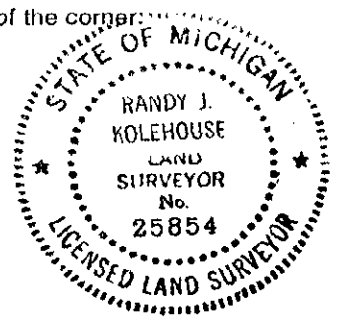

Signed by Randy J. Kolehouse Date 9-1-98
 EARTH TECH
 Surveyor's Michigan License No. 25854