

SURVEY & REMONUMENTATION

\$7.00
\$2.00

MAR 08 1999

LAND CORNER RECORDATION CERTIFICATE
Filing Requirement of Act 74, Mich. P.A. 1970
KENT COUNTY REMONUMENTATION

For corners in

SECTION	Located in:	Grattan Township	Corner Code #
Kent (County)			
1. Public Land Survey	T <u>8N</u> R <u>9W</u>		<u>G-5</u>
	T _____ R _____		_____
	T _____ R _____		_____
	T _____ R _____		_____
2. Property Controlling in Section	S _____ T _____ R _____		_____
	S _____ T _____ R _____		_____
3. Miscellaneous Property in Sec.	S _____ T _____ R _____		_____
	S _____ T _____ R _____		_____

REG. OF DEEDS

Tom Standa

38 OCT 23 AM 9:59

STATE OF MICHIGAN
COUNTY OF KENT
RECEIVED FOR RECORD

10870

Register of Deeds Stamp & File Number

4. Lot No. _____, Recorded Plat _____
5. Private Claims _____

I, Randy Kolehouse, in a field survey on March 13 19 98, do hereby certify that under requirements of P.A. 74 Michigan P.A. of 1970, the corner points mentioned in lines 1 and 2 above were in conformance with regulations and rules therefore as required in the current manual of survey instructions of the United States Department of the Interior, Bureau of Land Management or by a decree of a Court of Law and/or that the corner points mentioned in lines 3, 4 and 5 above were in conformance with the rules of the Michigan Board of Land Surveyors or by a Decree of a Court of Law; established, re-established, monumented, re-monumented, recovered, found as expressed below:

NOTE: Not more than 4 corners, all in the same town and range, may be recorded on this certificate.

A. Description of original monument and accessories and/or subsequent restoration:

G-5	1837	G.L.O. Notes	Cathcart	Set Post
	1935	Witness Map	K.C. Surveyor	Concrete Monument
	1973	L.C.R.C. #543	Williams & Works	Concrete Monument
	1981	L.C.R.C. #1884	Jonker Land Survey	Fnd. Concrete Plat Monument / Set K.C. Monument
	1994	L.C.R.C. #8036	Glaza & Associates	K.C. Monument

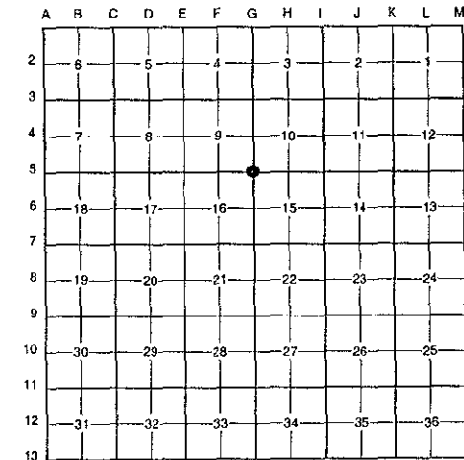

P.A. 345 1990 KENT COUNTY

PEER APPROVED 6/25/98

CHAIRMAN *[Signature]*

This corner was originally approved by the Kent County Remonumentation Peer Group and monumented by Rob Jonker on 6/3/81 and was recorded per L.C.R.C. #1884.

B. Description of corner evidence found and/or method applied in restoring or reestablishing corner:

G-5 Found a Standard Kent County Monument on occupation line running North and South, on a tree row running East, per L.C.R.C.'s #1884 and #8036 as set by Rob Jonker in place of a concrete plat monument he found which checked L.C.R.C. #543 and the K.C. Surveyor's records.

L.C.R.C. #1884

Remon. tag on N side 6" W.Ch. East 89.90'

L.C.R.C. #8036

K.C. remon tag & nail in SE side 4" Tree S40°W 34.53' (m. 34.5')
Face of metal fence post N90°W 1.1' (m. 1.09')

The selected location is accepted by me and is generally accepted by professional surveyors as the best available evidence of the position of the original corner.

C. Description of monument for corner and accessories established to perpetuate locating the position of the corner:

G-5 Standard Kent County Monument

- Nail & K.C. remon. tag on SE side 4" Tree S 40° W 34.50'
- Nail & K.C. remon. tag on N side 8" W. Cherry (dead) East 89.87'
- Face metal fence post N 90° W 1.09'
- On occupation line running N-S
- On tree row running E

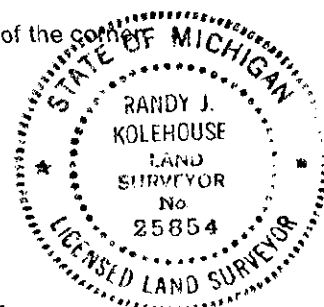

Signed by *Randy J. Kolehouse* Date 9-1-98

EARTH TECH

Surveyor's Michigan License No. 25854