

**SURVEY & REMONUMENTATION**

\$7.00  
\$2.00

MAR 08 1999

**LAND CORNER RECORDATION CERTIFICATE**  
**Filing Requirement of Act 74, Mich. P.A. 1970**  
**KENT COUNTY REMONUMENTATION**

For corners in

SECTION	Located in:		Corner Code #
	Kent (County)	Grattan Township	
1. Public Land Survey	T <u>8N</u>	R <u>9W</u>	<u>H-1</u>
	T _____	R _____	_____
	T _____	R _____	_____
	T _____	R _____	_____
2. Property Controlling in Section	S _____	R _____	_____
	S _____	R _____	_____
3. Miscellaneous Property in Sec.	S _____	R _____	_____
	S _____	R _____	_____

REG. OF DEEDS  
*Lucy St. Grand*

STATE OF MICHIGAN  
COUNTY OF KENT  
RECEIVED FOR RECORD  
38 DEC 14 AM 8:00

**10977**

Register of Deeds Stamp & File Number

4. Lot No. \_\_\_\_\_, Recorded Plat \_\_\_\_\_  
 5. Private Claims \_\_\_\_\_

I, Randy Kolehouse, in a field survey on January 28 19 98, do hereby certify that under requirements of P.A. 74 Michigan P.A. of 1970, the corner points mentioned in lines 1 and 2 above were in conformance with regulations and rules therefore as required in the current manual of survey instructions of the United States Department of the interior, Bureau of Land Management or by a decree of a Court of Law and/or that the corner points mentioned in lines 3, 4 and 5 above were in conformance with the rules of the Michigan Board of Land Surveyors or by a Decree of a Court of Law; established, re-established, monumented, re-monumented, recovered, found as expressed below:

**NOTE: Not more than 4 corners, all in the same town and range, may be recorded on this certificate.**

- A. Description of original monument and accessories and/or subsequent restoration:  
 H-1 This corner was not originally set by the G.L.O.  
 1965-77 Witness Map K.C. Surveyor Boat Spike  
 1983 L.C.R.C. #3329 Glaza & Associates "T" Iron (H-13, T9N, R9W)  
 1985 L.C.R.C. #4115 William Byl Fnd. Boat Spike / Set K.C. Monument  
 1994 L.C.R.C. #7208 Glaza & Associates K.C. Monument

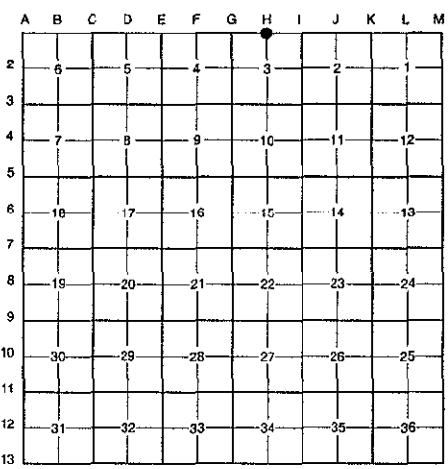

P.A. 345 1990 KENT COUNTY  
 PEER APPROVED 9/20/98  
 CHAIRMAN Randy Kolehouse

Note: This corner is not common with H-13, T9N, R9W.

This corner was originally approved by the Kent County Remonumentation Peer Group and monumented by William Byl on 11/5/84 and was recorded per L.C.R.C. #4115.

- B. Description of corner evidence found and/or method applied in restoring or reestablishing corner:  
 H-1 Found a Standard Kent County Monument on the C/L of McArthur (gravel) running North and South, on line of a fence line running East and West, per L.C.R.C.'s #4115 and #7208 as set by William Byl in place of a boat spike he found which checked the K.C. Surveyor's records.

L.C.R.C. #4115	L.C.R.C. #7208
Nail & tag, W sd. 24" Hickory S 10 E 96.57'	Nail & K.C. remon tag in W side 24" Hickory S10°E 96.57' (m. 96.64')
Nail & tag, W sd. Power pole S 35 W 100.15'	Nail & K.C. remon tag in W side P. pole S35°W 100.15' (m. 100.27')
Nail & tag, E sd. 24" hickory N 10 W 75.20'	Nail & K.C. remon tag in E side 24" Hickory N10°W 75.25'
Capped iron pipe (#9548) N 90 E 30.95'	Capped iron pipe (#9548) N90°E 30.95' (m. 33.15')
	Iron pipe N90°W 32.89' (m. 32.92')
	In C/L of N-S gravel road +/-
	Kent Co Mon (S 1/4 cor, Sec 34, T9N, R9W) N90°E 170.68'

The selected location is accepted by me and is generally accepted by professional surveyors as the best available evidence of the position of the original corner.

- C. Description of monument for corner and accessories established to perpetuate locating the position of the corner:  
 H-1 Standard Kent County Monument  
 Nail & K.C. remon. tag on W side 24" Hickory S 10° E 96.64'  
 Nail & K.C. remon. tag on W side P. pole S 35° W 100.27'  
 Nail & K.C. remon. tag on E side 24" Hickory N 10° W 75.25'  
 Capped iron pipe N 90° E 33.15'  
 K.C. Mon., H-13, T9N, R9W, N 90° E 170.68'

Iron pipe N 90° W 32.92'  
 On C/L of gravel road running NS  
 On fence line running E-W

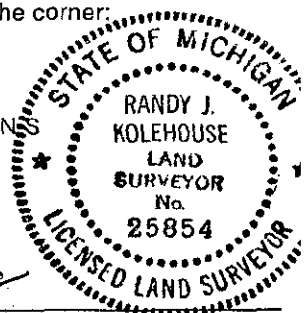

Signed by Randy J. Kolehouse  
 EARTH TECH

Date 9-30-98

Surveyor's Michigan License No. 25854