

SURVEY & REMONUMENTATION

\$7.00
\$2.00

MAR 08 1999

LAND CORNER RECORDATION CERTIFICATE
Filing Requirement of Act 74, Mich. P.A. 1970
KENT COUNTY REMONUMENTATION

STATE OF MICHIGAN
COUNTY OF KENT
RECEIVED FOR RECORD
98 DEC 14 AM 8:00
REG. OF DEEDS
Lucy St. Paul

For corners in

SECTION

Kent (County)	Located in:	Grattan Township	Corner Code #
1. Public Land Survey	T 8N	R 9W	I-12
	T	R	
	T	R	
	T	R	
2. Property Controlling in Section	S	T	R
	S	T	R
3. Miscellaneous Property in Sec.	S	T	R
	S	T	R

10987

Register of Deeds Stamp & File Number

4. Lot No. _____, Recorded Plat _____
5. Private Claims _____

I, Randy Kolehouse, in a field survey on February 9 19 98, do hereby certify that under requirements of P.A. 74 Michigan P.A. of 1970, the corner points mentioned in lines 1 and 2 above were in conformance with regulations and rules therefore as required in the current manual of survey instructions of the United States Department of the interior, Bureau of Land Management or by a decree of a Court of Law and/or that the corner points mentioned in lines 3, 4 and 5 above were in conformance with the rules of the Michigan Board of Land Surveyors or by a Decree of a Court of Law; established, re-established, monumented, re-monumented, recovered, found as expressed below:

	A	B	C	D	E	F	G	H	I	J	K	L	N
2	6		5		4		3		2		1		
3													
4	7		8		9		10		11		12		
5													
6	18		17		16		15		14		13		
7													
8	19		20		21		22		23		24		
9													
10	30		29		28		27		26		25		
11													
12	31		32		33		34		35		36		
13													

NOTE: Not more than 4 corners, all in the same town and range, may be recorded on this certificate.

A. Description of original monument and accessories and/or subsequent restoration:

I-12	1837	G.L.O. Notes	Cathcart	Set Post
	1944	Witness Map	K.C. Surveyor	1" Iron
	1991	L.C.R.C. #5750	K. Roosien	Fnd. 1" Iron / Set K.C. Mon. in Mon. Box

This corner was originally approved by the Kent County Remonumentation Peer Group and monumented by K. Roosien and was recorded per L.C.R.C. #5750.

B. Description of corner evidence found and/or method applied in restoring or reestablishing corner:

I-12 Found a Standard Kent County Monument in a monument box on the C/L of Lincoln Lake Road (bit.) running North and South, on line of a tree row running West, per L.C.R.C. #5750 as set by Kevin Roosien in place of a 1" iron he found in a monumet box.

L.C.R.C. #5750

- Nail in K.C. tag in S. side Power Pole N85°W 64.01' (m. 63.95')
- Nail in K.C. tag in N. side 8" Poplar S45°E 71.15' (m. 71.10')
- Nail in K.C. tag in N. side 6" Poplar S70°E 98.56' (m. 98.50')
- Nail in K.C. tag in N. side 18" Quad. Beech N75°E 156.28' (m. 156.10')
- "X" in top, N. end concrete culvert N50°W 40.27' (m. 40.30')

P.A. 345 1990 KENT COUNTY
PEER APPROVED 9/29/98
CHAIRMAN Frank Huber

The selected location is accepted by me and is generally accepted by professional surveyors as the best available evidence of the position of the original corner.

C. Description of monument for corner and accessories established to perpetuate locating the position of the corner:

I-12 Standard Kent County Monument in a Monument Box

- Nail & K.C. remon. tag on S side P. pole N 85° W 63.95'
- Nail & K.C. remon. tag on N side 14" Poplar S 45° E 71.10'
- Nail & K.C. remon. tag on N side 12" Poplar S 70° E 98.50'
- Nail & K.C. remon. tag on N side twin 20" Beech N 75° E 156.10'
- "X" in top S end conc. culv. N 50° W 40.30'
- "X" in top S. end conc. culv. N 25° E 114.48'
- Nail & K.C. remon. tag on NE side P. pole N 40° W 86.64'

On C/L of bit. road running N-S
On tree row running W

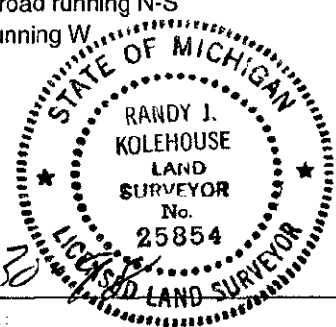

Signed by Randy J. Kolehouse Date 9-30
EARTH TECH

Surveyor's Michigan License No. 25854