

FEB 14 1997

COMMISSION

KENT COUNTY REMONUMENTATION

LAND CORNER RECORDATION CERTIFICATE
Filing Requirement of Act 74, Mich. P.A. 1970

For corners in

KENT COUNTY

(County)

Located in:
#

Corner Code #

1. Public Land Survey

T-8N R-11W M-6

T-8N R-10W A-6

T- R-

T- R-

2. Property Controlling in Section

S- T- R-

S- T- R-

3. Miscellaneous Property in Sec.

S- T- R-

S- T- R-

4. Lot No. _____, Recorded Plat _____

5. Private Claims _____

I, Kirk Breitels, in a field survey on Jan. 22, 1996 do hereby state that under requirements of P.A. 74, Michigan P.A. of 1970, the corner points mentioned in lines 1 and 2 above were in conformance with regulations and rules therefore as required in the current manual of survey instructions of the United States Department of the Interior, Bureau of Land Management or by a decree of a Court of Law and/or that the corner points mentioned in lines 3, 4 and 5 above were in conformance with the rules of the Michigan Board of Land Surveyors or by a Decree of a Court of Law; established, re-established, monumented, recovered, found as expressed below:

NOTE: Not more than 2 corners, all in the same town and range, may be recorded on this certificate.

STATE OF MICHIGAN
COUNTY OF KENT
RECEIVED FOR RECORD

96 MAR 20 AM 8:59

REG. OF DEEDS

Lucy St. Paul

9123

Register of Deeds Stamp & File Number

A	B	C	D	E	F	G	H	I	J	K	L	M
1												
2	6	5	4	3	2	1						
3												
4	7	8	9	10	11	12						
5												
6	18	17	16	15	14	13						
7												
8	19	20	21	22	23	24						
9												
10	30	29	28	27	26	25						
11												
12	31	32	33	34	35	36						
13												

A. Description of original monument and accessories and/or subsequent restoration:

M-6	1837	GLO	Brookfield	Set Post
	1963	Kent Co. Wit.		Mon. Box
	1983	LCRC #3280	Hay	Set Kent County Monument in Mon. Box
	1988	LCRC #4886	Bueche	Kent County Monument

P.A. 345 1990 KENT COUNTY

PEER APPROVED 3/7/96

CHAIRMAN *Darryl Hubert*

The position of this corner was previously approved by the Kent County Remonumentation Peer Group, monumented by Clayton S. Hay on 2/11/83 and was recorded per LCRC #3280

B. Description of corner evidence found and/or method applied in restoring or reestablishing corner:

M-6 Found standard Kent Co. Mon. (Harrison) per witnesses from above LCRC as set by Clayton S. Hay in place of the 3/4" Iron he found inside a Mon. Box. Said Iron checks with Kent Co. Wit.

LCRC #3280 & #4886

Nail & KC Remon. tag N. side P. Pole	East	24.22'	SW cor. hse. fnd. (block)
Nail & KC Remon. tag N. side Guy Pole	West	24.77'	N57°E 98.10'
Nail & KC Remon. tag S. side 24" Oak	N68°E	49.84'	
Nail & KC Remon. tag NE side 8" Oak	N59°W	39.82'	
Nail & KC Remon. tag E. side 7" Oak	N17°W	82.40'	

The selected location is accepted by me and is generally accepted by professional surveyors as the best available evidence of the position of the original corner.

C. Description of monument for corner and accessories established to perpetuate locating the position of the corner:

M-6 Standard Kent County Monument in Mon. Box			
Nail & KC Remon. tag N. side P. Pole	East	24.31'	
Nail & KC Remon. tag N. side Guy Pole	West	24.68'	
New Nail & KC Remon. tag S. side 36" Oak	N68°E	49.88'	
New Nail & KC Remon. tag NE side 10" Oak	N59°W	39.85'	
New Nail & KC Remon. tag E. side 12" Oak	N17°W	82.38'	
SW cor. hse. fnd. (block)	N57°E	98.07'	

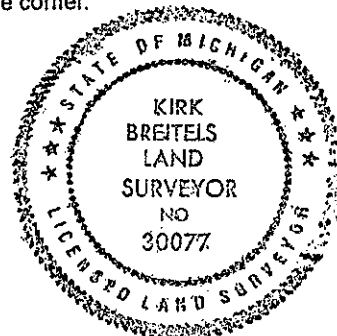

Signed by *Kirk Breitels*

Surveyor's Michigan License No. 30077

Date 2/6/96