

**SURVEY & REMONUMENTATION**

FEB 14 1997

**KENT COUNTY REMONUMENTATION**

**COMMISSION**

**LAND CORNER RECORDATION CERTIFICATE**  
Filing Requirement of Act 74, Mich. P.A. 1970

For corners in

KENT COUNTY  
(County)

Located In:  
#

Corner Code #

- 1. Public Land Survey T 8N R 11W M-8  
T 8N R 10W A-8
- 2. Property Controlling in Section T \_\_\_ R \_\_\_
- 3. Miscellaneous Property in Sec. S \_\_\_ T \_\_\_ R \_\_\_

STATE OF MICHIGAN  
 COUNTY OF KENT  
 RECEIVED FOR RECORD  
 96 MAR 20 AM 9:00  
 REG. OF DEEDS  
*Luis Bond*

**9125**

Register of Deeds Stamp & File Number

- 4. Lot No. \_\_\_\_\_, Recorded Plat \_\_\_\_\_
- 5. Private Claims \_\_\_\_\_

I, Kirk Breitels, in a field survey on Jan. 23, 1996 do hereby state that under requirements of P.A. 74, Michigan P.A. of 1970, the corner points mentioned in lines 1 and 2 above were in conformance with regulations and rules therefore as required in the current manual of survey instructions of the United States Department of the Interior, Bureau of Land Management or by a decree of a Court of Law and/or that the corner points mentioned in lines 3, 4 and 5 above were in conformance with the rules of the Michigan Board of Land Surveyors or by a Decree of a Court of Law; established, re-established, monumented, recovered, found as expressed below:

NOTE: Not more than 2 corners, all in the same town and range, may be recorded on this certificate.

P.A. 3.5 1990 KENT COUNTY  
 PEER APPROVED 3/7/96  
 CHAIRMAN *[Signature]*

1	A	B	C	D	E	F	G	H	I	J	K	L	M
2		6		5		4		3		2		1	
3													
4		7		8		9		10		11		12	
5													
6		10		17		16		15		14		13	
7													
8		19		20		21		22		23		24	
9													
10		30		29		28		27		26		25	
11													
12		31		32		33		34		35		36	
13													

A. Description of original monument and accessories and/or subsequent restoration:

M-8	1837	GLO	Brookfield	Set Post
		Kent Co. Wit.		Stake - 1 1/2" Iron
	1976	LCRC #965	Bonnema	1 1/2" Iron
	1981	LCRC #1979	Jonker	Set Kent County Monument
	1988	LCRC #4888	Bueche	Kent County Monument

The position of this corner was previously approved by the Kent County Remonumentation Peer Group, monumented by Robert J. Jonker on 10/20/81 and was recorded per LCRC #1979.

B. Description of corner evidence found and/or method applied in restoring or reestablishing corner:

M-8 Found standard Kent Co. Mon. (Harrison) per witnesses from above LCRC as set by Robert J. Jonker in place of the 1 1/2" Iron he found. Said Iron checks with Kent Co. Wit. and LCRC #965  
LCRC #1979 & #4888

- Nail & KC Remon. tag N. side 18" Oak N85°W 13.53' 1" Iron S70°E 0.90'
- Nail & KC Remon. tag E. side 12" Oak N12°W 3.09'
- Nail & KC Remon. tag N. side 10" Oak S70°E 8.52'
- Nail & KC Remon. tag W. side 10" Oak S37°W 22.50'

40'± S. fo crest E-W ridge, 15'± W. of N-S trail, 150'± NE'ly of Hse. #5544

The selected location is accepted by me and is generally accepted by professional surveyors as the best available evidence of the position of the original corner.

C. Description of monument for corner and accessories established to perpetuate locating the position of the corner:

M-8 Standard Kent County Monument

- New Nail & KC Remon. tag N. side 20" Oak N85°W 13.50'
- New Nail & KC Remon. tag E. side 16" Oak N12°W 3.22'
- New Nail & KC Remon. tag N. side 14" Oak S70°E 8.60'
- New Nail & KC Remon. tag W. side 14" Oak S37°W 22.50'
- 1" Iron - S70°E - 0.90'
- 40'± S. fo crest E-W ridge
- 15'± W. of N-S trail
- 150'± NE'ly of Hse. #5544

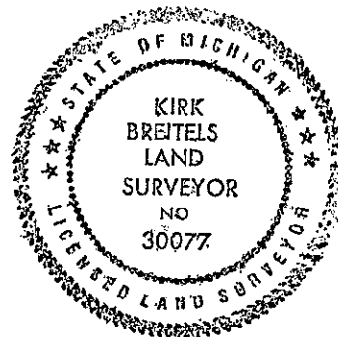

Signed by *[Signature]*  
 Surveyor's Michigan License No. 30077

Date 2/6/96