

SURVEY & REMONUMENTATION

MAR 03 1998

SECTION

LAND CORNER RECORDATION CERTIFICATE
Filing Requirement of Act 74, Mich. P.A. 1970
KENT COUNTY REMONUMENTATION

For corners in

Kent (County)	Located in: Cannon Township	Corner Code #
1. Public Land Survey	T <u>8N</u> R <u>10W</u>	<u>F-5</u>
	T _____ R _____	_____
	T _____ R _____	_____
	T _____ R _____	_____
2. Property Controlling in Section	S _____ T _____ R _____	_____
	S _____ T _____ R _____	_____
3. Miscellaneous Property in Sec.	S _____ T _____ R _____	_____
	S _____ T _____ R _____	_____

STATE OF MICHIGAN
 COUNTY OF KENT
 RECEIVED FOR RECORD

97 OCT 15 AM 8:45

REG. OF DEEDS
Lucy Bond

10110

Register of Deeds Stamp & File Number

4. Lot No. _____, Recorded Plat _____
 5. Private Claims _____

I, Randy Kolehouse, in a field survey on June 12 19 97, do hereby certify that under requirements of P.A. 74 Michigan P.A. of 1970, the corner points mentioned in lines 1 and 2 above were in conformance with regulations and rules therefore as required in the current manual of survey instructions of the United States Department of the interior, Bureau of Land Management or by a decree of a Court of Law and/or that the corner points mentioned in lines 3, 4 and 5 above were in conformance with the rules of the Michigan Board of Land Surveyors or by a Decree of a Court of Law; established, re-established, monumented, re-monumented, recovered, found as expressed below:

NOTE: Not more than 4 corners, all in the same town and range, may be recorded on this certificate.

A. Description of original monument and accessories and/or subsequent restoration:

F-5	1831	G.L.O. Notes	Mullett	Set Post
	1930-63	Witness Map	K.C. Surveyor	Iron in Monument Box
	1971	L.C.R.C. #69	Williams & Works	Iron in Monument Box
	1972	L.C.R.C. #395	Williams & Works	1/2" Iron in Monument Box
	1981	L.C.R.C. #2431	Jonker Land Surveys	Fnd. 1/2" Iron in Mon. Box / Set K.C. Monument in Mon. Box
	1992	L.C.R.C. #6304	Chris Marschall	K.C. Monument

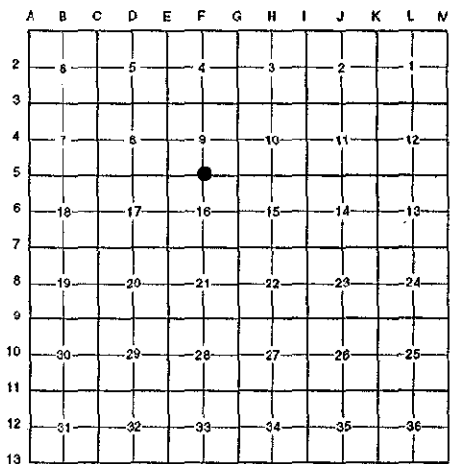

This corner was originally approved by the Kent County Remonumentation Peer Group and monumented by Rob Jonker on 11/24/81 and was recorded per L.C.R.C. #2431.

B. Description of corner evidence found and/or method applied in restoring or reestablishing corner:

F-5 Found a Standard Kent County Monument (top missing) in a monument box at the C/L intersection of Belding Road (bit.) running East and West and Myers Lake Avenue (bit.) running North and South per L.C.R.C.'s #2431 and #6304 as set by Rob Jonker in place of a 1/2" iron he found in a monument box 0.12' East of C/L of monument box over stones 15" below grade which checked L.C.R.C.'s #395, #69 and the K.C. Surveyor's records.

L.C.R.C. #2461

L.C.R.C. #6304

Remon. tag on NE side p. pole S28°E 61.11'
 Remon. tag on S side T. pole N60°W 97.43'
 C/L M.H. S09°E 34.87'

Nail & Tag S sd. U.P. N 63 W 97.32'
 Nail & Tag NW sd. 18" Spruce S 48 W 83.24'
 Nail & Tag W sd. U.P. S 31 E 61.02'

The selected location is accepted by me and is generally accepted by professional surveyors as the best available evidence of the position of the original corner.

C. Description of monument for corner and accessories established to perpetuate locating the position of the corner:

F-5 Replaced Standard Kent County Monument in a Monument Box
 Nail & K.C. remon. tag on S side Util. pole N 63° W 97.32'
 Nail & K.C. remon. tag on NW side 18" Spruce S 48° W 83.24'
 Nail & K.C. remon. tag on W side Util. pole S 31° E 61.02'
 C/L M.H. S 09° E 34.87'

P.A. 345 1990 KENT COUNTY
 PEER APPROVED 6/26/97
 CHAIRMAN *Harry Ruben*

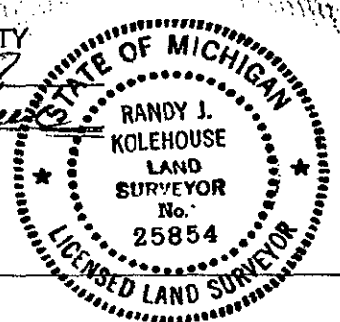

Signed by *Randy J. Kolehouse*
 EARTH TECH

Date 6/12/97

Surveyor's Michigan License No. 25854