

MAR 03 1998

SECTION

LAND CORNER RECORDATION CERTIFICATE
Filing Requirement of Act 74, Mich. P.A. 1970
KENT COUNTY REMONUMENTATION

For corners in

Table with columns: Kent (County), Located in: Cannon Township, Corner Code #. Rows include Public Land Survey, Property Controlling in Section, and Miscellaneous Property in Sec.

STATE OF MICHIGAN
COUNTY OF KENT
RECEIVED FOR RECORD
97 OCT 15 AM 8:47
REG. OF DEEDS

10134

Register of Deeds Stamp & File Number

- 4. Lot No. , Recorded Plat
5. Private Claims

I, Randy Kolehouse, in a field survey on June 19 19 97, do hereby certify that under requirements of P.A. 74 Michigan P.A. of 1970, the corner points mentioned in lines 1 and 2 above were in conformance with regulations and rules therefore as required in the current manual of survey instructions of the United States Department of the interior, Bureau of Land Management or by a decree of a Court of Law and/or that the corner points mentioned in lines 3, 4 and 5 above were in conformance with the rules of the Michigan Board of Land Surveyors or by a Decree of a Court of Law; established, re-established, monumented, re-monumented, recovered, found as expressed below:

NOTE: Not more than 4 corners, all in the same town and range, may be recorded on this certificate.

A. Description of original monument and accessories and/or subsequent restoration:

Table with columns: I-13, 1831, G.L.O. Notes, Mullett, Set Post, N/A, Witness Map, K.C. Surveyor, Iron, 1968, Notes, Williams & Works, 'T' Iron, 1984, L.C.R.C. #3961, Exxel Engineering, Fnd. 'T' Iron / Set K.C. Monument, 1989, L.C.R.C. #5262, J. Bueche, K.C. Monument

Note: This corner is not common with I-1, T7N, R10W.

This corner was originally approved by the Kent County Remonumentation Peer Group and monumented by Exxel Engineering on 9/7/84 and was recorded per L.C.R.C. #3961.

B. Description of corner evidence found and/or method applied in restoring or reestablishing corner:

I-13 Found a Standard Kent County Monument 200' +/- East of the C/L of Honey Creek Avenue (bit.) running North and South and 2' North of the C/L of 4 Mile Road (bit.) running East per L.C.R.C.'s #3961 and #5262 as set by Exxel Engineering in place of a 'T' iron they found which checked the 1968 notes of Williams & Works and the K.C. Surveyor's records.

L.C.R.C. #3961

L.C.R.C. #5262

- Nail & remon tag in SW sde 16" Walnut N50°W 69.66'
Nail & remon tag in W'ly sde 10" Hickory N18°W 78.88'
Nail & remon tag in S sde 18" W. Cherry N85°E 185.18'
NW cor (wood) house S20°W 112.84'
NW cor Section 2, T7N, R10W (C.I. Monument) West 199.75'

- Nail & remon. tag in SW side 18" Walnut N 50° W 69.66'
Nail & remon tag in W'ly side 12" Hickory N 18° W 73.88'
Nail & remon tag in S side 20" W. Cherry N 85° E 184.90' (m. 184.97')
NW cor (wood) house S 20° W 112.84'
NW cor Section 2, T7N, R10W, K.C. Mon. West 199.75'
Nail & remon tag in E side power pole N 00° E 30.75'

The selected location is accepted by me and is generally accepted by professional surveyors as the best available evidence of the position of the original corner.

C. Description of monument for corner and accessories established to perpetuate locating the position of the corner:

I-13 Standard Kent County Monument

- Nail & K.C. remon. tag on SW side 18" Walnut N 50° W 69.66'
Nail & K.C. remon. tag on W'ly side 12" Hickory N 18° W 73.88'
Nail & K.C. remon. tag on S side 20" W. Cherry N 85° E 184.97'
Nail & K.C. remon. tag on E side P. pole N 00° E 30.75'
K.C. Mon., I-1, T7N, R10W, West 199.75'

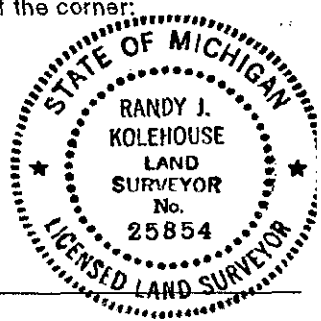

Signed by Randy J. Kolehouse

Date 8/12/97

Surveyor's Michigan License No. 25854