

MAR 03 1998

**SECTION**

**LAND CORNER RECORDATION CERTIFICATE**  
**Filing Requirement of Act 74, Mich. P.A. 1970**  
**KENT COUNTY REMONUMENTATION**

For corners in

Kent (County)	Located in: Cannon Township	Corner Code #
1. Public Land Survey	T <u>8N</u> R <u>10W</u>	<u>J-5</u>
	T _____ R _____	_____
	T _____ R _____	_____
	T _____ R _____	_____
2. Property Controlling in Section	S _____ T _____ R _____	_____
	S _____ T _____ R _____	_____
3. Miscellaneous Property in Sec.	S _____ T _____ R _____	_____
	S _____ T _____ R _____	_____

STATE OF MICHIGAN  
 COUNTY OF KENT  
 RECEIVED FOR RECORD  
 97 OCT 15 AM 8:47  
 REG. OF DEEDS  
*Lucy Bond*

**10137**

Register of Deeds Stamp & File Number

4. Lot No. \_\_\_\_\_, Recorded Plat \_\_\_\_\_  
 5. Private Claims \_\_\_\_\_

I, Randy Kolehouse, in a field survey on June 26 19 97, do hereby certify that under requirements of P.A. 74 Michigan P.A. of 1970, the corner points mentioned in lines 1 and 2 above were in conformance with regulations and rules therefore as required in the current manual of survey instructions of the United States Department of the interior, Bureau of Land Management or by a decree of a Court of Law and/or that the corner points mentioned in lines 3, 4 and 5 above were in conformance with the rules of the Michigan Board of Land Surveyors or by a Decree of a Court of Law; established, re-established, monumented, re-monumented, recovered, found as expressed below:

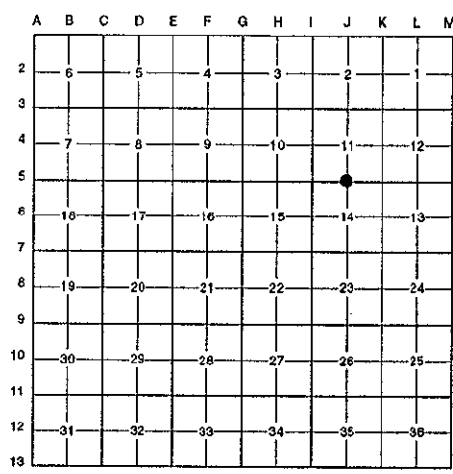

**NOTE: Not more than 4 corners, all in the same town and range, may be recorded on this certificate.**

**A. Description of original monument and accessories and/or subsequent restoration:**

J-5	1831	G.L.O. Notes	Mullett	Set Post
	1938-63	Witness Map	K.C. Surveyor	3/4" Pipe
	1985	L.C.R.C. #4141	C. Hay	P.K. and Washer
	1987	L.C.R.C. #4484	All-Points Surveyors	Fnd. P.K. & Tag / Set K.C. Monument
	1989	L.C.R.C. #5264	J. Bueche	K.C. Monument

This corner was originally approved by the Kent County Remonumentation Peer Group and monumented by All-Points Surveyors in January 1987 and was recorded per L.C.R.C. #4484.

**B. Description of corner evidence found and/or method applied in restoring or reestablishing corner:**

J-5 Found a Standard Kent County Monument on the C/L of Kitson and 20' ± East of Tulare Road (bit.) per L.C.R.C.'s #4484 and #5264 as set by All-Points Surveyors in place of P.K. and tag they found which checked L.C.R.C. #4141 and the K.C. Surveyor's records.

**L.C.R.C. #4484**

- Nail & K.C. Remon Tag W. side 22" Elm S10°E 13.45'
- Nail & K.C. Remon Tag S. side T. Pole N55°W 48.77'
- Nail & K.C. Remon Tag S. side T. Pole N90°E 73.03'
- 3/4" iron N. 5.1'
- 1/2" iron W. 60.0'

**L.C.R.C. #5264**

- Nail & K.C. Remon. Tag W side 22" Elm S 10° E 13.45'
- Nail & K.C. Remon. Tag S side t. pole N 55° W 48.77'
- Nail & K.C. Remon. Tag S side t. pole N 90° E 73.03'
- SE cor. garg. #6806 N 60° E 42.85'

The selected location is accepted by me and is generally accepted by professional surveyors as the best available evidence of the position of the original corner.

**C. Description of monument for corner and accessories established to perpetuate locating the position of the corner:**

J-5 Standard Kent County Monument  
 Nail & K.C. remon. tag on W side 22" Elm S 10° E 13.45'  
 Nail & K.C. remon. tag on S side T. pole N 55° W 48.77'  
 Nail & K.C. remon. tag on S side T. pole N 90° E 73.03'  
 SE cor. garage #6806 N 60° E 42.85'

P.A. 345 1990 KENT COUNTY

PEER APPROVED 8/24/97

CHAIRMAN [Signature]

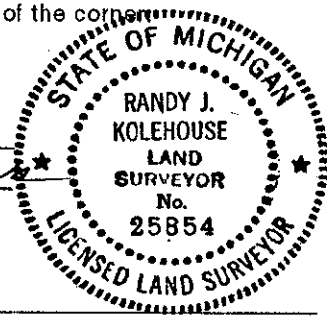

Signed by Randy J. Kolehouse  
 EARTH TECH

Date 8/12/97

Surveyor's Michigan License No. 25854