

# SURVEY & REMONUMENTATION

MAR 03 1998

## LAND CORNER RECORDATION CERTIFICATE Filing Requirement of Act 74, Mich. P.A. 1970 KENT COUNTY REMONUMENTATION

For corners in SECTION  
Kent  
(County)

	Located in: Cannon Township	Corner Code #	
1. Public Land Survey	T <u>8N</u> R <u>10W</u>	<u>M-1</u>	
	T _____ R _____	_____	
	T _____ R _____	_____	
	T _____ R _____	_____	
2. Property Controlling in Section	S _____ T _____ R _____	_____	
	S _____ T _____ R _____	_____	
3. Miscellaneous Property in Sec.	S _____ T _____ R _____	_____	
	S _____ T _____ R _____	_____	

STATE OF MICHIGAN  
 COUNTY OF KENT  
 RECEIVED FOR RECORD  
 97 OCT 15 AM 8:48  
 REG. OF DEEDS  
*Lucy Standa*

10157

Register of Deeds Stamp & File Number

4. Lot No. \_\_\_\_\_, Recorded Plat \_\_\_\_\_  
 5. Private Claims \_\_\_\_\_

I, Randy Kolehouse, in a field survey on July 1 19 97, do hereby certify that under requirements of P.A. 74 Michigan P.A. of 1970, the corner points mentioned in lines 1 and 2 above were in conformance with regulations and rules therefore as required in the current manual of survey instructions of the United States Department of the Interior, Bureau of Land Management or by a decree of a Court of Law and/or that the corner points mentioned in lines 3, 4 and 5 above were in conformance with the rules of the Michigan Board of Land Surveyors or by a Decree of a Court of Law; established, re-established, monumented, re-monumented, recovered, found as expressed below:

**NOTE: Not more than 4 corners, all in the same town and range, may be recorded on this certificate.**

**A. Description of original monument and accessories and/or subsequent restoration:**

M-1	1831	G.L.O. Notes	Mullet	Set Post
	N/A	Witness Map	K.C. Surveyor	Iron
	1977	L.C.R.C. #1099	Glaza & Associates	1/2" Pinched Iron in Mon. Box
	1978	L.C.R.C. #1121	Williams & Works	"T" Iron in Mon. Box (A-1, T8N, R9W)
	1978	L.C.R.C. #1205	Nederveld & Jonker	"T" Iron in Mon. Box (A-13, T9N, R9W)
	1979	L.C.R.C. #1295	Exxel Engineering	"T" Iron in Mon. Box
	1980	L.C.R.C. #1729	Williams & Works	Fnd. "T" Iron in Mon. Box / Set K.C. Monument (A-13, T9N, R9W)

Note: This corner is common with A-1, T8N, R9W; A-13, T9N, R9W; and M-13, T9N, R10W.

This corner was originally approved by the Kent County Remonumentation Peer Group and monumented by Williams & Works on 12/23/80 and was recorded per L.C.R.C. #1729.

**B. Description of corner evidence found and/or method applied in restoring or reestablishing corner:**

M-1 Found a Standard Kent County Monument 2' North of the C/L intersection of Tiffany Avenue (gravel) running South and 10 Mile Road (bit.) running East and West per L.C.R.C. #1729 as set by Williams & Works in place of a "T" iron in the top of a 1-1/4" iron they found in a monument box which checked L.C.R.C.'s 1295, #1205, #1121, #1099 and the K.C. Surveyor's records.

L.C.R.C. #1729

- Nail & K.C. Remon. Tag in SW Side 26" Hickory S 62° E 86.62'
- Nail & K.C. Remon. Tag in West Side Power Pole S 40° W 204.26'
- Nail & K.C. Remon. Tag in South Side 12" Poplar S 85° E 193.37'
- Nail & K.C. Remon. Tag in East Side Power Pole N 20° E 42.20'

P.A. 345 1990 KENT COUNTY  
 PEER APPROVED 7/24/97  
 CHAIRMAN *Henry J. Huber*

The selected location is accepted by me and is generally accepted by professional surveyors as the best available evidence of the position of the original corner.

**C. Description of monument for corner and accessories established to perpetuate locating the position of the corner:**

M-1 Standard Kent County Monument

- Nail & K.C. remon. tag on SW side 26" Hickory S 62° E 86.62'
- Nail & K.C. remon. tag on W side P. pole S 40° W 204.26'
- Nail & K.C. remon. tag on S side 12" Poplar S 85° E 193.37'
- Nail & K.C. remon. tag on E side P. pole N 20° E 42.20'

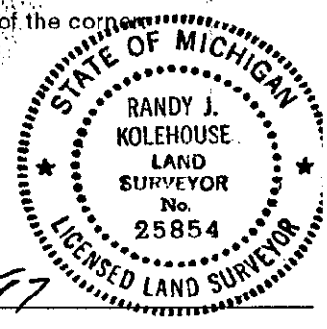

Signed by *Randy J. Kolehouse* Date 8/12/97  
 EARTH TECH  
 Surveyor's Michigan License No. 25854

