

**SURVEY & REMONUMENTATION**

FEB 14 1997

KENT COUNTY REMONUMENTATION

**COMMISSION LAND CORNER RECORDATION CERTIFICATE**  
Filing Requirement of Act 74, Mich. P.A. 1970

For corners in

KENT COUNTY

(County)

Located In:

Corner Code #

- |                                    |             |              |            |
|------------------------------------|-------------|--------------|------------|
| 1. Public Land Survey              | T <u>8N</u> | R <u>11W</u> | <u>B-1</u> |
|                                    | T _____     | R _____      | _____      |
|                                    | T _____     | R _____      | _____      |
|                                    | T _____     | R _____      | _____      |
| 2. Property Controlling in Section | S _____     | T _____      | R _____    |
|                                    | S _____     | T _____      | R _____    |
| 3. Miscellaneous Property in Sec.  | S _____     | T _____      | R _____    |
|                                    | S _____     | T _____      | R _____    |

4. Lot No. \_\_\_\_\_, Recorded Plat \_\_\_\_\_  
5. Private Claims \_\_\_\_\_

I, Kirk Breitels, in a field survey on Jan. 25, 1996 do hereby state that under requirements of P.A. 74, Michigan P.A. of 1970, the corner points mentioned in lines 1 and 2 above were in conformance with regulations and rules therefore as required in the current manual of survey instructions of the United States Department of the Interior, Bureau of Land Management or by a decree of a Court of Law and/or that the corner points mentioned in lines 3, 4 and 5 above were in conformance with the rules of the Michigan Board of Land Surveyors or by a Decree of a Court of Law; established, re-established, monumented, recovered, found as expressed below:

NOTE: Not more than 2 corners, all in the same town and range, may be recorded on this certificate.

STATE OF MICHIGAN  
COUNTY OF KENT  
RECEIVED FOR RECORD  
96 MAR 20 AM 8:51  
REG. OF DEEDS  
*[Signature]*  
**9026**  
Register of Deeds Stamp & File Number

A	B	C	D	E	F	G	H	I	J	K	L	M
1	●											
2	6	5	4	3	2	1						
3												
4	7	8	9	10	11	12						
5												
6	16	17	16	15	14	13						
7												
8	19	20	21	22	23	24						
9												
10	30	29	28	27	26	25						
11												
12	31	32	33	34	35	36						

A. Description of original monument and accessories and/or subsequent restoration:

B-1	1837 GLO	Whitcomb	Not Set
	1880-1972 Williams & Works		Stone-Iron-Mon. Box
	1972 LCRC #286	Vankooten	Iron in Mon. Box
	1984 LCRC #4031	Byl	Set Kent County Monument in Mon. Box
	1990 LCRC #5632	Marschall	Kent County Monument

P.A. 375 THE KENT COUNTY  
PEER APPROVED 3/7/96  
CHAIRMAN *[Signature]*

The position of this corner was previously approved by the Kent County Remonumentation Peer Group, monumented by William R. Byl on 11/7/84 and was recorded per LCRC #4031.

B. Description of corner evidence found and/or method applied in restoring or reestablishing corner:

B-1 Found standard Kent Co. Mon. (Harrison) per witnesses from above LCRC as set by William R. Byl on the Township line, in place of the 1" Iron Pipe he found inside a Mon. box. Said Iron checks with Williams & Works information and LCRC #286.

LCRC #4031 & #5632

Nail/tag 24" Oak	S70°W 161.37'	NW cor. hse. fnd.	S31°W 132.76'
Nail/tag 30" Maple	S60°W 75.68'	Iron C/L Krupp Ave. East	52.22'
Nail/tag 24" Maple	S00°W 71.10'	C/L bit. pavement E-W is N. 1'±	
NE cor. conc. pad	S10°E 82.73'	"X" on culv.	S70°E 86.88'
"X" on culv.	S35°E 36.82'		

The selected location is accepted by me and is generally accepted by professional surveyors as the best available evidence of the position of the corner.

C. Description of monument for corner and accessories established to perpetuate locating the position of the corner:

B-1 Standard Kent County Monument

New Nail & KC Remon. tag W. side 32" Maple	S04°W	71.08'
New Nail & KC Remon. tag SE side 44" Maple	S58°W	75.67'
New Nail & KC Remon. tag N. side 30" Oak	S67°W	161.40'
NW corner house foundation	S31°W	133.00'
"X" cut top W. end conc. culv.	S34°E	36.88'
"X" cut top E. end conc. culv.	S68°E	86.95'
Kent Co. Mon. (B-13, T9N, R11W)	West	400.46'

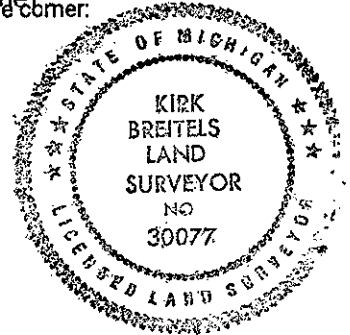

Signed by *[Signature]*  
Surveyor's Michigan License No. 30077

Date 3/1/96