

FEB 14 1997

KENT COUNTY REMONUMENTATION

COMMISSION LAND CORNER RECORDATION CERTIFICATE
Filing Requirement of Act 74, Mich. P.A. 1970

For corners in

KENT COUNTY

(County)

Located In:

Corner Code #

- | | | |
|------------------------------------|--------------------------|------------|
| 1. Public Land Survey | T <u>8N</u> R <u>11W</u> | <u>B-9</u> |
| | T _____ R _____ | _____ |
| | T _____ R _____ | _____ |
| | T _____ R _____ | _____ |
| 2. Property Controlling In Section | S _____ T _____ R _____ | _____ |
| | S _____ T _____ R _____ | _____ |
| 3. Miscellaneous Property in Sec. | S _____ T _____ R _____ | _____ |
| | S _____ T _____ R _____ | _____ |

REG. OF DEEDS

Eric Strand

96 MAR 20 AM 8:51

STATE OF MICHIGAN
COUNTY OF KENT
RECEIVED FOR RECORD

9030

Register of Deeds Stamp & File Number

4. Lot No. _____, Recorded Plat _____
5. Private Claims _____

I, Kirk Breitels, in a field survey on Jan. 18 19 96 do hereby state that under requirements of P.A. 74, Michigan P.A. of 1970, the corner points mentioned in lines 1 and 2 above were in conformance with regulations and rules therefore as required in the current manual of survey instructions of the United States Department of the Interior, Bureau of Land Management or by a decree of a Court of Law and/or that the corner points mentioned in lines 3, 4 and 5 above were in conformance with the rules of the Michigan Board of Land Surveyors or by a Decree of a Court of Law; established, re-established, monumented, recovered, found as expressed below:

NOTE: Not more than 2 corners, all in the same town and range, may be recorded on this certificate.

P.A. 345 1990 KENT COUNTY

PEER APPROVED 3/17/96

CHAIRMAN *[Signature]*

A	B	C	D	E	F	G	H	I	J	K	L	M
1												
2	6		5		4		3		2		1	
3												
4	7		8		9		10		11		12	
5												
6	18		17		16		15		14		13	
7												
8	19		20		21		22		23		24	
9												
10	30		29		28		27		26		25	
11												
12	31		32		33		34		35		36	
13												

A. Description of original monument and accessories and/or subsequent restoration:

- | | | | | | | |
|-----|------|---------------|------------|---|------|---------------|
| B-9 | 1837 | GLO | Whitcomb | Set Post | 1994 | LCRC #6896 |
| | 1959 | Kent Co. Wit. | | Boat Spike | Byl | Kent Co. Mon. |
| | 1972 | LCRC #332 | Spicer | Boat Spike | | |
| | 1979 | LCRC #1273 | Merdzinski | 1/2" Iron in Mon. Box | | |
| | 1981 | LCRC #2323 | Bueche | Set Kent County Monument in Mon. Box | | |
| | 1983 | LCRC #3203 | Milliron | Kent County Monument | | |
| | 1983 | LCRC #3498 | Brintnall | Reset Kent County Monument after const. | | |

The position of this corner was previously approved by the Kent County Remonumentation Peer Group, monumented by John C. Bueche on 10/31/81 and was recorded per LCRC #2323.

B. Description of corner evidence found and/or method applied in restoring or reestablishing corner:

B-9 Found standard Kent Co. Mon. (Harrison) per witnesses from above LCRC as set by Arthur W. Brintall in the same location as set in 1981 by John C. Bueche in place of the Iron he found inside a Mon. Box. Said Iron checks with LCRC's #332 & #1273.
LCRC #3498 & #6896

- | | | | |
|---------------------------------------|-------|---------|-------------------------|
| Centerline top of hydrant | N35°W | 42.25' | NE cor. CB at back curb |
| Nail & KC Remon. tag NW side Guy Pole | N40°E | 39.41' | S25°E 49.23' |
| NE cor. garage foundation | S45°W | 78.89' | NE cor. CB grate |
| Nail & KC Remon. tag NE side P. Pole | S45°E | 49.56' | N45°E 25.48' |
| PK on C/L 6 Mile Rd. | West | 100.00' | |

The selected location is accepted by me and is generally accepted by professional surveyors as the best available evidence of the position of the original corner.

C. Description of monument for corner and accessories established to perpetuate locating the position of the corner:

- | | | | |
|--|-------|--------|--|
| B-9 Standard Kent County Monument | | | |
| Centerline top of hydrant | N35°W | 42.32' | |
| Nail & KC Remon. tag NW side Guy Pole | N40°E | 39.46' | |
| NE cor. garage foundation | S45°W | 78.85' | |
| Nail & KC Remon. tag NE side Tel. Pole | S45°E | 49.65' | |
| NE cor. Catch Basin at back of curb | S25°E | 49.23' | |
| NE cor. Catch Basin grate | N45°E | 25.48' | |

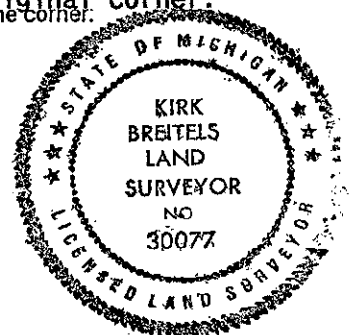

Signed by *[Signature]*

Date 2/6/96

Surveyor's Michigan License No. 30077