

**SURVEY & REMONUMENTATION**

**KENT COUNTY REMONUMENTATION**

FEB 14 1997

**LAND CORNER RECORDATION CERTIFICATE**  
Filing Requirement of Act 74, Mich. P.A. 1970

For corners in  
**KENT COUNTY**  
(County)

**COMMISSION**

Located in: Corner Code #

- |                                    |              |               |     |
|------------------------------------|--------------|---------------|-----|
| 1. Public Land Survey              | T <u>8</u> N | R <u>11</u> W | C-1 |
|                                    | T            | R             |     |
|                                    | T            | R             |     |
|                                    | T            | R             |     |
| 2. Property Controlling in Section | S            | T             | R   |
|                                    | S            | T             | R   |
| 3. Miscellaneous Property in Sec.  | S            | T             | R   |
|                                    | S            | T             | R   |

STATE OF MICHIGAN  
COUNTY OF KENT  
RECEIVED FOR RECORD  
96 MAR 20 AM 8:52  
REG. OF DEEDS  
*Lucy Stand*

**9031**

Register of Deeds Stamp & File Number

4. Lot No. \_\_\_\_\_, Recorded Plat \_\_\_\_\_  
5. Private Claims \_\_\_\_\_

I, Kirk Breiteis, in a field survey on Jan. 25, 1996 do hereby state that under requirements of P.A. 74, Michigan P.A. of 1970, the corner points mentioned in lines 1 and 2 above were in conformance with regulations and rules therefore as required in the current manual of survey instructions of the United States Department of the Interior, Bureau of Land Management or by a decree of a Court of Law and/or that the corner points mentioned in lines 3, 4 and 5 above were in conformance with the rules of the Michigan Board of Land Surveyors or by a Decree of a Court of Law; established, re-established, monumented, recovered, found as expressed below:

NOTE: Not more than 2 corners, all in the same town and range, may be recorded on this certificate.

P.A. 345 1990 KENT COUNTY  
PEER APPROVED 3/2/96  
CHAIRMAN *Harry Huber*

A	B	C	D	E	F	G	H	I	J	K	L	M
1												
2	6	5	4	3	2	1						
3												
4	7	8	9	10	11	12						
5												
6	18	17	16	15	14	13						
7												
8	19	20	21	22	23	24						
9												
10	30	29	28	27	26	25						
11												
12	31	32	33	34	35	36						
13												

A. Description of original monument and accessories and/or subsequent restoration:

- |     |      |               |           |  |
|-----|------|---------------|-----------|--|
| C-1 | 1837 | GLO           | Whitcomb  | Set Post                               |
|     | 1959 | Kent Co. Wit. |           | Mon. Box                               |
|     | 1982 | LCRC #3004    | Byl       | 3/4" Iron Pipe, 12.35' S. of Twp. line |
|     | 1983 | LCRC #3462    | Bonnema   | Set 1/2" Rebar & cap on Twp. Line      |
|     | 1984 | LCRC #4032    | Byl       | Set Kent County Monument               |
|     | 1990 | LCRC #5639    | Marschall | Kent County Monument                   |

The position of this corner was previously approved by the Kent County Remonumentation Peer Group, monumented by William R. Byl on 11/7/84 and was recorded per LCRC #4032.

B. Description of corner evidence found and/or method applied in restoring or reestablishing corner:

C-1 Found standard Kent Co. Mon. (Harrison) per wit. from above LCRC as set by William R. Byl on Twp. Line in place of the 1/2" Rebar (LCRC #3462) he found. Said Rebar checks with LCRC #3462. Found Iron per Kent Co. Wit. and LCRC #3004, 12.35 S. of Twp. Line.

<u>LCRC #4032</u>		<u>LCRC #5639</u>	
Nail/tag P. Pole	S00°W 46.30'	Nail/tag 14" Pine	N50°E 46.46' C-13 West
Nail/tag 15" Tw. Maple	S50°E 66.76'	Nail/tag 10" Pine	N35°W 37.87' 440.98'
Nail/tag 12" Pine	N50°E 46.53'	Nail/tag 16" Tw. Ash	S48°E 66.77'
Nail/tag 10" Pine	N35°W 37.96'	Nail/tag P. Pole	South 46.27'
NE cor. fnd. hse. #868	S30°W 89.26'	NE cor. hse. fnd.	S30°W 89.23'

The selected location is accepted by me and is generally accepted by professional surveyors as the best available evidence of the position of the original corner.

C. Description of monument for corner and accessories established to perpetuate locating the position of the corner:

- |  |       |         |
|--|-------|---------|
| C-1 Standard Kent County Monument            |       |         |
| New Nail & KC Remon. tag NW side 18" Pine    | N50°E | 46.49'  |
| Nail & KC Remon. tag S. side 12" Pine        | N35°W | 37.95'  |
| New Nail & KC Remon. tag NE side 20" Tw. Ash | S48°E | 66.85'  |
| Nail & KC Remon. tag E. side P. Pole         | S00°E | 46.27'  |
| NE corner house foundation (#868)            | S30°W | 89.23'  |
| Kent Co. Mon. (C-13, T9N, R11W)              | West  | 440.93' |

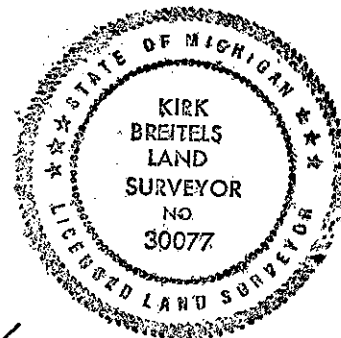

Signed by *Kirk Breiteis*  
Surveyor's Michigan License No. 30077

Date 3/1/96