

SURVEY & REMONUMENTATION

FEB 14 1997

COMMISSION

KENT COUNTY REMONUMENTATION

LAND CORNER RECORDATION CERTIFICATE
Filing Requirement of Act 74, Mich. P.A. 1970

For corners in

KENT COUNTY

(County)

Located In:

Corner Code #

1. Public Land Survey

T	8N	R	11W	C-10
T		R		
T		R		
T		R		
S		T	R	
S		T	R	
S		T	R	
S		T	R	

2. Property Controlling in Section

3. Miscellaneous Property in Sec.

4. Lot No. _____, Recorded Plat _____
5. Private Claims _____

STATE OF MICHIGAN
COUNTY OF KENT
RECEIVED FOR RECORD
96 MAR 20 AM 8:51
REG. OF DEEDS
Lucy Bond

9040

Register of Deeds Stamp & File Number

I, Kirk Breitels, in a field survey on Jan. 29, 1996 do hereby state that under requirements of P.A. 74, Michigan P.A. of 1970, the corner points mentioned in lines 1 and 2 above were in conformance with regulations and rules therefore as required in the current manual of survey instructions of the United States Department of the Interior, Bureau of Land Management or by a decree of a Court of Law and/or that the corner points mentioned in lines 3, 4 and 5 above were in conformance with the rules of the Michigan Board of Land Surveyors or by a Decree of a Court of Law, established, re-established, monumented, recovered, found as expressed below:

	A	B	C	D	E	F	G	H	I	J	K	L	M
1													
2	6		5		4		3		2		1		
3													
4	7		8		9		10		11		12		
5													
6	18		17		16		15		14		13		
7													
8	19		20		21		22		23		24		
9													
10	30		29		28		27		26		25		
11													
12	31		32		33		34		35		36		

NOTE: Not more than 2 corners, all in the same town and range, may be recorded on this certificate.

P.A. 315 1920 KENT COUNTY
PEER APPROVED 3/7/96
CHAIRMAN *Harry Huber*

A. Description of original monument and accessories and/or subsequent restoration:

C-10	1837	GLO	Whitcomb	Set Post
	1990	LCRC #5694	Flanders	Set Capped Rerod
	1992	LCRC #6626	Bueche	Set Kent County Monument

The position of this corner was previously approved by the Kent County Remonumentation Peer Group, monumented by John C. Bueche on 11/30/92 and was recorded per LCRC #6626.

B. Description of corner evidence found and/or method applied in restoring or reestablishing corner:

C-10 Found standard Kent Co. Mon. (Harrison) per witnesses from above LCRC as set by John C. Bueche in place of the Capped Rerod he found. Said Capped Rerod checks with LCRC #5694.

LCRC #6626

Top C/L Hydrant	West	152.15'
SE cor. CB casting @ back curb	N05°W	111.31'
"X" cut in curb (N. side of street)	North	192.50'
"X" cut in curb (N. side of street)	N45°W	126.00'

Cor. is in Lot 15 of "West River Business Center"
The selected location is accepted by me and is generally accepted by professional surveyors as the best available evidence of the position of the original corner.

C. Description of monument for corner and accessories established to perpetuate locating the position of the corner:

C-10 Standard Kent County Monument	S90°W	152.10'	All Measured by EDM
Top C/L Hydrant	N05°W	111.21'	
SE cor. CB casting @ back curb	N00°E	192.43'	
"X" cut in curb (N. side of street)	S60°W	187.60'	
C/L Manhole			

Cor. is in Lot 15 of "West River Business Center"

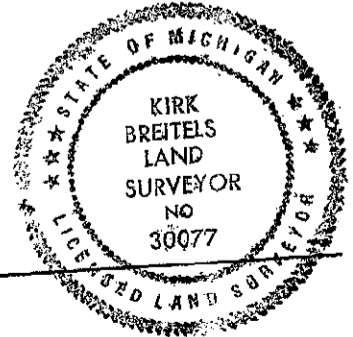

Signed by *Kirk Breitels*
Surveyor's Michigan License No. 30077

Date 2/6/96