

SURVEY & REMONUMENTATION

APR 28 1995

KENT COUNTY REMONUMENTATION

COMMISSION

LAND CORNER RECORDATION CERTIFICATE
Filing Requirement of Act 74, Mich. P.A. 1970

STATE OF MICHIGAN
COUNTY OF KENT
RECEIVED FOR RECORD

94 DEC 27 AM 9:04

For corners in
KENT COUNTY

	Located In:	Corner Code #
1. Public Land Survey	T <u>8N</u> R <u>11W</u>	<u>C-13</u>
	T _____ R <u>also</u>	_____
	T <u>7N</u> R <u>11W</u>	<u>C-1</u>
	T _____ R _____	_____
2. Property Controlling in Section	S _____ T _____ R _____	_____
	S _____ T _____ R _____	_____
3. Miscellaneous Property in Sec.	S _____ T _____ R _____	_____
	S _____ T _____ R _____	_____

W. R. Byl
REG. OF DEEDS

7897

Register of Deeds Stamp & File Number

4. Lot No. _____, Recorded Plat _____
5. Private Claims _____

	A	B	C	D	E	F	G	H	I	J	K	L	M
2	6	5	4	3	2	1							
3													
4	7	8	9	10	11	12							
5													
6	18	17	16	15	14	13							
7													
8	19	20	21	22	23	24							
9													
10	30	29	28	27	26	25							
11													
12	31	32	33	34	35	36							
13													

I, William R. Byl, in a field survey on Aug. 1, 19 94, do hereby certify that under requirements of P.A. 74, Michigan P.A. of 1970, the corner points mentioned in lines 1 and 2 above were in conformance with regulations and rules therefore as required in the current manual of survey instructions of the United States Department of the Interior, Bureau of Land Management or by a decree of a Court of Law and/or that the corner points mentioned in lines 3, 4 and 5 above were in conformance with the rules of the Michigan Board of Land Surveyors or by a Decree of a Court of Law; established, re-established, monumented, re-monumented, recovered, found as expressed below:

NOTE: Not more than 4 corners, all in the same town and range, may be recorded on this certificate.

A. Description of original monument and accessories and/or subsequent restoration:

Corner Code	Year	Material	Location	Description
C-13	1831	GLO	Mullett	Set Post
	1938	Kent Co. Wit.		3/4" Iron
	1980	LCRC #1415	Merdzinski	Set Nail from prev. survey information
	1982	LCRC #3176	Jonker	Set Kent County Monument
	1991	LCRC #5743	Bueche	Reset Kent County Monument
	1994	LCRC #6909	Byl	Kent County Monument

P.A. 345 1990 KENT COUNTY
PEER APPROVED 12/22/94
CHAIRMAN *Terry Kaper*

The position of this corner was previously approved by the Kent County Remonumentation Peer Group, monumented by Robert J. Jonker on 11/16/82 and was recorded per LCRC #3176

B. Description of corner evidence found and/or method applied in restoring or reestablishing corner:

C-13 Found standard Kent Co. Mon. (Harrison) per witnesses from above LCRC as set by John C. Bueche at the same position as set in 1982 by Robert J. Jonker in place of the Nail over a 3/4" x 23" Crimped Ironhe found. Said Nail & Iron check with Kent Co. Wit. and LCRC #1415.

LCRC #3176	LCRC #5743
Remon. tag P. Pole S65°E 56.60'	SE cor. hse. fnd. N45°W 105.98'
Remon. tag 10" Pine N35°E 75.37'	NE cor. hse. fnd. S25°W 64.50'
SE cor. hse. fnd. N45°W 105.98'	Top of NW cor. porch S40°W 69.55'
NE cor. hse. fnd. S25°W 64.50'	C/L Hydrant S05°E 51.69'
C/L MH East 36.00'	Nail & tag MBT Pole N70°E 58.60'

The selected location is accepted by me and is generally accepted by professional surveyors as the best available evidence of the position of the original corner.

C. Description of monument for corner and accessories established to perpetuate locating the position of the corner:

Monument Description	Direction	Distance
C-13 Standard Kent County Monument		
SE cor. hse. fnd.	N45°W	105.98'
NE cor. hse. fnd.	S25°W	64.53'
Top of NW cor. porch (2.8' above ground)	S40°W	69.70'
C/L hydrant	S05°E	51.73'
Nail & Remon. tag SE side MBT Pole	N70°E	58.60'
Nail & Remon. tag S. side P. Pole	S70°E	70.70'
On C/L E-W pvmnt.; C/L pvmnt. to N. is 12' W; C/L pvmnt. to S. is 17' E.		

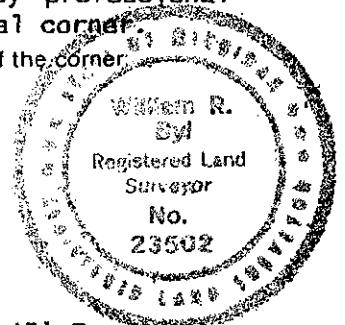

Signed by *W. R. Byl*
Surveyor's Michigan License No. 23502

Date 12/07/94