

SURVEY & REMONUMENTATION

FEB 14 1997

COMMISSION

KENT COUNTY REMONUMENTATION

LAND CORNER RECORDATION CERTIFICATE
Filing Requirement of Act 74, Mich. P.A. 1970

For corners in

KENT COUNTY

(County)

Located In:

Corner Code #

- | | | | |
|------------------------------------|-------|--------------------------|------------|
| 1. Public Land Survey | | T <u>8N</u> R <u>11W</u> | <u>E-1</u> |
| | | T ___ R ___ | _____ |
| | | T ___ R ___ | _____ |
| | | T ___ R ___ | _____ |
| 2. Property Controlling in Section | S ___ | T ___ R ___ | _____ |
| | S ___ | T ___ R ___ | _____ |
| 3. Miscellaneous Property in Sec. | S ___ | T ___ R ___ | _____ |
| | S ___ | T ___ R ___ | _____ |

REG. OF DEEDS
 STATE OF MICHIGAN
 COUNTY OF KENT
 RECEIVED FOR RECORD
 96 MAR 20 AM 8:55
Lucy Stand

9050

Register of Deeds Stamp & File Number

4. Lot No. _____, Recorded Plat _____
 5. Private Claims _____

I, Kirk Breitels, in a field survey on Jan. 25, 1996 do hereby state that under requirements of P.A. 74, Michigan P.A. of 1970, the corner points mentioned in lines 1 and 2 above were in conformance with regulations and rules therefore as required in the current manual of survey instructions of the United States Department of the Interior, Bureau of Land Management or by a decree of a Court of Law and/or that the corner points mentioned in lines 3, 4 and 5 above were in conformance with the rules of the Michigan Board of Land Surveyors or by a Decree of a Court of Law; established, re-established, monumented, recovered, found as expressed below:

NOTE: Not more than 2 corners, all in the same town and range, may be recorded on this certificate.

1	A	B	C	D	E	F	G	H	I	J	K	L	M
2		6		5		4		3		2		1	
3													
4		7		8		9		10		11		12	
5													
6		18		17		16		15		14		13	
7													
8		19		20		21		22		23		24	
9													
10		30		29		28		27		26		25	
11													
12		31		32		33		34		35		36	
13													

A. Description of original monument and accessories and/or subsequent restoration:

- | | | | | |
|-----|-----------|------------------|-----------|--------------------------------------|
| E-1 | 1837 | GLO | Whitcomb | Set Post |
| | 1899-1968 | Williams & Works | | Stone-Iron-Mon. Box |
| | 1959 | Kent Co. Wit. | | Mon. Box |
| | 1984 | LCRC #3798 | Hackbardt | Mon. Box |
| | 1984 | LCRC #4034 | Byl | Set Kent County Monument in Mon. Box |
| | 1990 | LCRC #5659 | Marschall | Kent County Monument |

P.A. 345 1990 KENT COUNTY

PEER APPROVED 3/7/96

CHAIRMAN *Harry Huber*

The position of this corner was previously approved by the Kent County Remonumentation Peer Group, monumented by William R. Byl on 11/27/84 and was recorded per LCRC #4034.

B. Description of corner evidence found and/or method applied in restoring or reestablishing corner:

E-1 Found standard Kent Co. Mon. (Harrison) per witnesses from above LCRC as set by William R. Byl on Twp. Line in place of the 1" Iron Pipe he found inside a Mon. Box. Said Iron Pipe checks with Williams & Works, Kent Co. Wit. and LCRC #3798.

- | | | |
|---------------------|---------------|----------------------------------|
| <u>LCRC #4034</u> | | <u>LCRC #5659</u> |
| Nail/tag 18" Maple | N20°E 112.03' | "X" cut top culv. S60°E 42.04' |
| Nail/tag P. Pole | N70°W 177.90' | "X" cut top culv. S34°W 27.20' |
| SE cor. dr. turnout | N10°W 72.08' | NE cor. gar. siding South 80.64' |
| NE cor. gar. siding | S00°W 80.66' | Nail/tag 28" Maple N21°E 112.05' |
| NW cor. hse. fnd. | S45°W 101.25' | Nail/tag P. Pole N05°W 177.91' |

The selected location is accepted by me and is generally accepted by professional surveyors as the best available evidence of the position of the original corner.

C. Description of monument for corner and accessories established to perpetuate locating the position of the corner:

- | | | |
|--|--|---------------|
| E-1 Standard Kent County Monument | | |
| "X" cut top W. end 12" conc. culv. | | S60°E 42.04' |
| "X" cut top W. end 12" conc. culv. | | S34°W 27.20' |
| NE corner garage siding Hse. #1656 | | S00°W 80.64' |
| New Nail & KC Remon. tag W. side 32" Maple | | N21°E 111.55' |
| Nail & KC Remon. tag S. side P. Pole | | N72°W 177.91' |
| NE cor. conc. drive turnout | | N05°W 96.99' |
| Kent Co. Mon. (E-13, T9N, R11W) | | West 407.23' |

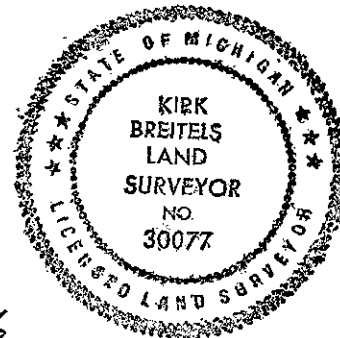

Signed by *Kirk Breitels*
 Surveyor's Michigan License No. 30077

Date 3/1/96