

**SURVEY & REMONUMENTATION**

FEB 14 1997

**KENT COUNTY REMONUMENTATION**

**LAND CORNER RECORDATION CERTIFICATE**  
Filing Requirement of Act 74, Mich. P.A. 1970

COMMUNITY

For corners in

**KENT COUNTY**

(County)

Located In:

Corner Code #

- |                                    |                          |            |
|------------------------------------|--------------------------|------------|
| 1. Public Land Survey              | T <u>8N</u> R <u>11W</u> | <u>G-2</u> |
|                                    | T _____ R _____          | _____      |
|                                    | T _____ R _____          | _____      |
|                                    | T _____ R _____          | _____      |
| 2. Property Controlling in Section | S _____ T _____ R _____  | _____      |
|                                    | S _____ T _____ R _____  | _____      |
| 3. Miscellaneous Property in Sec.  | S _____ T _____ R _____  | _____      |
|                                    | S _____ T _____ R _____  | _____      |

STATE OF MICHIGAN  
COUNTY OF KENT  
RECEIVED FOR RECORD

96 MAR 20 AM 8:57

REG. OF DEEDS

*Luci St. Grand*

**9065**

Register of Deeds Stamp & File Number

4. Lot No. \_\_\_\_\_, Recorded Plat \_\_\_\_\_
5. Private Claims \_\_\_\_\_

I, Kirk Breitels, in a field survey on Jan. 19, 1996 do hereby state that under requirements of P.A. 74, Michigan P.A. of 1970, the corner points mentioned in lines 1 and 2 above were in conformance with regulations and rules therefore as required in the current manual of survey instructions of the United States Department of the Interior, Bureau of Land Management or by a decree of a Court of Law and /or that the corner points mentioned in lines 3, 4 and 5 above were in conformance with the rules of the Michigan Board of Land Surveyors or by a Decree of a Court of Law; established, re-established, monumented, recovered, found as expressed below:

NOTE: Not more than 2 corners, all in the same town and range, may be recorded on this certificate.

P.A. 345 1990 KENT COUNTY

PEER APPROVED 3/7/96  
CHAIRMAN *[Signature]*

A	B	C	D	E	F	G	H	I	J	K	L	M
1												
2	6	5	4	3	2	1						
3												
4	7	8	9	10	11	12						
5												
6	18	17	16	15	14	13						
7												
8	19	20	21	22	23	24						
9												
10	30	29	28	27	26	25						
11												
12	31	32	33	34	35	36						
13												

A. Description of original monument and accessories and/or subsequent restoration:

G-2	1837	GLO	Whitcomb	Set Post
	1964	Kent Co. Wit.		1/2" Iron in rock pile
	1971	LCRC #92	Chambers	1/2" Iron
	1981	LCRC #2274	Bueche	Set Kent County Monument
	1994	LCRC #6933	Byl	Kent County Monument

The position of this corner was previously approved by the Kent County Remonumentation Peer Group, monumented by John C. Bueche on 10/10/81 and was recorded per LCRC #2274.

B. Description of corner evidence found and/or method applied in restoring or reestablishing corner:

G-2 Found standard Kent Co. Mon. (Harrison) per witnesses from above LCRC as set by John C. Bueche in place of the 1/2" x 18" Iron he found in a rock pile. Said Iron checks with Kent Co. Wit. and LCRC #92.

LCRC #2274 & #6933

Nail & MSDH tag W. side	24" Hickory	S10°W	5.28'
Nail & MSDH tag W. side	C.P. Pole	N00°E	42.25'
Nail & KC Remon. tag S. side	4" Hickory	N40°W	14.77'
Nail & KC Remon. tag N. side	8" Sassafras	S60°E	17.04'
Nail & KC Remon. tag N. side	8" Oak	S70°W	30.91'

The selected location is accepted by me and is generally accepted by professional surveyors as the best available evidence of the position of the original corner.

C. Description of monument for corner and accessories established to perpetuate locating the position of the corner:

G-2	Standard Kent County Monument		
	Nail & KC Remon. tag W. side	24" Hickory	S10°W 5.25'
	Nail & MSDH tag W. side	C.P. Pole	N00°E 42.25'
	Nail & KC Remon. tag N. side	12" Sassafras	S60°E 17.11'
	New Nail & KC Remon. tag N. side	10" Oak	S70°W 30.84'
	On N-S fence	5'± North of fence East	

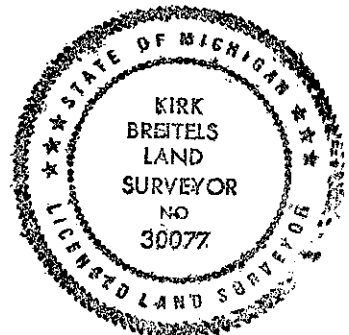

Signed by *Kirk Breitels*  
Surveyor's Michigan License No. 30077

Date 2/6/96