

FEB 14 1997

COMMISSION

KENT COUNTY REMONUMENTATION

LAND CORNER RECORDATION CERTIFICATE  
Filing Requirement of Act 74, Mich. P.A. 1970

For corners in

KENT COUNTY

(County)

Located In:

Corner Code #

1. Public Land Survey

T 8N R 11W

G-5

T R

T R

T R

2. Property Controlling in Section

S T R

S T R

3. Miscellaneous Property in Sec.

S T R

S T R

4. Lot No. \_\_\_\_\_, Recorded Plat \_\_\_\_\_  
5. Private Claims \_\_\_\_\_

REG. OF DEEDS

96 MAR 20 AM 8:57

STATE OF MICHIGAN  
COUNTY OF KENT  
RECEIVED FOR RECORD

9068

Register of Deeds Stamp & File Number

I, Kirk Breitels, in a field survey on Jan. 19 19 96 do hereby state that under requirements of P.A. 74, Michigan P.A. of 1970, the corner points mentioned in lines 1 and 2 above were in conformance with regulations and rules therefore as required in the current manual of survey instructions of the United States Department of the Interior, Bureau of Land Management or by a decree of a Court of Law and/or that the corner points mentioned in lines 3, 4 and 5 above were in conformance with the rules of the Michigan Board of Land Surveyors or by a Decree of a Court of Law; established, re-established, monumented, recovered, found as expressed below:

NOTE: Not more than 2 corners, all in the same town and range, may be recorded on this certificate.

P.A. 345 1990 KENT COUNTY

PEER APPROVED 3/7/96

CHAIRMAN [Signature]

	A	B	C	D	E	F	G	H	I	J	K	L	M
1													
2	6		5		4		3		2		1		
3													
4	7		8		9		10		11		12		
5													
6	10		17		16		15		14		13		
7													
8	19		20		21		22		23		24		
9													
10	30		29		28		27		26		25		
11													
12	31		32		33		34		35		36		
13													

A. Description of original monument and accessories and/or subsequent restoration:

G-5	1837	GLO	Whitcomb	Set Post
		Kent Co. Wit.		Iron
1981		LCRC #2276	Bueche	Set Kent County Monument
1994		LCRC #6936	Byl	Kent County Monument

The position of this corner was previously approved by the Kent County Remonumentation Peer Group, monumented by John C. Bueche on 10/31/81 and was recorded per LCRC #2276.

B. Description of corner evidence found and/or method applied in restoring or reestablishing corner:

G-5 Found standard Kent Co. Mon. (Harrison) per witnesses from above LCRC as set by John C. Bueche in place of the 1 1/2" x 30" Iron he found. Said Iron checks with Kent Co. Wit.

LCRC #2276 & #6936

Nail & KC Remon.	tag W. side 12" Pine	S10°E	53.08'
Nail & KC Remon.	tag S. side 10" Elm	S90°W	10.20'
Nail & KC Remon.	tag SE side 8" Elm	S30°W	11.10'
Nail & KC Remon.	tag S. side 8" Pine	N85°E	16.20'
C/L blktp. drive	is N. 45'±	C/L Belmont Ave.	is E. 540'± (per plat)

The selected location is accepted by me and is generally accepted by professional surveyors as the best available evidence of the position of the original corner.

C. Description of monument for corner and accessories established to perpetuate locating the position of the corner:

G-5	Standard Kent County Monument			
	New Nail & KC Remon.	tag W. side 20" Pine	S10°E	53.15'
	Nail & KC Remon.	tag S. side 15" Elm	S90°W	10.14'
	Nail & KC Remon.	tag SE side 12" Elm	S30°W	10.97'
	Nail & KC Remon.	tag S. side 12" Pine	N85°E	16.35'
	C/L blktp. drive	is N. 45'±		
	C/L Belmont Ave.	is E. 540'± (per plat)		

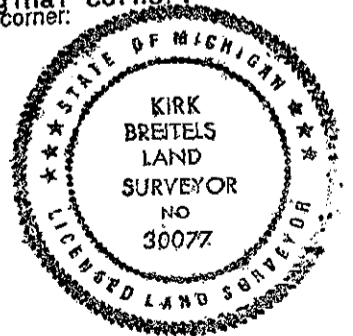

Signed by [Signature]  
Surveyor's Michigan License No. 30077

Date 2/6/96