

FEB 14 1997

KENT COUNTY REMONUMENTATION

COMMISSION

LAND CORNER RECORDATION CERTIFICATE
Filing Requirement of Act 74, Mich. P.A. 1970

For corners in

KENT COUNTY

(County)

Located In:

Corner Code #

- | | | |
|------------------------------------|--------------------------|------------|
| 1. Public Land Survey | T <u>8N</u> R <u>11W</u> | <u>I-4</u> |
| | T _____ R _____ | _____ |
| | T _____ R _____ | _____ |
| | T _____ R _____ | _____ |
| 2. Property Controlling in Section | S _____ T _____ R _____ | _____ |
| | S _____ T _____ R _____ | _____ |
| 3. Miscellaneous Property in Sec. | S _____ T _____ R _____ | _____ |
| | S _____ T _____ R _____ | _____ |

REG. OF DEEDS

Lucy Bond

96 MAR 20 AM 8:58

STATE OF MICHIGAN
COUNTY OF KENT
RECEIVED FOR RECORD

9086

Register of Deeds Stamp & File Number

4. Lot No. _____, Recorded Plat _____
5. Private Claims _____

I, Kirk Breitels, in a field survey on Jan. 29, 19 96 do hereby state that under requirements of P.A. 74, Michigan P.A. of 1970, the corner points mentioned in lines 1 and 2 above were in conformance with regulations and rules therefore as required in the current manual of survey instructions of the United States Department of the Interior, Bureau of Land Management or by a decree of a Court of Law and /or that the corner points mentioned in lines 3, 4 and 5 above were in conformance with the rules of the Michigan Board of Land Surveyors or by a Decree of a Court of Law; established, re-established, monumented, recovered, found as expressed below:

A	B	C	D	E	F	G	H	I	J	K	L	M
1												
2	6	5	4	3	2	1						
3												
4	7	8	9	10	11	12						
5												
6	18	17	16	15	14	13						
7												
8	19	20	21	22	23	24						
9												
10	30	29	28	27	26	25						
11												
12	31	32	33	34	35	36						

NOTE: Not more than 2 corners, all in the same town and range, may be recorded on this certificate.

P.A. 345 1990 KENT COUNTY

PEER APPROVED 3/7/96

CHAIRMAN Harry Ruben

A. Description of original monument and accessories and/or subsequent restoration:

I-4	1837	GLO	Whitcomb	Set Post
		Kent Co. Wit.		Iron
	1983	LCRC #3257	Hay	1" Pipe
	1983	LCRC #3530	Stadt	Set Kent County Monument
	1988	LCRC #4851	Bueche	Kent County Monument

The position of this corner was previously approved by the Kent County Remonumentation Peer Group, monumented by Russell E. Stadt on 9/7/83 and was recorded per LCRC #3530.

B. Description of corner evidence found and/or method applied in restoring or reestablishing corner:

I-4 Found standard Kent Co. Mon. (Harrison) per witnesses from above LCRC as set by Russell E. Stadt in place of the 1" Iron he found. Said Iron checks with Kent Co. Wit. and LCRC #3257.

LCRC #3530 & #4851

Nail & KC Remon. tag W. side 34" Oak	S05°W	31.09'
Nail & KC Remon. tag N. side 5" Maple	N75°E	13.09' (13.92' - #4851)
Nail & KC Remon. tag W. side 12" Oak	N05°E	45.28'
Nail & KC Remon. tag W. side 10" Oak	N30°W	17.07'
Nail & KC Remon. tag S. side 18" Oak	S70°W	13.03'

The selected location is accepted by me and is generally accepted by professional surveyors as the best available evidence of the position of the original corner.

C. Description of monument for corner and accessories established to perpetuate locating the position of the corner:

I-4 Standard Kent County Monument

Nail & KC Remon. tag W. side 36" Oak	S05°W	31.07'
New Nail & KC Remon. tag N. side 9" Maple	N75°E	13.92'
New Nail & KC Remon. tag W. side 16" Oak	N05°E	45.35'
New Nail & KC Remon. tag W. side 14" Oak	N30°W	16.99'
New Nail & KC Remon. tag S. side 22" Oak	S70°W	13.00'
Right bank of Rogue River (waters edge) - West		65'±

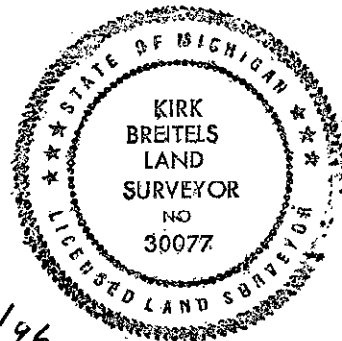

Signed by *Kirk Breitels*

Date 2/6/96

Surveyor's Michigan License No. 30077