

**SURVEY & REMONUMENTATION**

FEB 14 1997

**KENT COUNTY REMONUMENTATION**

**COMMISSION**

**LAND CORNER RECORDATION CERTIFICATE**  
Filing Requirement of Act 74, Mich. P.A. 1970

For corners in

KENT COUNTY

(County)

Located In:

Corner Code #

1. Public Land Survey	T <u>8</u> N R <u>11</u> W	J-3
	T ___ R ___	_____
	T ___ R ___	_____
	T ___ R ___	_____
2. Property Controlling in Section	S ___ T ___ R ___	_____
	S ___ T ___ R ___	_____
3. Miscellaneous Property in Sec.	S ___ T ___ R ___	_____
	S ___ T ___ R ___	_____

REG. OF DEEDS

*Handwritten signature*

96 JUN -7 AM 8:29

STATE OF MICHIGAN  
COUNTY OF KENT  
RECEIVED FOR RECORD

**9191**

Register of Deeds Stamp & File Number

4. Lot No. \_\_\_\_\_, Recorded Plat \_\_\_\_\_  
5. Private Claims \_\_\_\_\_

I, Kirk Breitels, in a field survey on Apr. 19, 1996 do hereby state that under requirements of P.A. 74, Michigan P.A. of 1970, the corner points mentioned in lines 1 and 2 above were in conformance with regulations and rules therefore as required in the current manual of survey instructions of the United States Department of the Interior, Bureau of Land Management or by a decree of a Court of Law and/or that the corner points mentioned in lines 3, 4 and 5 above were in conformance with the rules of the Michigan Board of Land Surveyors or by a Decree of a Court of Law; established, re-established, monumented, recovered, found as expressed below:

NOTE: Not more than 2 corners, all in the same town and range, may be recorded on this certificate.

A	B	C	D	E	F	G	H	I	J	K	L	M
1												
2	6	5	4	3	2	1						
3									●			
4	7	8	9	10	11	12						
5												
6	18	17	16	15	14	13						
7												
8	19	20	21	22	23	24						
9												
10	30	29	28	27	26	25						
11												
12	31	32	33	34	35	36						
13												

A. Description of original monument and accessories and/or subsequent restoration:

J-3	1837	GLO	Whitcomb	Set Post
	1879-1962	Williams & Works		Stake-Stone-Iron-Bolt Spike
	1983	LCRC #3551	Glaza	Bolt Spike
	1990	LCRC #5311	Bueche	Set Kent County Monument

The position of this corner was previously approved by the Kent County Remonumentation Peer Group, monumented by John C. Bueche on 6/2/89 and was recorded per LCRC #5311

B. Description of corner evidence found and/or method applied in restoring or reestablishing corner:

J-3 Found standard Kent Co. Mon. (Harrison) per witnesses from above LCRC as set by John C. Bueche in place of the Bolt Spike inside a 3/4" x 18" Iron he found. Said Bolt Spike & Iron check with Williams & Works information and LCRC #3551.

LCRC #5311

Nail & KC Remon. tag NE side Twin 28" Oak	S35°E	49.88'
Nail & KC Remon. tag NW side 10" Elm	N50°E	71.33'
Nail & KC Remon. tag NE side 20" Oak	N30°W	63.58'
Nail & KC Remon. tag S. side 30" Oak	West	49.93'
Nail & KC Remon. tag SW side 18" Oak	N55°W	97.32'

P.A. 345 1990 KENT COUNTY

PEER APPROVED 5/30/96  
CHAIRMAN Handwritten signature

The selected location is accepted by me and is generally accepted by professional surveyors as the best available evidence of the position of the original corner.

C. Description of monument for corner and accessories established to perpetuate locating the position of the corner:

J-3 Standard Kent County Monument

New Nail & KC Remon. tag NE side Twin 30" Oak	S35°E	49.80'
New Nail & KC Remon. tag NW side 15" Elm	N50°E	71.35'
New Nail & KC Remon. tag NE side 24" Oak	N30°W	63.58'
Nail & KC Remon. tag S. side 32" Oak	West	49.93'
New Nail & KC Remon. tag SW side 22" Oak	N55°W	97.36'
Set Nail & KC Remon. tag E. side Twin 14" Maple	S30°W	70.34'
Set Nail & KC Remon. tag S. side 12" Basswood	East	24.02'
On C/L N-S bit. road and tree row West		

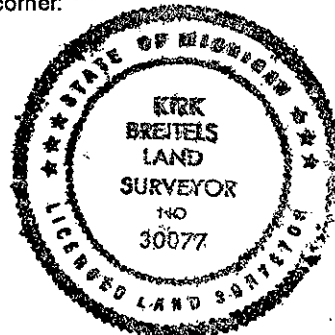

Signed by Kirk Breitels

Date 4/26/96

Surveyor's Michigan License No. 30077