

FEB 14 1997

COMMERCIAL

**KENT COUNTY REMONUMENTATION**

**LAND CORNER RECORDATION CERTIFICATE**  
Filing Requirement of Act 74, Mich. P.A. 1970

For corners in  
**KENT COUNTY**  
(County)

Located In:	Corner Code #
T 8N R 11W	K-10
T R	
T R	
T R	
T R	
S T R	
S T R	
S T R	
S T R	

1. Public Land Survey

2. Property Controlling in Section

3. Miscellaneous Property in Sec.

4. Lot No. \_\_\_\_\_, Recorded Plat \_\_\_\_\_  
5. Private Claims \_\_\_\_\_

I, Kirk Breitels, in a field survey on Jan. 29, 1996 do hereby state that under requirements of P.A. 74, Michigan P.A. of 1970, the corner points mentioned in lines 1 and 2 above were in conformance with regulations and rules therefore as required in the current manual of survey instructions of the United States Department of the Interior, Bureau of Land Management or by a decree of a Court of Law and/or that the corner points mentioned in lines 3, 4 and 5 above were in conformance with the rules of the Michigan Board of Land Surveyors or by a Decree of a Court of Law, established, re-established, monumented, recovered, found as expressed below:

NOTE: Not more than 2 corners, all in the same town and range, may be recorded on this certificate.

	A	B	C	D	E	F	G	H	I	J	K	L	M
1													
2	6		5		4		3		2		1		
3													
4	7		8		9		10		11		12		
5													
6	18		17		16		15		14		13		
7													
8	19		20		21		22		23		24		
9													
10	30		29		28		27		26		25		
11													
12	31		32		33		34		35		36		
13													

STATE OF MICHIGAN  
COUNTY OF KENT  
RECEIVED FOR RECORD  
96 MAR 20 AM 8:59  
REG. OF DEEDS  
*Lucy Spauld*

**9112**  
Register of Deeds Stamp & File Number

A. Description of original monument and accessories and/or subsequent restoration:

Date	Monument	Accessories	Restoration
K-10 1831	GLO	Mullett	Set Post
1945	Williams & Works		Iron
1951	Kent Co. Wit.		Iron
1984	LCRC #3753	Kolehouse	Set Kent County Monument
1988	LCRC #4872	Bueche	Kent County Monument

P.A. 345 1990 KENT COUNTY

PEER APPROVED 3/7/96  
CHAIRMAN *Randy J. Kolehouse*

The position of this corner was previously approved by the Kent County Remonumentation Peer Group, monumented by Randy J. Kolehouse on 2/25/84 and was recorded per LCRC #3753.

B. Description of corner evidence found and/or method applied in restoring or reestablishing corner:

K-10 Found standard Kent Co. Mon. (Harrison) per witnesses from above LCRC as set by Randy J. Kolehouse in place of the 1" Iron he found in a ring of stones. Said Iron checks with Williams & Works information and Kent Co. Wit.

Monument	Direction	Distance	Notes
Nail & KC Remon. tag	E. side	18" Twin Oak	North 69.00'
Nail & KC Remon. tag	S. side	12" Oak	East 2.05'
Nail & KC Remon. tag	S. side	25" Oak	S70°W 70.05'
Nail & KC Remon. tag	NW side	13" Oak	S45°W 17.78'
Nail & KC Remon. tag	W. side	12" Oak	S20°E 21.63'
Nail & KC Remon. tag	NE side	12" Oak	N45°W 25.63'

The selected location is accepted by me and is generally accepted by professional surveyors as the best available evidence of the position of the original corner.

C. Description of monument for corner and accessories established to perpetuate locating the position of the corner:

Monument	Direction	Distance
K-10 Standard Kent County Monument	N00°E	68.90'
New Nail & KC Remon. tag	S90°E	2.25'
New Nail & KC Remon. tag	S70°W	69.99'
New Nail & KC Remon. tag	S45°W	17.80'
New Nail & KC Remon. tag	S20°E	21.63'
New Nail & KC Remon. tag	N45°W	25.66'

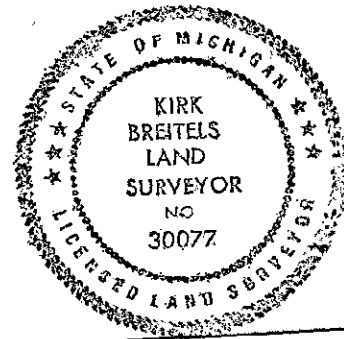

Signed by *Kirk Breitels*  
Surveyor's Michigan License No. 30077

Date 2/6/96