

**SURVEY & REMONUMENTATION**

**KENT COUNTY REMONUMENTATION**

FEB 14 1997

**LAND CORNER RECORDATION CERTIFICATE**  
Filing Requirement of Act 74, Mich. P.A. 1970

**COMMISSION**

For corners in

**KENT COUNTY**

(County)

Located In: #

Corner Code #

1. Public Land Survey	T 8N R 11W	L-3
	T R	
	T R	
	T R	
2. Property Controlling in Section	S T R	
	S T R	
3. Miscellaneous Property in Sec.	S T R	
	S T R	

STATE OF MICHIGAN  
COUNTY OF KENT  
RECEIVED FOR RECORD

96 MAR 20 AM 8:59

REG. OF DEEDS

*Lucy Hand*

**9116**

Register of Deeds Stamp & File Number

4. Lot No. \_\_\_\_\_, Recorded Plat \_\_\_\_\_  
5. Private Claims \_\_\_\_\_

A	B	C	D	E	F	G	H	I	J	K	L	M
1												
2	6	5	4	3	2	1						
3												
4	7	8	9	10	11	12						
5												
6	18	17	16	15	14	13						
7												
8	19	20	21	22	23	24						
9												
10	30	29	28	27	26	25						
11												
12	31	32	33	34	35	36						
13												

I, Kirk Breitels, in a field survey on Jan. 29 19 96 do hereby state that under requirements of P.A. 74, Michigan P.A. of 1970, the corner points mentioned in lines 1 and 2 above were in conformance with regulations and rules therefore as required in the current manual of survey instructions of the United States Department of the Interior, Bureau of Land Management or by a decree of a Court of Law and/or that the corner points mentioned in lines 3, 4 and 5 above were in conformance with the rules of the Michigan Board of Land Surveyors or by a Decree of a Court of Law; established, re-established, monumented, recovered, found as expressed below:

NOTE: Not more than 2 corners, all in the same town and range, may be recorded on this certificate.

P.A. 345 1990 KENT COUNTY

PEER APPROVED 3/7/96

CHAIRMAN Harry Hubert

A. Description of original monument and accessories and/or subsequent restoration:

L-3	1837	GL0	Whitcomb	Set Post
	1938	Kent Co. Wit.		Concrete Monument
	1979	LCRC #1252	Merdzinski	Concrete Monument
	1979	LCRC #1288	Hackbardt	Concrete Monument
	1981	LCRC #2281	Bueche	Set Kent County Monument
	1988	LCRC #4876	Bueche	Kent County Monument

The position of this corner was previously approved by the Kent County Remonumentation Peer Group, monumented by John C. Bueche on 10/10/81 and was recorded per LCRC #2281.

B. Description of corner evidence found and/or method applied in restoring or reestablishing corner:

L-3 Found standard Kent Co. Mon. (Harrison) per witnesses from above LCRC as set by John C. Bueche in place of the Concrete Monument he found. Said Concrete Monument checks with Kent Co. Wit. and LCRC's #1252 & #1288.

LCRC #2281 & #4876

Nail & KC Remon. tag W. side 24" Oak	N10°W	49.45'
Nail & KC Remon. tag W. side 26" Oak	S00°W	64.13'
Nail & KC Remon. tag NE side 18" Oak	N35°W	7.60'
Nail & KC Remon. tag S. side 24" Oak	N85°E	5.63'
Fence running West is West 33'±		

The selected location is accepted by me and is generally accepted by professional surveyors as the best available evidence of the position of the original corner.

C. Description of monument for corner and accessories established to perpetuate locating the position of the corner:

L-3 Standard Kent County Monument

New Nail & KC Remon. tag W. side 28" Oak	N10°W	49.33'
New Nail & KC Remon. tag W. side 30" Oak	S00°W	64.03'
New Nail & KC Remon. tag NE side 26" Oak	N35°W	7.72'
New Nail & KC Remon. tag S. side 28" Oak	N85°E	5.54'
Fence running West is West 33'±		
E-W foot path is North 30'±		

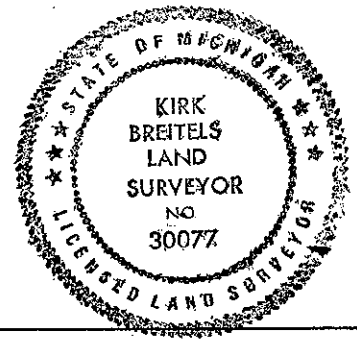

Signed by *Kirk Breitels*  
Surveyor's Michigan License No. 30077

Date 2/6/96