

FEB 14 1997

KENT COUNTY REMONUMENTATION

COMMISSION

LAND CORNER RECORDATION CERTIFICATE
Filing Requirement of Act 74, Mich. P.A. 1970

For corners in

KENT COUNTY

(County)

Located In:
#

Corner Code #

- 1. Public Land Survey

T 8N R 11W	<u>M-1</u>
T 8N R 10W	A 1
T 9N R 11W	M 13
T 9N R 10W	A 13
- 2. Property Controlling in Section

S	T	R	
S	T	R	
- 3. Miscellaneous Property in Sec.

S	T	R	
S	T	R	

- 4. Lot No. _____, Recorded Plat _____
- 5. Private Claims _____

REG. OF DEEDS

Lucy Bond

95 MAR 20 AM 8:59

STATE OF MICHIGAN
COUNTY OF KENT
RECEIVED FOR RECORD

9118

Register of Deeds Stamp & File Number

I, Kirk Breitels, in a field survey on Jan. 22, 1996 do hereby state that under requirements of P.A. 74, Michigan P.A. of 1970, the corner points mentioned in lines 1 and 2 above were in conformance with regulations and rules therefore as required in the current manual of survey instructions of the United States Department of the Interior, Bureau of Land Management or by a decree of a Court of Law and/or that the corner points mentioned in lines 3, 4 and 5 above were in conformance with the rules of the Michigan Board of Land Surveyors or by a Decree of a Court of Law, established, re-established, monumented, recovered, found as expressed below:

NOTE: Not more than 2 corners, all in the same town and range, may be recorded on this certificate.

P.A. 345 1990 KENT COUNTY
PEER APPROVED 3/7/96
CHAIRMAN Henry Huber

1	A	B	C	D	E	F	G	H	I	J	K	L	M
2		6		5		4		3		2		1	
3													
4		7		8		9		10		11		12	
5													
6		18		17		16		15		14		13	
7													
8		19		20		21		22		23		24	
9													
10		30		29		28		27		26		25	
11													
12		31		32		33		34		35		36	
13													

A. Description of original monument and accessories and/or subsequent restoration:

M-1	1837 GLO	Brookfield	Set Post
	1954 Kent Co. Wit.		Iron Bar
	1900-76 Williams & Works		Stone-Iron-Mon. Box
	1984 LCRC #3976	Byl	Set Kent County Monument in Mon. Box
	1994 LCRC #7070	Byl	Kent County Monument in Mon. Box.

The position of this corner was previously approved by the Kent County Remonumentation Peer Group, monumented by William R. Byl on 11/2/84 and was recorded per LCRC #3976.

B. Description of corner evidence found and/or method applied in restoring or reestablishing corner:

M-1 Found standard Kent Co. Mon. (Harrison) per witnesses from above LCRC as set by William R. Byl in place of the 1/2" Iron Pipe he found inside a Mon. Box. Said Iron Pipe checks with Kent Co. Wit. and Williams & Works information.

LCRC #3976 & #7070

NE cor. brick bldg. (4' above grade)	S30°W	96.32'	
NW cor. brick bldg. (3' above grade)	S20°E	55.86'	C/L Manhole N45°W 20.96'
NE cor. brick bldg. (3' above grade)	S45°E	69.38'	
"V" cut in face of conc. wall	N00°E	24.33'	
C/L Manhole	S80°W	25.76'	

The selected location is accepted by me and is generally accepted by professional surveyors as the best available evidence of the position of the original corner.

C. Description of monument for corner and accessories established to perpetuate locating the position of the corner:

M-1	Standard Kent County Monument in Mon. Box	
	NE cor. brick bldg. (4' above grade)	S30°W 96.32'
	NW cor. brick bldg. (3' above grade)	S20°E 55.86'
	NE cor. brick bldg. (3' above grade)	S45°E 69.38'
	"V" cut in face of conc. wall	N00°E 24.33'
	C/L Manhole	S80°W 25.76'
	C/L Manhole	N45°W 20.96'

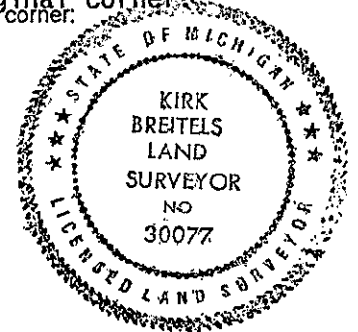

Signed by *Kirk Breitels*
Surveyor's Michigan License No. 30077

Date 2/6/96