

SURVEY & REMONUMENTATION KENT COUNTY REMONUMENTATION

FEB 14 1997

LAND CORNER RECORDATION CERTIFICATE
Filing Requirement of Act 74, Mich. P.A. 1970

For corners in KENT COUNTY, MICHIGAN
(County)

Located in: _____ Corner Code # _____

- | | | | | | |
|--------------------------------------|---|----|---|-----|-----|
| 1. Public Land Survey | T | 8N | R | 11W | M-4 |
| | T | 8N | R | 10W | A-4 |
| | T | | R | | |
| | T | | R | | |
| 2. Property Controlling in Section | S | | T | R | |
| | S | | T | R | |
| 3. Miscellaneous Property in Section | S | | T | R | |
| | S | | T | R | |
4. Lot No. _____, Recorded Plat _____
5. Private Claims _____

96 MAR 20 AM 8:55
STATE OF MICHIGAN
COUNTY OF KENT
RECEIVED FOR RECORD
REG. OF DEEDS
9121
Register of Deeds Stamp & File Number

I, Kirk Breitels, in a field survey on Jan. 22, 1996, do hereby certify that under requirements of P.A. 74, Michigan P.A. of 1970, the corner points mentioned in lines 1 and 2 above were in conformance with regulations and rules therefore as required in the current manual of survey instructions of the United States Department of the Interior, Bureau of Land Management or by a decree of a Court of Law and/or that the corner points mentioned in lines 3, 4 and 5 above were in conformance with the rules of the Michigan Board of Professional Surveyors or by a Decree of a Court of Law; established, re-established, monumented, re-monumented, recovered, found as expressed below:

A	B	C	D	E	F	G	H	I	J	K	L	M
2	6	5	4	3	2							
3												
4	7	8	9	10	11	12						
5												
6	18	17	16	15	14	13						
7												
8	19	20	21	22	23	24						
9												
10	30	29	28	27	26	25						
11												
12	31	32	33	34	35	36						
13												

NOTE: Not more than 4 corners, all in the same town and range, may be recorded on this certificate.

A. Description of original monument and accessories and/or subsequent restoration:

M-4	1831	GLO	Mullett	Set Post	P.A. 345 1990 KENT COUNTY
	1954	Kent Co. Wit.		Iron	PEER APPROVED 3/7/96
	1972	LCRC #355	Spicer	1" Solid Iron	CHAIRMAN <i>Harry Stube</i>
	1981	LCRC #1976	Jonker	Set Kent County Monument	
	1988	LCRC #4884	Bueche	Kent County Monument	
	1995	LCRC #8678	Breitels	Set Kent County Monument	

The position of this corner was previously approved by the Kent County Remonumentation Peer Group, monumented by Robert J. Jonker on 8/18/81 and was recorded per LCRC #1976.

B. Description of corner evidence found and/or method applied in restoring or reestablishing corner:

M-4 Found Standard Kent Co. Mon. per witnesses from above LCRC as set in 1995 by Kirk Breitels at the same location as set in 1981 by Robert J. Jonker in place of the 3/4" Iron he found. Said Iron checks with Kent Co. Wit. and LCRC #355 previous measurements. LCRC #1976 & 4884 LCRC #8678

Angle Pt. of cor. fc. post	N61°W	75.38'	Angle Pt. of cor. fc. post	N61°W	75.7'
Nail/tag W. side 12" Cherry	N01°E	124.72'	W. edge of conc. lane	East	99.24'
W. edge of conc. lane	East	99.20'	Nail/tag P. Pole	S10°W	96.98'
PK Nail on curb joint	N65°E	62.80'	Nail/tag Tw. 8" Cherry	N25°W	81.98'
PK Nail on curb joint	S06°E	54.64'	Nail/tag P. Pole	S65°E	80.96'
C/L "X" of bit. is 5' N. & 5' W ±			Nail/tag P. Pole	N60°E	80.98'
			SW cor. CB header	S75°W	63.57'

The selected location is accepted by me and is generally accepted by professional surveyors as the best available evidence of the position of the original corner.

C. Description of monument for corner and accessories established to perpetuate locating the position of the corner:

M-4 Standard Kent County Monument			
Angle Point of base of cor. fence post	N61°W	75.7'	(leaning)
W. edge of conc. to S. Bd. Wolverine Blvd.	East	99.24'	
Set Nail & KC Remon. tag W. side P. Pole	S10°E	96.98'	
Set Nail & KC Remon. tag NE side Tw. 8" Cherry	N25°W	81.98'	
Set Nail & KC Remon. tag N. side P. Pole	S65°E	80.96'	
Set Nail & KC Remon. tag N. side P. Pole	N60°E	80.98'	
SW corner CB header	S75°W	63.57'	

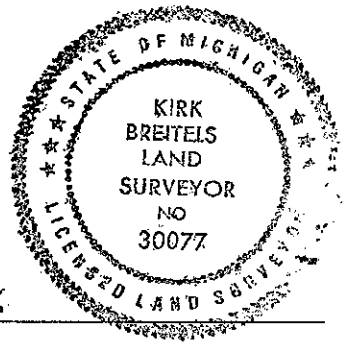

Signed by *Kirk Breitels*
Surveyor's Michigan License No. 30077

Date 2/6/96