

SEP 18 1995

KENT COUNTY REMONUMENTATION

LAND CORNER RECORDATION CERTIFICATE
Filing Requirement of Act 74, Mich. P.A. 1970

For corners in
KENT COUNTY

(County)

Located In:

Corner Code #

1. Public Land Survey	T	8N	R	12W	A-10
	T		R		
	T		R		
	T		R		
2. Property Controlling in Section	S		T	R	
	S		T	R	
3. Miscellaneous Property in Sec.	S		T	R	
	S		T	R	

REG. OF DEEDS

Lucy Bond

95 JUN 29 AM 11:51

STATE OF MICHIGAN
COUNTY OF KENT
RECEIVED FOR RECORD

8424

Register of Deeds Stamp & File Number

- 4. Lot No. _____, Recorded Plat _____
- 5. Private Claims _____

I, Kirk Breitels, in a field survey on March 8, 19 95, do hereby certify that under requirements of P.A. 74, Michigan P.A. of 1970, the corner points mentioned in lines 1 and 2 above were in conformance with regulations and rules therefore as required in the current manual of survey instructions of the United States Department of the Interior, Bureau of Land Management or by a decree of a Court of Law and/or that the corner points mentioned in lines 3, 4 and 5 above were in conformance with the rules of the Michigan Board of Land Surveyors or by a Decree of a Court of Law; established, re-established, monumented, re-monumented, recovered, found as expressed below:

NOTE: Not more than 4 corners, all in the same town and range, may be recorded on this certificate.

A	B	C	D	E	F	G	H	I	J	K	L	M
2	6	5	4	3	2	1						
3												
4	7	8	9	10	11	12						
5												
6	18	17	16	15	14	13						
7												
8	19	20	21	22	23	24						
9												
10	30	29	28	27	26	25						
11												
12	31	32	33	34	35	36						
13												

A. Description of original monument and accessories and/or subsequent restoration:

A-10	1837	GLO	Brookfield	Set Post
	1975	LCRC #813	Bonnema	"T" Iron-1/2" Iron
	1982	LCRC #3198	Bonnema	Found Ottawa Co. Monument

The position of this corner was previously approved by the Kent County Remonumentation Peer Group, recorded by Douglas W. Bonnema on 12/7/82 and was recorded per LCRC #3198.

B. Description of corner evidence found and/or method applied in restoring or reestablishing corner:

A-10 Found standard Ottawa Co. Mon. (Harrison) per witnesses from above LCRC as recorded by Douglas W. Bonnema. Said Ottawa Co. Monument checks LCRC #813.

LCRC #3198

Chiseled "X" top S. end conc. drive culv.	S22°E	52.63'
Chiseled "X" top S. end conc. drive culv.	N70°E	24.18'
Nail & KC Remon. tag N. side 24" Ash	West	34.48'
Nail & KC Remon. tag SW side 8" Oak	N55°W	41.16'
Nail & KC Remon. tag W. side dbl. 8" Poplar	N08°E	187.40'

P.A. 345 1990 KENT COUNTY

PEER APPROVED 6/22/95

CHAIRMAN *Harry Kubes*

The selected location is accepted by me and is generally accepted by professional surveyors as the best available evidence of the position of the original corner.

C. Description of monument for corner and accessories established to perpetuate locating the position of the corner:

A-10 Standard Ottawa County Monument

Chiseled "X" top S. end conc. drive culv.	S22°E	52.63'
Chiseled "X" top S. end conc. drive culv.	N70°E	24.18'
Nail & KC Remon. tag N. side 28" Ash	S90°W	34.74'
New Nail & KC Remon. tag W. side dbl. 16" Poplar	N08°E	187.31'
Set Nail & KC Remon. tag E. side 20" Poplar	N15°W	82.24'
C/L gravel road N-S is 3' West m/l		

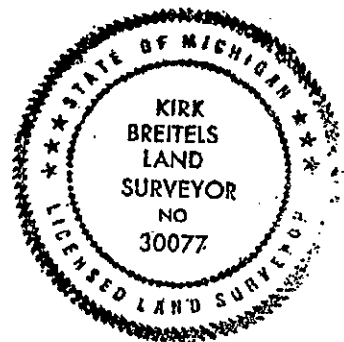

Signed by *Kirk Breitels*
Surveyor's Michigan License No. 30077

Date 6/22/95