

\$7.00
\$2.00

SEP 18 1995

COMMISSION

KENT COUNTY REMONUMENTATION

LAND CORNER RECORDATION CERTIFICATE

Filing Requirement of Act 74, Mich. P.A. 1970

For corners in
KENT COUNTY

(County)

Located In:

Corner Code ##

1. Public Land Survey	T	8N	R	12W	A-12
	T		R		
	T		R		
	T		R		
2. Property Controlling in Section	S		T	R	
	S		T	R	
3. Miscellaneous Property in Sec.	S		T	R	
	S		T	R	

- 4. Lot No. _____, Recorded Plat _____
- 5. Private Claims _____

STATE OF MICHIGAN
COUNTY OF KENT
RECEIVED FOR RECORD

95 JUN 29 AM 11:51

REG. OF DEEDS
Lucy Stand
8426

Register of Deeds Stamp & File Number

I, Kirk Breitels, in a field survey on April 3, 19 95, do hereby certify that under requirements of P.A. 74, Michigan P.A. of 1970, the corner points mentioned in lines 1 and 2 above were in conformance with regulations and rules therefore as required in the current manual of survey instructions of the United States Department of the Interior, Bureau of Land Management or by a decree of a Court of Law and/or that the corner points mentioned in lines 3, 4 and 5 above were in conformance with the rules of the Michigan Board of Land Surveyors or by a Decree of a Court of Law; established, re-established, monumented, re-monumented, recovered, found as expressed below:

A	B	C	D	E	F	G	H	I	J	K	L	M
2	6	5	4	3	2	1						
3												
4	7	8	9	10	11	12						
5												
6	18	17	16	15	14	13						
7												
8	19	20	21	22	23	24						
9												
10	30	29	28	27	26	25						
11												
12	31	32	33	34	35	36						
13												

NOTE: Not more than 4 corners, all in the same town and range, may be recorded on this certificate.

A. Description of original monument and accessories and/or subsequent restoration:

A-12 1837 GLO Brookfield Set Post
 1935 Kent Co. Wit. Buggy Axle
 1986 LCRC #4408 Bueche Set Kent County Monument

The position of this corner was previously approved by the Kent County Remonumentation Peer Group, monumented by John c. Bueche on 4/15/86 and was recorded per LCRC #4408

B. Description of corner evidence found and/or method applied in restoring or reestablishing corner:

A-12 Found standard Kent Co. Mon. (Harrison) per witnesses from above LCRC as set by John C. Bueche in place of the Buggy Axle he found. Said Buggy Axle checks with Kent Co. Wit.

LCRC #4408

KC Remon. tag & nail W. side 12" Elm N15°E 86.38'
 KC Remon. tag & nail E. side 10" Elm S55°W 39.62'
 KC Remon. tag & nail N. side 10" Elm S40°E 53.85'
 KC Remon. tag & nail S. side 8" Beech N90°E 43.65'

P.A. 3-3 1999 KENT COUNTY

PEER APPROVED 6/22/95
 CHAIRMAN Harry Fisher

The selected location is accepted by me and is generally accepted by professional surveyors as the best available evidence of the position of the original corner.

C. Description of monument for corner and accessories established to perpetuate locating the position of the corner:

A-12 Standard Kent County Monument

New KC Remon. tag & nail W. side 16" Elm N15°E 86.70'
 New KC Remon. tag & nail E. side 14" Elm S55°W 39.82'
 New KC Remon. tag & nail N. side 16" Elm S40°E 53.53'
 Set KC Remon. tag & nail S. side 24" Elm N70°E 78.59'

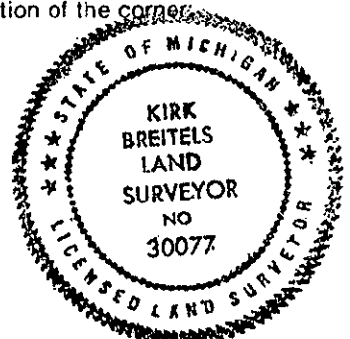

Signed by Kirk Breitels

Date 6/22/95

Surveyor's Michigan License No. 30077