

\$7.00  
\$2.00

SEP 18 1995

COMMISSION

KENT COUNTY REMONUMENTATION

LAND CORNER RECORDATION CERTIFICATE  
Filing Requirement of Act 74, Mich. P.A. 1970

For corners in  
KENT COUNTY

(County)	Located In:	Corner Code #
1. Public Land Survey	T <u>8N</u> R <u>12W</u>	<u>D-9</u>
	T _____ R _____	_____
	T _____ R _____	_____
	T _____ R _____	_____
2. Property Controlling in Section	S _____ T _____ R _____	_____
	S _____ T _____ R _____	_____
3. Miscellaneous Property in Sec.	S _____ T _____ R _____	_____
	S _____ T _____ R _____	_____

4. Lot No. \_\_\_\_\_, Recorded Plat \_\_\_\_\_  
 5. Private Claims \_\_\_\_\_

STATE OF MICHIGAN  
 COUNTY OF KENT  
 RECEIVED FOR RECORD  
 95 JUN 29 AM 11:52  
 REG. OF DEEDS  
*Lucinda Bond*  
 8441  
 Register of Deeds Stamp & File Number

I, Kirk Breitels, in a field survey on March 8, 19 95, do hereby certify that under requirements of P.A. 74, Michigan P.A. of 1970, the corner points mentioned in lines 1 and 2 above were in conformance with regulations and rules therefore as required in the current manual of survey instructions of the United States Department of the Interior, Bureau of Land Management or by a decree of a Court of Law and/or that the corner points mentioned in lines 3, 4 and 5 above were in conformance with the rules of the Michigan Board of Land Surveyors or by a Decree of a Court of Law; established, re-established, monumented, re-monumented, recovered, found as expressed below:

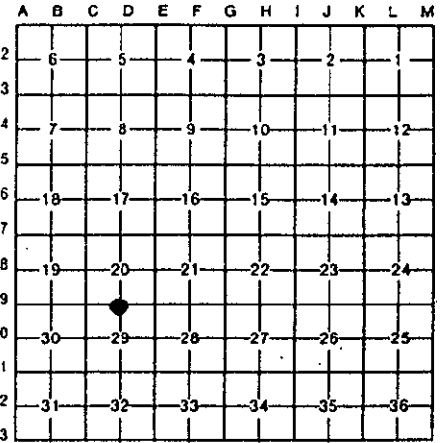

NOTE: Not more than 4 corners, all in the same town and range, may be recorded on this certificate.

A. Description of original monument and accessories and/or subsequent restoration:

D-9	1838	GLO	Whitcomb	Set Post
	1935-57	Kent Co. Wit.		Conc. Mon.
	1972	LCRC #454	VanKooten	1/2" Iron
	1981	LCRC #2401	Bueche	Set Kent County Monument
	1987	LCRC #4526	Bueche	Reset Kent County Monument

P.A. 345 1990 KENT COUNTY  
 PEER APPROVED 6/22/95  
 CHAIRMAN Garry Phares

The position of this corner was previously approved by the Kent County Remonumentation Peer Group, monumented by John C. Bueche on 12/1/81 and was recorded per LCRC #2401.

B. Description of corner evidence found and/or method applied in restoring or reestablishing corner:

D-9 Found standard Kent Co. Mon. (Harrison) per witnesses from above LCRC as set by John C. Bueche at the same position as set in 1981 by John C. Bueche in place of the 1/2" Iron in a Conc. Mon. he found. Said Iron & Conc. Mon. check with Kent Co. Wit. and LCRC #454.  
 LCRC #4526

KC Remon. tag & nail E. side P. Pole	S00°E	75.50'	PK nail in curb joint of
KC Remon. tag & nail S. side 8" Elm	N65°E	111.67'	conc. spillway S25°W 56.66'
KC Remon. tag & nail NW side P. Pole	S45°W	112.60'	
SW cor. brick house	N10°W	160.62'	C/L blktp. road E-W-S
SE cor. brick house	N25°E	170.71'	
KC Remon. tag & nail SW side 20" Apple	S50°E	129.98'	

The selected location is accepted by me and is generally accepted by professional surveyors as the best available evidence of the position of the original corner.

C. Description of monument for corner and accessories established to perpetuate locating the position of the corner:

D-9 Standard Kent County Monument

KC Remon. tag & nail E. side P. Pole	S00°E	75.50'
New KC Remon. tag & nail S. side 12" Elm	N65°E	111.81'
New KC Remon. tag & nail NW side P. Pole	S45°W	112.61'
SW cor. brick house	N10°W	160.64'
SE cor. brick house	N25°E	170.71'
new KC Remon. tag & nail SW side 24" Apple	S50°E	129.96'
PK nail curb joint of conc. spillway	S25°W	56.66'

C/L blktp. road E-W-S

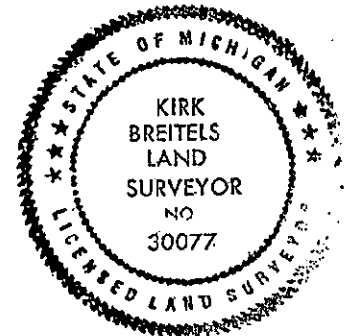

Signed by Kirk Breitels

Date 6/22/95

Surveyor's Michigan License No. 30077