

\$7.00
\$2.00

SEP 18 1995

KENT COUNTY REMONUMENTATION

COMMISSION

LAND CORNER RECORDATION CERTIFICATE

Filing Requirement of Act 74, Mich. P.A. 1970

For corners in
KENT COUNTY
(County)

Located In:

Corner Code #

- | | | | | | |
|--------------------------------------|---|-----------|---|------------|------------|
| 1. Public Land Survey | T | <u>8N</u> | R | <u>12W</u> | <u>E-1</u> |
| | T | | R | | |
| | T | | R | | |
| | T | | R | | |
| 2. Property Controlling in Section | S | | T | R | |
| | S | | T | R | |
| 3. Miscellaneous Property in Section | S | | T | R | |
| | S | | T | R | |

REG. OF DEEDS

8442

95 JUN 29 AM 11:52

STATE OF MICHIGAN
COUNTY OF KENT
RECEIVED FOR RECORD

Register of Deeds Stamp & File Number

4. Lot No. _____, Recorded Plat _____
5. Private Claims _____

A	B	C	D	E	F	G	H	I	J	K	L	M
2	6	5	4	3	2	1						
3												
4	7	8	9	10	11	12						
5												
6	18	17	16	15	14	13						
7												
8	19	20	21	22	23	24						
9												
10	30	29	28	27	26	25						
11												
12	31	32	33	34	35	36						
13												

I, Kirk Breitels, in a field survey on Feb. 15, 1995, do hereby certify that under requirements of P.A. 74, Michigan P.A. of 1970, the corner points mentioned in lines 1 and 2 above were in conformance with regulations and rules therefore as required in the current manual of survey instructions of the United States Department of the Interior, Bureau of Land Management or by a decree of a Court of Law and/or that the corner points mentioned in lines 3, 4 and 5 above were in conformance with the rules of the Michigan Board of Professional Surveyors or by a Decree of a Court of Law; established, re-established, monumented, re-monumented, recovered, found as expressed below:

NOTE: Not more than 4 corners, all in the same town and range, may be recorded on this certificate.

A. Description of original monument and accessories and/or subsequent restoration:

- | | | | | |
|-----|------|---------------|-----------|--------------------------------------|
| E-1 | 1838 | GLO | Whitcomb | Set Post |
| | 1951 | Kent Co. Wit. | | Mon. Box |
| | 1984 | LCRC #4085 | Kolehouse | Set Kent County Monument in mon. box |
| | 1991 | LCRC #6113 | By I | Kent County Monument in mon. box |

The position of this corner was previously approved by the Kent County Remonumentation Peer Group, monumented by Randy J. Kolehouse on 11/17/84 and was recorded per LCRC #4085

B. Description of corner evidence found and/or method applied in restoring or reestablishing corner:

E-1 Found standard Kent Co. Mon. (Harrison) per witnesses from above LCRC as set on the twp. 1 line by Randy J. Kolehouse in place of the 1" Iron he found inside a mon. box. Said Iron checks with Kent Co. Wit.

LCRC #6113 (LCRC #4085 - same witnesses)

- | | | |
|--|-------|---------|
| Nail & KC Remon. tag W. side T. Pole | S30°E | 69.40' |
| Nail & KC Remon. tag SW side P. Pole | N60°W | 62.16' |
| Nail & KC Remon. tag E. side 16" Maple | S30°W | 95.86' |
| Nail & KC Remon. tag NW side 26" Maple | S45°W | 60.10' |
| KC Mon., SE cor. Sec. 32, T9N, R12W | West | 220.51' |

P.A. 345 1990 KENT COUNTY

PEER APPROVED 6/22/95

CHAIRMAN Harry Tuben

The selected location is accepted by me and is generally accepted by professional surveyors as the best available evidence of the position of the original corner.

C. Description of monument for corner and accessories established to perpetuate locating the position of the corner:

- | | | |
|---|-------|---------|
| E-1 Standard Kent County Monument in mon. box | | |
| Nail & KC Remon. tag W. side T. Pole | S30°E | 69.40' |
| Nail & KC Remon. tag SW side P. Pole | N60°W | 62.16' |
| Nail & KC Remon. tag E. side 20" Maple | S30°W | 95.86' |
| Nail & KC Remon. tag NW side 30" Maple | S45°W | 60.10' |
| KC Mon., SE cor. Sec. 32, T9N, R12W | West | 220.47' |

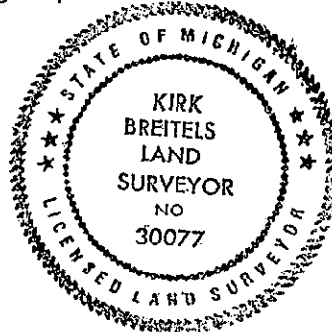

Signed by Kirk Breitels
Surveyor's Michigan License No. 30077

Date 6/22/95