

SURVEY & REMONUMENTATION

\$7.00
\$2.00
18 1995
COMMISSION

KENT COUNTY REMONUMENTATION

LAND CORNER RECORDATION CERTIFICATE
Filing Requirement of Act 74, Mich. P.A. 1970

For corners in KENT COUNTY (County) Located In: _____ Corner Code # _____

1. Public Land Survey	T	8N	R	12W	G-1
	T		R		
	T		R		
	T		R		
2. Property Controlling in Section	S		T		
	S		T		
3. Miscellaneous Property in Section	S		T		
	S		T		

STATE OF MICHIGAN
COUNTY OF KENT
RECEIVED FOR RECORD
95 JUN 29 AM 11:54
REG. OF DEEDS
8461
Register of Deeds Stamp & File Number

4. Lot No. _____, Recorded Plat _____
5. Private Claims _____

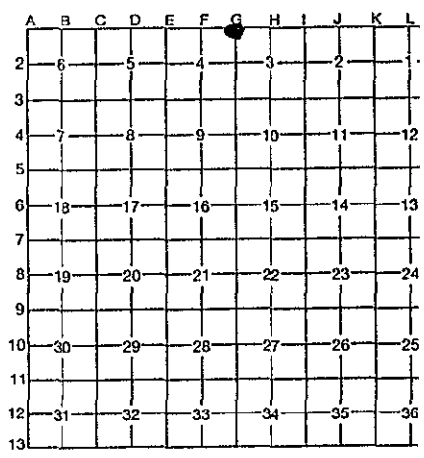

I, Kirk Breitels, in a field survey on March 1, 1995, do hereby certify that under requirements of P.A. 74, Michigan P.A. of 1970, the corner points mentioned in lines 1 and 2 above were in conformance with regulations and rules therefore as required in the current manual of survey instructions of the United States Department of the Interior, Bureau of Land Management or by a decree of a Court of Law and/or that the corner points mentioned in lines 3, 4 and 5 above were in conformance with the rules of the Michigan Board of Professional Surveyors or by a Decree of a Court of Law; established, re-established, monumented, re-monumented, recovered, found as expressed below:

NOTE: Not more than 4 corners, all in the same town and range, may be recorded on this certificate.

A. Description of original monument and accessories and/or subsequent restoration:

G-1	1838	GLO	Whitcomb	Set Post
	1967	Kent Co. Wit.		Conc. Mon. in mon. box
	1984	LCRC #4087	Kolehouse	Set Kent County Monument
	1991	LCRC #6115	Byl	Kent County Monument

The position of this corner was previously approved by the Kent County Remonumentation Peer Group, monumented by Randy J. Kolehouse on 11/16/84 and was recorded per LCRC #4087

B. Description of corner evidence found and/or method applied in restoring or reestablishing corner:

G-1 Found standard Kent Co. Mon. (Harrison) per witnesses from above LCRC as set by Randy J. Kolehouse on twp. line in place of the 3/4" Iron inside a mon. box he found. Said Iron in mon. box checks with Kent Co. Wit.

LCRC #6115 (includes remaining witnesses from LCRC #4087)
Nail & KC Remon. tag N. side P. Pole N70°W 172.09'
Nail & KC Remon. tag E. side P. Pole N30°E 57.91'
Chiseled "X" top W. end 12" culv. N80°E 101.31'
KC Mon. at SE cor. Sec. 33, T9N, R12W West 98.75'

P.A. 345 1990 KENT COUNTY
PEER APPROVED 6/22/99
CHAIRMAN Harry Huber

The selected location is accepted by me and is generally accepted by professional surveyors as the best available evidence of the position of the original corner.

C. Description of monument for corner and accessories established to perpetuate locating the position of the corner:

G-1 Standard Kent County Monument

Set Nail & KC Remon. tag N. side new P. Pole	N70°W	170.07'
Set Nail & KC Remon. tag E. side new P. Pole	N30°E	57.68'
Chiseled "X" top W. end 12" culv.	N80°E	101.31'
KC Mon. at SE cor. Sec. 33, T9N, R12W	West	98.65'

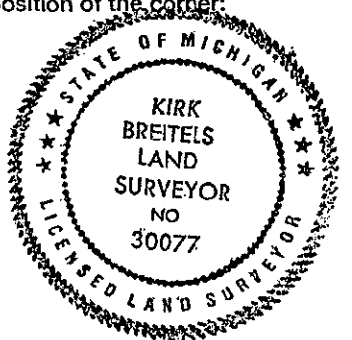

Signed by Kirk Breitels Date 6/22/95
Surveyor's Michigan License No. 30077